

# QUANTUM™



RENO RED **QHD-MAX**  
(RC25, LH26, & KW29)



TAHOE BLUE **QHD-MAX**  
(RC25, LH26, & KW29)



BLUE CHIP



CASINO ROYALE



MONTE CARLO  
FULL-BODY PAINT (KW29, JM31, LF31 & WS31)



KEY LARGO  
FULL-BODY PAINT (KW29, JM31, LF31 & WS31)

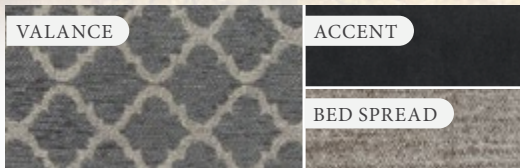

CLOUD NINE II

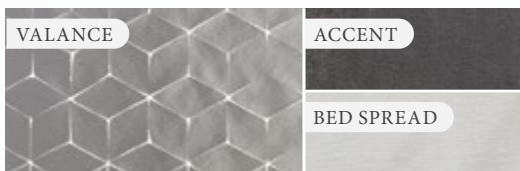

PEWTER FROST

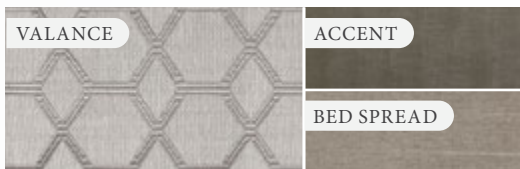

MIDTOWN TAUPE II

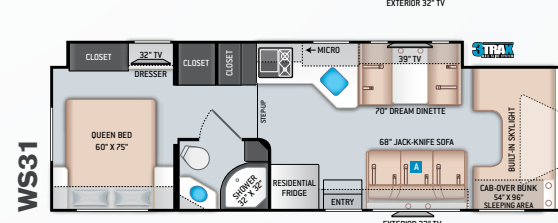
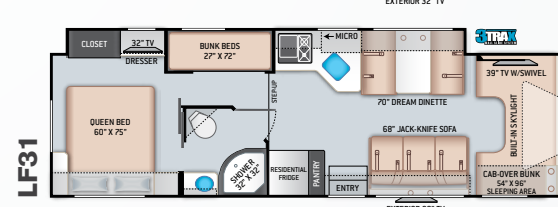
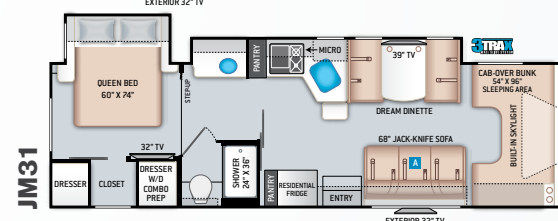
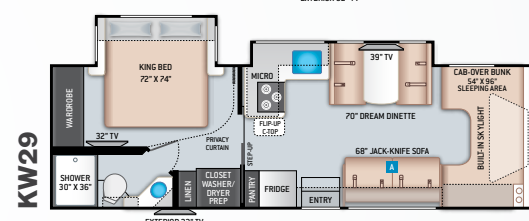
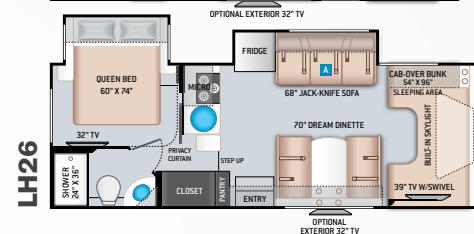
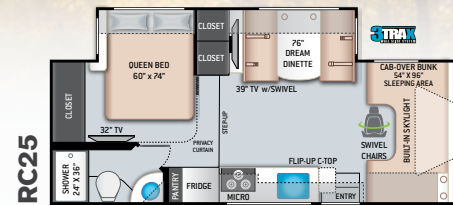
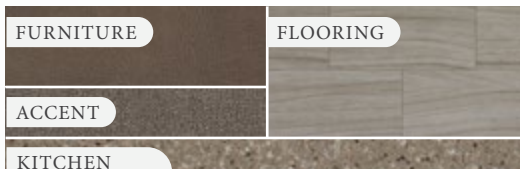

# QUANTUM™

## SPRINTER



RENO RED QHD-MAX



TAHOE BLUE QHD-MAX



KEY LARGO



MONTE CARLO



CLOUD NINE II



PEWTER FROST



MIDTOWN TAUPE II

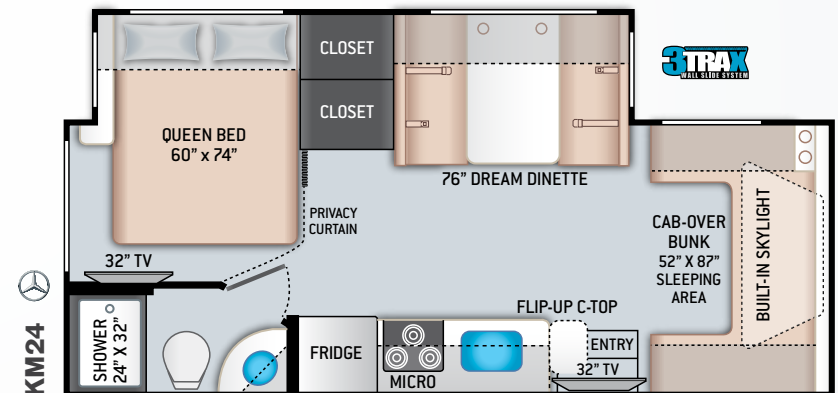
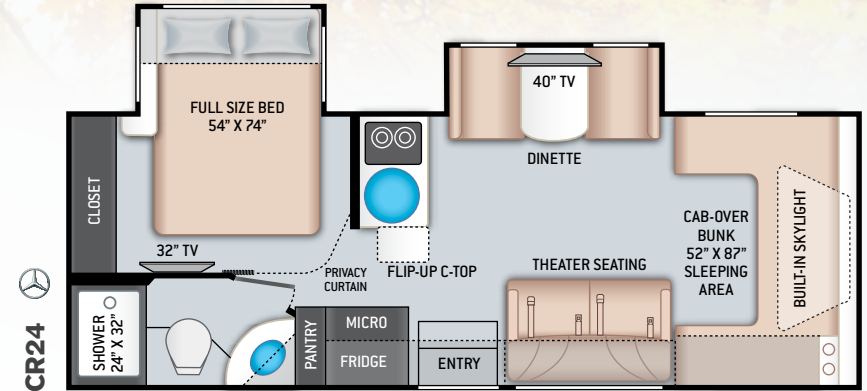



# Class C Featured Highlights

## CONSTRUCTION & EXTERIOR

- Ford® E-Series Chassis - 7.3L V8 350HP 468 lb-ft Torque
- Automatic Leveling Jacks with Touchpad Controls (JM31, LF31 & WS31)
- SmoothTECH™ by Mor-Ryde (JM31, LF31 & WS31)
- HD-MAX® Exterior with Graphics Package (RC25 & LH26)
- Partial Paint on HD-MAX® with Graphics Package (JM31, LF31 & WS31)
- MEGA-Storage™ Compartment (RC25 & LH26)
- Welded Tubular Aluminum Roof & Sidewall Cage Construction
- 8,000-lb. Trailer Hitch
- Electric Stabilizing System (RC25, LH26 & KW29)
- Frameless Slider Windows (JM31, LF31 & WS31)
- Power Patio Awning with Integrated LED lighting

## CONSTRUCTION & EXTERIOR OPTIONS

- Chevrolet® Chassis - 6.0L V8 323HP 373 lb-ft Torque (RC25 & LH26)
- Partial Paint on HD-MAX® Exterior with Graphics Package (RC25, LH26, & KW29)
- Full Body Paint Package with Gel-Coat Sidewalls & Protective Mask IPO Partial Paint (JM31, LF31 & WS31)
- Full-Body Paint Package with Protective Mask IPO HD-Max (KW29)

## AUTOMOTIVE & COCKPIT

- Touchscreen Dash Radio with Back-Up Monitor
- SiriusXM® Radio Tuner & Antenna
- Living area Speaker tied to Dash Stereo
- Heated/Remote Exterior Mirrors with Integrated Side View Cameras (KW29, JM31, LF31 & WS31)
- Leatherette Captain's Chairs
- Leatherette Swivel Captain's Chairs with Filler Cushions (RC25)
- Deluxe Exterior Mirrors (RC25 & LH26)

- Emergency Engine Start Switch
- Aluminum Running Boards
- Stainless Steel Wheel Liners
- Valve Stem Extenders
- Cruise Control
- Tilt Steering Wheel
- Windshield Privacy Curtain
- Keyless Entry System
- Stainless Steel Wheel Liners
- LED Taillights
- Dash Applique

## AUTOMOTIVE & COCKPIT OPTIONS

- Heated/Remote Exterior Mirrors with Integrated Side View Camera (RC25 & LH26)
- Power Driver's Seat - Ford® Chassis Only (KW29, JM31, LF31 & WS31)
- Cockpit Carpet Mat

## INTERIOR

- High-Gloss Glazed Cabinetry with Solid Wood Cabinet Doors, Hardwood Fascia, Hidden Hinges & Nickel Finish Hardware
- Decorative Glass Inserts in Kitchen Overhead Cabinet Doors
- Pressed Laminate Countertops throughout Except Kitchen
- Full Extension Metal Ball-Bearing Drawer Guides
- LED Lighting
- Leatherette Jack-Knife Sofa (LH26, KW29, JM31, LF31 & WS31)
- Leatherette Dream Dinette® Booth
- Wall Cubby with Net & USB Charging Port
- USB Charging Port at Dinette
- Ceiling Ducted Air Conditioning System
- Premium Window Privacy Roller Shades with New Window Treatments

## INTERIOR OPTIONS

- Leatherette Theater Seat IPO Jack-Knife Sofa (LH26, KW29, JM31 & WS31)

- Cab-Over Child Safety Net
- 12-volt Attic Fan with Cover in Cab-Over Bunk
- Single Child Safety Tether in Dinette

## KITCHEN

- Double Door Gas/Electric RV Refrigerator with Smoked Acrylic Panel Inserts (RC25, LH26, & KW29)
- 12cuft. Residential Refrigerator (JM31, LF31 & WS31)
- Recessed 3-Burner Gas Cooktop with Glass Cover (RC25, LH26, & KW29)
- Protective Cover & Task Lighting Above Cooktop (RC25, LH26, & KW29)
- 2-Burner Gas with Single Induction Cooktop (JM31, LF31 & WS31)
- Microwave Oven (RC25, LH26, & KW29)
- 30" Over-the-Range Convection Microwave Oven (JM31, LF31 & WS31)
- Flip-Up Countertop Extension (RC25, LH26, KW29 & JM31)
- Pop-Up Countertop Outlet & Charging Center (KW29, JM31, LF31 & WS31)
- Solid Surface Kitchen Countertops with Sink Covers
- Large Single Bowl Stainless Steel Sink with Single Handle Faucet with Pull-Down Sprayer
- Large Kitchen Window behind Kitchen Sink and Cooktop (N/A LH26)
- 12-volt Attic Fan with Switch (RC25, LH26, & KW29)

## KITCHEN OPTIONS

- Recessed 3-Burner Gas Cooktop/Oven with Glass Cover (RC25, LH26, & KW29)
- Convection Microwave Oven (RC25, LH26, & KW29)

## BEDROOM & BATHROOM

- Queen Size Bed (N/A KW29)
- King Size Bed (KW29)
- Bedroom 12-volt Outlet for CPAP Machine

- Bedroom USB Power Charging Center for Electronics
- 12-volt Attic Fan with Cover in Bedroom
- Power Bath Vent with Wall Switch
- Foot Flush Porcelain Toilet
- Stainless Steel Bathroom Sink
- Skylight in Shower
- Shower with Glass Door

## ENTERTAINMENT

- 39" TV in Living Area (RC25, KW29, JM31, & WS31)
- 39" TV on Manual Swivel in Cab-Over (LH26 & LF31)
- 32" TV in Bedroom
- 32" Exterior TV on Manual Swivel with Bluetooth® Sound Bar (KW29, JM31, LF31 & WS31)
- HDMI Video Distribution Box
- Cable TV & HD/DSS Satellite Ready

## ENTERTAINMENT OPTIONS

- Exterior 32" TV on Swivel Bracket with Bluetooth® Sound Bar and Radio (LH26)

## ELECTRICAL & PLUMBING

- Onan® RV QG 4000 Gas Generator
- Automatic Generator Start (JM31, LF31 & WS31)
- Automatic Shoreline-to-Generator Transfer Switch
- Winegard® Connect™ 2.0 WiFi / 4G / TV Antenna
- 30-amp Shoreline Power Cord
- 1800-watt Inverter (JM31, LF31 & WS31)
- Second Auxiliary House Battery
- Battery Tray for Four (4) Batteries (JM31, LF31 & WS31)
- Solar Prep - Includes Solar Controller
- Tankless Water Heater
- 13,500 BTU Roof Front Air Conditioner (RC25 & LH26)
- 15,000 BTU Roof Front Air Conditioner (KW29, JM31, LF31 & WS31)
- Exterior LP Connection

- Whole Coach Water Filtration System (JM31, LF31 & WS31)
- Outside Shower
- 360° Siphon® RV Holding Tank Vent Cap
- 1" Fresh Water Tank Drain
- Black Tank Flush System
- Enclosed Sewer Area for Sewer Tank Valves (JM31, LF31 & WS31)
- Holding Tanks with Heat Pads
- Stackable Washer/Dryer Prep (KW29)
- Combo Washer/Dryer Prep (JM31)
- Systems Control Center

## ELECTRICAL & PLUMBING OPTIONS

- 15,000 (IPO 13,500) BTU Roof Front Air Conditioner (RC25 & LH26)
- Dual 11,000 BTU Roof Air Conditioners IPO 15,000 BTU Roof Air Conditioner (KW29, JM31, LF31, & WS31)
- 100-watt Solar Charging System with Power Controller

For a complete listing of available features visit [thormotorcoach.com/quantum](http://thormotorcoach.com/quantum).



	RC25	LH26	KW29	JM31	LF31	WS31
Chassis	Ford	Ford / Chevy	Ford	Ford	Ford	Ford
Gross Vehicle (GVWR)	14,500	14,500 / 14,200	14,500	14,500	14,500	14,500
Gross Combined (GCWR)	22,000	22,000 / 20,000	22,000	22,000	22,000	22,000
Wheel Base	178"	190" / 191"	212"	219"	223"	223"
Exterior Length (w/o ladder)	26'-4"	27'-6" / 28'	30'-11"	32'-2"	32'-7"	32'-2"
Exterior Height (w/AC)	11'-2"	11'-2"	11'-2"	11'-2"	11'-2"	11'-2"
Exterior Width (w/o mirrors)	99"	99"	99"	99"	99"	99"
Interior Height (living area)	84"	84"	84"	84"	84"	84"
Awning Size	16'	18'	18'	18'	16'	16'
Fuel (gal)	55	55/57	55	55	55	55
LPG (lbs)	40.9	40.9	40.9	40.9	40.9	40.9
Fresh/Waste/Gray Water (gal)	40 / 34.5 / 37	40 / 29 / 25	40 / 34.5 / 37	40 / 31 / 35	40 / 28 / 28	40 / 28 / 28
Water Heater (gal)	Tankless	Tankless	Tankless	Tankless	Tankless	Tankless
Furnace (BTUs)	30,000	30,000	30,000	30,000	30,000	30,000
Exterior Storage Capacity (cu. ft.)	45	27.3	50.4	44.5	55.7	55.7
Hitch Weight Rating (lbs)	8,000	8,000	8,000	8,000	8,000	8,000

# Sprinter Featured Highlights

## CONSTRUCTION & EXTERIOR

- Mercedes-Benz Sprinter - 3.0L V6 188HP 325 lb-ft Torque
- Electric Stabilizing System
- Welded Tubular Aluminum Roof & Sidewall Cage Construction
- Fiberglass Front Cap with Skylight, and Power Shade
- 5,000-lb. Trailer Hitch
- HD-MAX® Exterior with Graphics Package
- Lighted Rotocast Storage Compartments
- Flush Mount Radius Compartment Doors
- Power Patio Awning with Integrated LED Lighting
- Premium One-piece TPO Roof
- Slide out Room Topper Awnings
- Electric Entry Step with Accent Light Under Step on Separate Switch
- Entry Door with Deadbolt Lock
- Black Framed Windows

## CONSTRUCTIVE & EXTERIOR OPTIONS

- Full-Body Paint Package with Protective Mask

## AUTOMOTIVE & COCKPIT

- Touchscreen Dash Radio with Back-Up Monitor & Integrated Camera
- SiriusXM® Radio Tuner & Antenna
- Heated/Remote Exterior Mirrors

- Power Windows & Door Locks
- Cruise Control
- Windshield Privacy Curtain
- Leatherette Swivel Captain's Chairs with Two (2) Filler Cushions
- Cockpit Carpet Mat
- Stainless Steel Wheel Liners
- Keyless Entry System
- Valve Stem Extenders
- LED Taillights
- Dash Applique

## INTERIOR

- Cab-Over Sleeping Area with Cup Holders, and Bunk Ladder
- Wall Cubby with Net & USB Charging Port
- Rubber Tread Entry Steps with Lighted Step Well
- Ceiling Ducted Air Conditioning System
- High-Gloss Glazed Cabinetry with Solid Wood Cabinet Doors, Hardwood Fascia, Hidden Hinges & Nickel Finish Hardware
- Decorative Glass Inserts in Kitchen
- LED Lighting
- Pressed Laminate Countertops throughout Except Kitchen
- Wall Cubby with Net & USB Charging Port
- Leatherette Theater Seating with Footrests (CR24)

- Leatherette Dream Dinette® Booth (KM24)
- Leatherette Dinette Booth with Two (2) Storage Drawers (CR24)
- USB Charging Port at Dinette
- Premium Window Privacy Roller Shades with New Window Treatments
- Full Extension Metal Ball-Bearing Drawer Guides

## INTERIOR OPTIONS

- Cab-Over Child Safety Net
- 12-volt Attic Fan with Cover in Cab-Over Bunk
- Single Child Safety Tether in Dinette (KM24)

## KITCHEN

- Double Door Gas/Electric RV Refrigerator with Smoked Acrylic Panel Inserts
- 3-Burner Gas Cooktop with Glass Cover (KM24)
- 2-Burner Gas Cooktop with Glass Cover & Electric Start (CR24)
- Protective Cover & Task Lighting Above Cooktop
- Convection Microwave Oven
- Decorative Glass Inserts in Kitchen Overhead Cabinet Doors
- Solid Surface Kitchen Countertop
- Flip-up Countertop Extension
- 12-volt Ceiling Vent in Kitchen with Under Cabinet Switch

- Large Single Bowl Stainless Steel Sink with Single Handle Faucet with Pull-Down Sprayer (KM24)
- Large Round Single Bowl Stainless Steel Sink with Single Handle Faucet with Pull-Down Sprayer (CR24)

## BEDROOM & BATHROOM

- Queen Size Bed (KM24)
- Full Size Bed (CR24)
- Bedroom 12-volt Outlet for CPAP Machine
- Bedroom USB Power Charging Center for Electronics
- 12-volt Attic Fan with Cover in Bathroom & Bedroom
- Power Bath Vent with Wall Switch
- Shower with Curved Anti-Microbial Shower Curtain
- Skylight in Shower
- Foot Flush Toilet
- Stainless Steel Bathroom Sink

## ENTERTAINMENT

- 40" TV in Living Area (CR 24)
- 32" TV on Manual Swivel in Living Area (KM24)
- 32" TV in Bedroom
- HDMI Video Distribution Box
- Cable TV & HD/DSS Satellite Ready

## ELECTRICAL & PLUMBING

- Onan® RV QG 3600 LP Generator
- Winegard® Connect™ 2.0 WiFi / 4G / TV Antenna

- 30-amp Shoreline Power Cord
- Automatic Shoreline-to-Generator Transfer Switch
- Battery Disconnect Switch
- Auxiliary House Battery (Group 31)
- 13,500 BTU Roof Front Air Conditioner
- Systems Control Center
- Exterior LP Connection
- 100-watt Solar Charging System with Power Controller
- Tankless Water Heater
- 1" Fresh Water Tank Drain
- 360° Siphon® RV Holding Tank Vent Cap
- Holding Tanks with Heat Pads
- Black Tank Flush System
- Outside Shower

## ELECTRICAL & PLUMBING OPTIONS

- 15,000 (IPO 13,500) BTU Roof Front Air Conditioner

For a complete listing of available features, visit [thormotorcoach.com/quantum-sprinter](http://thormotorcoach.com/quantum-sprinter).

	CR24	KM24
Chassis	Mercedes-Benz Sprinter	Mercedes-Benz Sprinter
Gross Vehicle (GVWR)	11,030	11,030
Gross Combined (GCWR)	15,250	15,250
Wheel Base	170.3"	170.3"
Exterior Length (w/o ladder)	25'-7"	24'-8"
Exterior Height (w/AC)	11'-8"	11'-8"
Exterior Width (w/o mirrors)	90"	90"
Interior Height (living area)	84"	84"
Awning Size	16'	15'
Fuel (gal)	26.4	26.4
LPG (lbs)	68.2	68.2
Fresh/Waste/Gray Water (gal)	30 / 34.5 / 37	30 / 24.5 / 38
Water Heater (gal)	Tankless	Tankless
Furnace (BTUs)	30,000	30,000
Exterior Storage Capacity (cu. ft.)	47	48.5
Hitch Weight Rating (lbs)	5,000	5,000



Made to fit.

P.O. Box 1486, Elkhart, IN 46515 Sales Department: 800.860.5658

[thormotorcoach.com/quantum](http://thormotorcoach.com/quantum)



IMPORTANT—PLEASE READ: This brochure reflects product design, fabrication, material, components and specifications at the date of printing, which date is disclosed below. Please visit us online at [ThorMotorCoach.com](http://ThorMotorCoach.com) or consult with your selling dealership for the latest in standards, options, specification and technical information. Photographs in the brochure may depict optional equipment or may only be available in certain floor plans. Components, appliances and the chassis may have been manufactured in a calendar year before the vehicle's designated model year. All capacities are approximate. The actual length of the vehicle may differ from that indicated in the brochure due to variances in the manufacturing processes and/or installed components. All dry weights are based on standard model features and do not include optional features or equipment. Component part and appliance manufacturers issue limited warranties covering portions of the vehicle not covered under the limited warranty we issue. Copyright Thor Motor Coach, Inc. © MY 07/14/2020