

Jayco | 2024 Jay Flight SLX Travel Trailer

JAY FLIGHT SLX

#1 SELLING TRAVEL TRAILER FOR 15 YEARS



2+3
YEAR | YEAR
WARRANTY

INTERIOR DESIGN



CLASSIC FARMHOUSE



Main Wood



Accent Wood



Floor



Countertop



Main Fabric



Accent Fabric



JAY FLIGHT SLX

154BH/154BHW



174BH/174BHW



STORAGE

MICRO

MICROWAVE

OHC

OVERHEAD CABINETS

FRIDGE

REFRIGERATOR

WARD

WARDROBE

OPTIONS

A



Jackknife Sofa

183RB/183RBW

OPTION: A

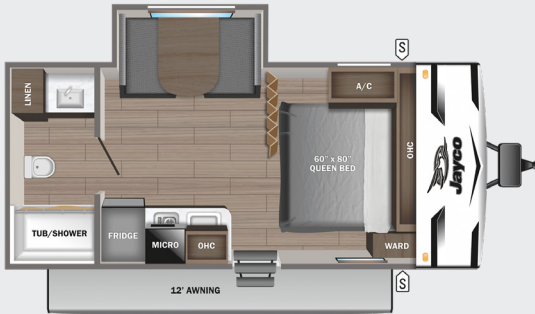

184BS/184BSW

OPTION: A



195RB/195RBW



210QB/210QBW

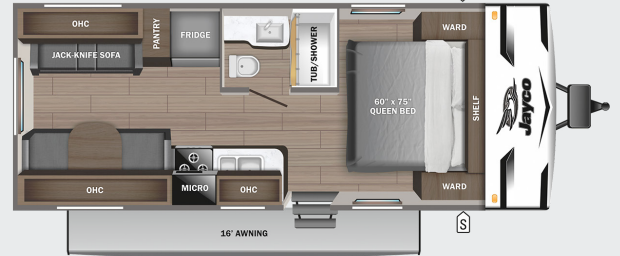

211MBW

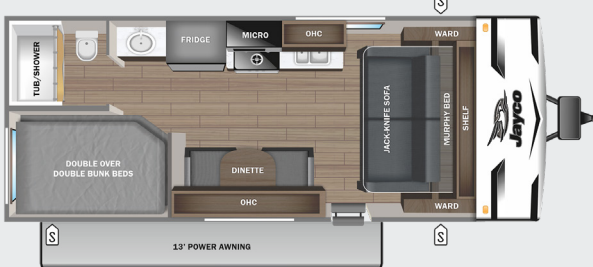

260BH/260BHW



261BH/261BHW

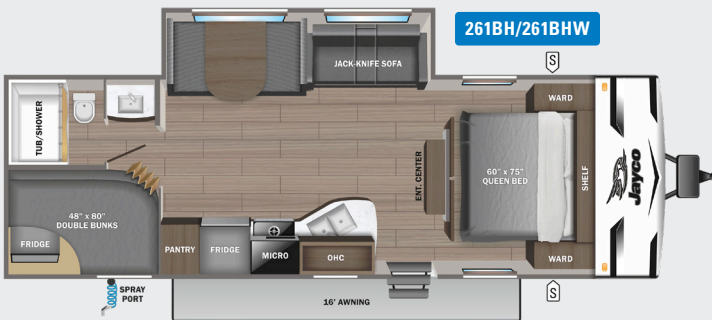

262RLS/262RLSW



STANDARDS & OPTIONS

EXTERIOR

30-amp service
5,000 BTU wall mount A/C (single axle models)
Axles with electric, self-adjusting brakes and easy-lube hubs
Exterior cable TV hookup
Fully-integrated A-frame
Galvanized-steel, impact resistant wheel wells
Large exterior downspouts
Propane quick connect (outside grill prep)
Magnum Truss™ Roof System
Nitrogen filled radial tires
PVC roofing membrane (limited lifetime warranty)

INTERIOR

300 lb. rated single bunk beds
600 lb. rated double bunk beds
Digital TV antenna
Heavy-duty, 75 lb., full-extension, steel ball-bearing drawer guides
High rise kitchen faucet
Marine-grade toilet with foot flush
Plywood bed platforms
Queen mattress (select models)
Residential-style kitchen countertops
Shower curtain with curved shower track (select models)
Solid hardwood cabinet doors with screwed stile construction and hidden hinges
Vinyl flooring throughout
Wood-trimmed mirror in bathroom

CUSTOMER VALUE PACKAGE (MANDATORY)

8 cu. ft. 12V refrigerator
AM/FM/Bluetooth® stereo
Backup camera prep
Bathroom skylight
Bathroom vent
Detachable power cord
Fitted bed sheet (N/A 154BH)
Entry door with window and shade prep
G20 dark tinted privacy windows
Keyed-Alike™ entry and baggage doors
Large folding entry door grab handle
LED interior and exterior lights
Marine grade exterior stereo speakers
Microwave oven
On-demand tankless water heater
Power awning with LED lights
Range hood
Solid Step® entry steps
Spare tire with cover
Stabilizer jacks
Tub/shower surround
Window shades

STX EDITION (INDIANA BUILT UNITS ONLY)

30 lb. propane bottle (single axle models)
Aluminum rims
Deluxe graphics package
Double entry step
Enclosed underbelly
Goodyear® off-road tires
Powder coated wheel fenders
Power tongue jack

Stabilizer jacks (4)
Wide-stance axle

BAJA PACKAGE (IDAHO BUILT UNITS ONLY)

30 lb. LP bottle
Deluxe graphics package
Double entry step
Enclosed underbelly
Goodyear® off-road tires
Powder coated wheel fenders
Stabilizer jacks (4)
Wide-stance axle

OPTIONS

13,500 BTU roof mounted A/C
(Mandatory on 210QB/210QBW, 260BH/260BHW, 261BHS/261BHSW and 262RLS/262RLSW)
15,000 BTU roof mounted A/C
(261BHS/261BHSW and 262RLS/262RLSW)
Baja Package (Idaho built, single axle units only)
Fiberglass sidewalls
J-steel jackknife sofa with table
(183RB/183RBW and 184BS/184BSW)
Outside griddle with propane quick connect hose
Overlander 1 Solar Package: (1) 200W solar panel and 30-amp digital controller
STX Edition (Indiana built, single axle units only)

| FLOORPLAN | TOTAL EXTERIOR LENGTH | EXTERIOR WIDTH | EXTERIOR HEIGHT (WITH A/C) | INTERIOR HEIGHT | UNLOADED VEHICLE WEIGHT | DRY HITCH WEIGHT | GVWR | CARGO CARRYING CAPACITY | FRESH WATER CAPACITY | GRAY WASTE WATER CAPACITY | BLACK WASTE WATER CAPACITY | SLEEPING CAPACITY |
|-----------|-----------------------|----------------|----------------------------|-----------------|-------------------------|------------------|-------|-------------------------|----------------------|---------------------------|----------------------------|-------------------|
| 154BH | 18' 0" | 7' 1" | 9' 2" | 6' 6" | 2,690 | 270 | 3,600 | 910 | 30 | 19.9 | 19.9 | 2-4 |
| 154BHW | 18' 0" | 7' 1" | 9' 3" | 6' 6" | 2,640 | 295 | 3,600 | 960 | 30 | 19.9 | 19.9 | 2-4 |
| 174BH | 21' 8" | 7' 1" | 9' 2" | 6' 6" | 3,140 | 310 | 4,150 | 1,010 | 30 | 19.9 | 19.9 | 3-5 |
| 174BHW | 21' 8" | 7' 1" | 9' 4" | 6' 6" | 3,070 | 310 | 4,150 | 1,080 | 30 | 19.9 | 19.9 | 3-5 |
| 183RB | 21' 1" | 7' 1" | 9' 5" | 6' 6" | 3,375 | 360 | 4,350 | 975 | 30 | 19.9 | 19.9 | 2-4 |
| 183RBW | 21' 1" | 7' 1" | 9' 5" | 6' 6" | 3,225 | 320 | 4,350 | 1,125 | 30 | 19.9 | 19.9 | 2-4 |
| 184BS | 21' 7" | 7' 1" | 9' 5" | 6' 6" | 3,350 | 380 | 4,500 | 1,150 | 30 | 19.9 | 19.9 | 4-6 |
| 184BSW | 21' 7" | 7' 1" | 9' 6" | 6' 6" | 3,355 | 365 | 4,500 | 1,145 | 30 | 19.9 | 19.9 | 4-6 |
| 195RB | 21' 10" | 7' 1" | 9' 2" | 6' 6" | 3,020 | 315 | 3,995 | 975 | 30 | 19.9 | 19.9 | 2-4 |
| 195RBW | 21' 10" | 7' 1" | 9' 3" | 6' 6" | 3,015 | 295 | 3,995 | 980 | 30 | 19.9 | 19.9 | 2-4 |
| 210QB | 25' 8" | 8' 0" | 10' 6" | 6' 9" | 4,195 | 500 | 5,500 | 1,305 | 52 | 39 | 33 | 3-5 |
| 210QBW | 25' 10" | 8' 0" | 10' 7" | 6' 9" | 4,315 | 500 | 5,500 | 1,185 | 84 | 40 | 33 | 3-5 |
| 211MBW | 26' 4" | 8' 0" | TBD | 6' 9" | TBD | TBD | TBD | TBD | 84 | 40 | 40 | 6-8 |
| 260BH | 29' 5" | 8' 0" | 10' 6" | 6' 9" | 4,580 | 515 | 6,000 | 1,420 | 52 | 39 | 39 | 7-9 |
| 260BHW | 29' 6" | 8' 0" | 10' 6" | 6' 9" | 4,685 | 500 | 6,000 | 1,315 | 84 | 40 | 40 | 7-9 |
| 261BH | 30' 4" | 8' 0" | 11' 1" | 6' 9" | 5,825 | 685 | 7,100 | 1,275 | 52 | 39 | 39 | 8-10 |
| 261BHW | 30' 4" | 8' 0" | 11' 2" | 6' 9" | 5,804 | 719 | 7,100 | 1,296 | 76 | 40 | 40 | 8-10 |
| 262RLS | 30' 4" | 8' 0" | 11' 1" | 6' 9" | 5,995 | 770 | 7,000 | 1,005 | 52 | 39 | 39 | 4-6 |
| 262RLSW | 31' 1" | 8' 0" | 11' 1" | 6' 9" | 6,044 | 778 | 7,200 | 1,156 | 76 | 40 | 40 | 4-6 |

Meet your Jayco Dealer



Scan QR code for specification definitions

Some specs at the time of print may include estimates. For the most updated information, please visit Jayco.com

Jayco, Inc. | P.O. Box 460 | Middlebury, IN 46540

See dealer for further information and prices. All information in this brochure and on www.jayco.com is the latest available at the time of publication approval. Jayco reserves the right to make changes and to discontinue models without notice or obligation. Photography may show optional equipment or props used for decoration purposes only. RVs built for sale in Canada may differ to conform to Canadian codes. JAYCO and the JAYCO BIRD IN FLIGHT are registered trademarks of Jayco, Inc. Printed in USA 3/24 ©2024 Jayco, Inc.



Jayco - Part of the Jayco Family of Companies