

# Eagle Cap

## 2019 Premium Luxury Truck Campers



1165 Triple Slide

TruckCamperMAGAZINE.com

**2014 Readers' CHOICE AWARDS**



**Best Truck Camper  
Innovation of the Year**

**Eagle Cap Modular Furniture System:  
Dinette/Sofa/Theater Seating**



TruckCamperMAGAZINE.com

**2017 Readers' Choice Awards**



**Best Truck Camper  
Innovation of the Year**

**Eagle Cap Extended Swing-Away Dining Laptop Table**

*A Premium RV Manufacturer since 1969 - [www.AMLRV.com](http://www.AMLRV.com)*



# Dare to Compare Page

## 22 Exclusive Features

Not Available on Other Brands

- 3-Year Structural Warranty
- EC Max - 4 Season Insulated
- One Piece Fiberglass Front Cap
- TCC Construction (True Composite Construction)
- All Season 6-step Sealing Process
- Reverse Trim TPO front roof seal
- Channeled TPO side roof seal
- Frameless TTP Windows - True Thermal Pane
- 26" Entry Doors - wider easier access
- Comfort Step Bumper - Optional
- Modular Dinette Furniture
- Theater Seating Recliners - Optional
- 32" TV (Optional 1160, 1165, 1200)
- 72"x 84" Cal King Bed (std 960, 1200)
- Grabber Catches on all Int cabinet Doors
- Soft/Self Closing drawer guides
- Slam Latches - Ext Compartment Doors
- 30,000 BTU Furnace
- Interior/Exterior Mood Light - LED
- 102" Wide Body Models - 1160, 1165, 1200
- Flame Treated Fabric - all models
- 7 & 8 cu ft Refer - 7cuft 811, 960 / 8cuft 1160, 1165, 1200

## 24 Standard Features

Optional or Not Available on Other Brands

Also included in our base weights

- One Piece Fiberglass Cap
- Lamilux 4000 Ext Fiberglass
- Keyless Entry - std on all models
- Stereo - AM/FM/CD/DVD/Bluetooth/HDMI/App Controllable w/ext Speakers
- Heki Bedroom Skylight
- Microwave
- Micro-Convection oven (1200)
- Fantastic Fan
- Awning Slide Toppers
- Dual 12V / USB Charging Centers
- Frameless TTP Windows - True Thermal Pane
- Taller Bath Skylights
- 4-Season Insulation - "EC-Max"
- 1" Insulated Ext doors
- Water Heater By-pass Valve
- Winterization Valve
- LED Lights - Interior & Exterior
- Digital Thermostat-(A/C & Heat)
- Dream Dinette - no annoying table leg
- Sofa / Bed - (std 1160/1165/1200)
- Sealed Burner Cooktop
- Black Tank Flush System
- Phat Ladder®
- Stainless Steel Appliances

## Available Options

- 19" & 28" LCD 12V TV (select models)
- 32" LCD 12V TV (1160, 1165, 1200)
- Low Profile A/C w/Digital Wall T-Stat
- Comfort Step Bumper - w/double step w/reversed treads
- Generator Ready - Required w/Gen Opt
- Generator - 2500W Cummins/Onan LPG
- Jack Brackets - Swing Out (Req for Dually)
- 12v Electric Patio Awning w/LED (1160, 1165, 1200)
- 12v Power Rear Awning w/LED (811 & 960 only - n/a on 1160, 1165, 1200)
- Side Patio Awning - Box 811- 8', 960 - 10'
- Roof Rack System-(Maggie w/Cross Bars)
- Solar Panel - 100 Watt w/Regulator
- Solar Panel - Additional (add 2 for up to 3)
- Theater Seating Recliners - w/swing away tables (Replaces std sofa in 1160, 1165, 1200)
- Water Filter - drinking w/separate faucet
- Wireless Backup Camera - HD Color

## 3 - Year Structural Warranty

Eagle Cap Campers provide a 3-year structural warranty. Appliance warranties vary and are set by their respective manufacturer. Please contact your dealer for complete details regarding warranty



## BEST INSULATED

## PERIOD!

**Ceiling - R-19**

**Walls - R-13**

**Floor - R-22**

**30,000 BTU Furnace**

**Ducted Basement heat**

**True Thermal Pane Windows**

**Insulated Baggage Doors**

Notice: Eagle Cap's policy is one of continual improvement and reserves the right to make changes to all features and/or options at our discretion without prior notice and without incurring any obligation. Note: Photos may not be of the current model year or interior color. Please confirm all options and details with your dealer and/or an Eagle Cap representative before ordering or making a final buying decision.



# Dare to Compare Page

## EAGLE CAP CONSTRUCTION

**1. GEL-COAT AERODYNAMIC TWO-TONE FIBERGLASS FRONT CAP!** No other camper is built with these structural components – tougher, stronger, better sealed! This cap is designed to fit perfectly to the contour of our camper providing a tight, perfect fit. You will also note the beautiful two-tone gel-coat finish, adding that high end luxury look with better aerodynamics!

**2. AIRCRAFT QUALITY WELDED ALUMINUM FRAME SUPERSTRUCTURE!** Best aluminum framing techniques -utilizing 2x2 and 2x4 Aircraft Quality Aluminum framing plus ALP's exclusive TCC® bonding process creates a second to none structure and also provides you with our exclusive ALP 3-year structural warranty!

### 3. ALP Exclusive "All Season Six-Step exterior sealing process"

Six different levels of exterior seals providing the best sealed camper in the industry!

1. All seams/joints sealed with construction adhesive/sealant.
  2. One-piece fiberglass cap and seams are sealed with 3M Extreme Seal®, the best seal in the industry!
  3. Exterior finish trim is sealed with butyl seal, no putty tape that dries out!
  4. Finish Trim is then silicone sealed.
  5. **ALP Exclusive** – Reverse seal front seam seal system
  6. **ALP Exclusive** – Channeled side roofing seal system
- Six Seals instead of one... you decide!**

### 4. EC MAX – MAXIMUM 4-SEASON INSULATION!

Highest R-Values – We use only \* Closed Cell Block Foam Insulation, TPO Insulated roof, providing you with R-19 in ceiling / R-22 in the floor / R-13 in the walls. True thermal pane insulated windows, 1" insulated exterior baggage doors, easy access winterization valves, ducted heat with full basement heat and a 30,000 BTU furnace, all standard, making the Eagle Cap cooler in the summer, warmer in the winter, easier to winterize and providing you the best 4-Season thermal insulated truck camper in the industry! No One Else Has This Much Insulation... you decide! \* Think of a coffee cup... 1/8" thick, 160 degree coffee and never hot to the touch, plus no liquid penetration... imagine 28 times that thickness in your roof!

### 5. LAMILUX 4000 GEL-COAT FIBERGLASS EXTERIOR WALLS!

Lamilux 4000 fiberglass is not only a high gloss beautiful finish but is also a thicker fiberglass providing you with a stronger wall structure than other campers!

### 6. FRAMELESS - 4-SEASON TRUE THERMAL PANE WINDOWS!

Eagle Cap is truly built like no other camper and it is only logical that Eagle Cap would have the latest high end luxury "Frameless" windows. Not only are they beautiful but they are actually a true thermal pane window meaning they are 4-season insulated and provide you 40% more R-Values over a standard RV window used in other brands!

**Eagle Cap "Built Like None Other"... you decide?**



## 3 - Year Structural Warranty

Eagle Cap Campers provide a 3-year structural warranty.

Appliance warranties vary and are set by their respective manufacturer. Please contact your dealer for complete details



**BUILD YOUR OWN CAMPER ON OUR WEBSITE AT - AMLRV.com**



# Special Features & Options



**The largest exterior cargo storage in a truck camper...** This is the kind of storage you see in large Motorhomes, std on 1160/1165 & 1200 models



**Wireless Backup camera with Color monitor,** watch while you are driving or inside your camper at night - optional



**Standard Dual Digital T-Stat & Central Control center** along with Optional Generator, Solar controls and Filtered Drinking water w/faucet all shown here.



## Eagle Cap's 12V ELECTRIC REAR AWNING w/LED Lights...

Enjoy the outdoors with Eagle Cap's (optional) electric rear awning. With just a touch of a button you can open or close your awning, no more need for two people and with the built-in gas props it handles rainy and windy conditions reducing your typical cause of awning damage. Note the patio side box awnings also shown here as another popular option.

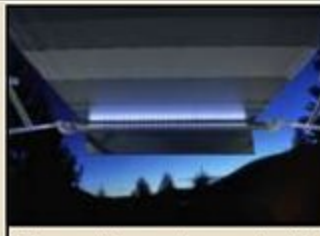

**More outdoor enjoyment with Eagle Cap's electric awning** with built in LED awning light



**New - Ext. LED Mood/Service Lights** these lights can be controlled from inside for security, loading your camper or camping ambiance... (Std feature)

**100% LED Lighting...** Eagle Cap gives you 100% LED lighting from the awning to the taillights! Led lighting has 8 to 10 times less power draw allowing you to use less power making your camping enjoyment last longer...



**Interior LED Mood Lighting...** Enjoy the ambiance in your Eagle Cap with the standard interior mood lighting. Turn it on for that romantic evening in or as a night light. Either way it is Cool...

**New - Ext LED Service/Mood Lighting** under the wings of your truck camper you have LED lighting to light up your camp area or for tying down/service your camper!

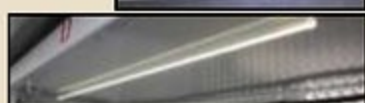

## Eagle Cap 13,500 Low-Profile A/C...

See the difference between a std A/C (in the distance) and the Eagle Cap 13,500 (HE high efficiency) Low-Profile A/C in this photo, significantly reducing your exterior height.



**Roof Rack System With Cross Bars** - Take all the toys with you, kayaks, canoes or add major rack manufactures accessories for additional storage, solutions like ski's, cargo cubes etc.

## Eagle Cap Standard Feature - Slam Latches and magnetic catches on all Exterior Compartment doors...

Eagle Cap truck campers have "Slam Latches"... it's name says it all, drop the door and it "slams" shut or you can simply gently press it shut for an easy one handed close. The best part of the new slam latches is the ease of opening, simply lift up the single lever handle with one hand and open your compartment door. **all exterior compartments now have magnetic door catches to hold them up out of the way!** This makes it easier to load and unload leaving one hand open to carry your items with out having to set them down to open the door.



**New - Dual 12V / USB Charging Centers...** Two charging stations which includes two USB charge ports & a 12v power point. Dinette & Bedroom locations



**NEW - Digital Omni Directional TV/Radio Antenna** This antenna provides your signal for both your digital TV channels and your AM/FM Radio providing you with high quality signals for both TV and Radio all from one antenna...



**BUILD YOUR OWN CAMPER ON OUR WEBSITE AT - AMLRV.com**



# Eagle Cap Exclusive & Industry leading Interiors...

**Eagle Cap - Built Like None other! -**

**As example our 2014 & 2017 TCM Readers Choice "Innovation of the year" awards...**

The dinette seating is modular in design, meaning the standard Dream Dinette® sections are designed to be removed, replaced and/or optioned with any of our other industry first and exclusive features like a Sofa Bed, our Theater Seating Recliners. All of these features are built to the same dimensions making them completely interchangeable... Only in an Eagle Cap can you have a set of Theater Seating Recliners with dinning/laptop Swing/Away tables in a single slide truck camper. Want something other than that in your dinette area? Order without the dinette and add what ever aftermarket item you wish, desk, bunk beds you name it! EAGLE CAP's engineering and innovation shine through...



## Eagle Cap's Industry Leading, Exclusive Interior Dinette Options



2019 Theater Seating - w/Swing-Away Tables - Domino Decor



2019 Theater Seating - w/Swing-Away Tables - Denim Decor



2019 Theater Seating - w/Swing-Away Tables - Denim Decor



2019 Dream Dinette / Bed - Domino Decor



2019 Sofa / Bed w/storage drawer - Denim Decor

## 2019 Interior Decor Choices



**Domino Decor**



**Denim Decor**

**Notice: Eagle Cap's policy is one of continual improvement and reserves the right to make changes to all features and/or options at our discretion without prior notice and without incurring any obligation. Note: Photos may not be of the current model year or interior color. Please confirm all options and details with your dealer and/or an Eagle Cap representative before ordering or making a final buying decision.**



# Eagle Cap's Luxury Single,



**811** Fits SB and LB Trucks (6' to 8' even w/Generator)

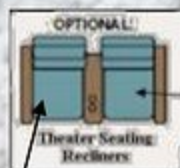

Overhead Cabinet  
**960** Fits LB Trucks (8') only

## 3 - Year Structural Warranty



Eagle Cap Campers  
provide a 3-year  
structural warranty.

Appliance warranties vary and  
are set by the respective  
manufacturer.  
Contact ALP or your dealer for  
complete details.

## Weights & Measures

	811 Single Slide	960 Single Slide
Standard Sleeping Capacity	4	4
Floor Length	8'11"	9'10"
Exterior Width (inches)	96"	96"
Exterior Overall Length (Nose to rear ladder)	17'2"	18'5"
Exterior Height (Floor to top of A/C)	105"	105"
Interior Height (inches)	78"	78"
Dinette Size (inches)	43" x 69"	42" x 66"
Fresh Water Capacity (US Gallons)	44	44
Grey Water Capacity (US Gallons)	34	31
Black Water Capacity (US Gallons)	34	31
Hot Water Capacity (US Gallons)	6	6
Refrigerator Size (Cubic Feet)	7	7
Dry Weight (LBS)	3362	3598
COG (Center of Gravity inches)	37"	50"

See "Truck Camper Guide" Page for Matching a Truck to a Camper



# Double & Triple Slide Floorplans



**1160** Fits LB (8') Dually Trucks

**1165** Fits LB (8') Dually Trucks

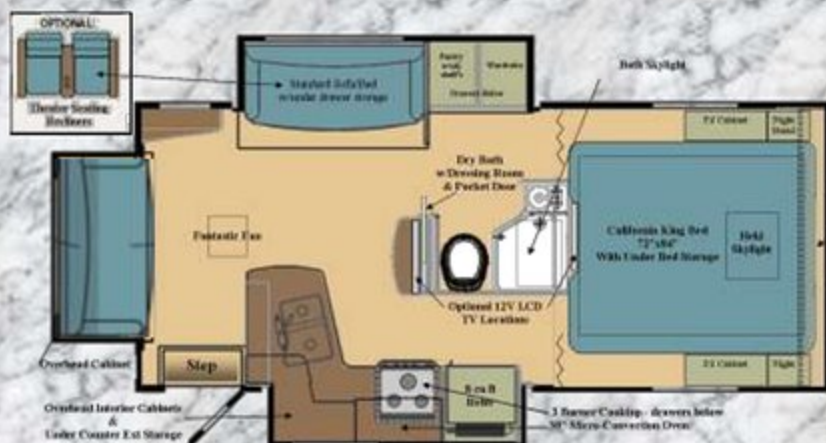

**1200** Fits LB (8') Dually Trucks



1160 Double slide	1165 Triple slide	1200 Triple slide	<i><b>Weights &amp; Measures</b></i>
6	6	6	Standard Sleeping Capacity
11'6"	11'6"	11'11"	Floor Length
102"	102"	102"	Exterior Width (inches)
20'10"	20'10"	21'3"	Exterior Overall Length (Nose to rear ladder)
112"	112"	112"	Exterior Height (Floor to top of A/C)
76"	76"	76"	Interior Height (inches)
42" x 66"	42" x 66"	N/A	Dinette Size (inches)
66	66	66	Fresh Water Capacity (US Gallons)
41	41	34	Grey Water Capacity (US Gallons)
41	41	34	Black Water Capacity (US Gallons)
6	6	6	Hot Water Capacity (US Gallons)
8	8	8	Refrigerator Size (Cubic Feet)
4649	4890	4933	Dry Weight (LBS)
57.5"	59.5"	58"	COG (Center of Gravity inches)

**3 - Year  
Structural  
Warranty**



**Eagle Cap Campers  
provide a 3-year  
structural warranty.**

Appliance warranties vary and  
are set by the respective  
manufacturer.

Contact ALP or your dealer for  
complete details.

*See "Truck Camper Guide" Page for Matching a Truck to a Camper*



# Roomy Campers with Large Dream Dinettes



Face to Face Dream Dinette - standard on 811, 960, 1160, 1165, (shown here in the 960)

Eagle Cap features the standard Dream Dinette where you don't have that annoying table leg in your way, giving you more foot room in your dinette. The best part about this dinette is with the flip of a lever the table simply presses down to make into a bed without having to remove the whole table, to restore it back to a dinette you simply pull the gas propped table up and lock the lever!

## Exclusive Large Galleys...



2019 1160 - Galley

The 1160 Galley enjoys large cabinet storage and stainless steel appliances, large countertop area, **undermount stainless steel sink, grated cooktop with large oven below.** Note the optional 32" LED 12V TV and the separate filtered drinking water faucet.

Eagle Cap Features Shine through!



2019 1200 - Galley

The Eagle Cap 1200 enjoys the largest galley in the industry with abundant storage and even more counter space. Note the 3 burner cooktop with three large drawers below and the **30" stainless steel convection microwave** above. When you add the pull-out pantry and the 8 cu ft refrigerator the 1200 Galley is more like an apartment than a truck camper...  
**Eagle Cap Exclusives through out!**



2019 811 - Galley

The Eagle Cap 811 Single Slide enjoys a large galley with abundant overhead cabinet storage and plenty of counter space. The Stainless Steel Appliances really accent this open concept living, dining and Galley floorplan... This model gives you the largest floor space in a single slide truck camper!

Eagle Cap Luxury not seen in other campers!

**BUILD YOUR OWN CAMPER ON OUR WEBSITE AT - [AMLRV.com](http://AMLRV.com)**



# Luxurious Queen & California King Bedroom Suites...



2019 - 811 Queen Bedroom Suite-Domino Decor

The 811 Eagle Cap has a roomy luxurious Queen Bedroom Suite with dual bedroom windows for that cool cross ventilation, dual door wardrobe and an ALP exclusive Camper Caddy Storage system...



2019 - 1200 Calif King Suite-Denim Decor

Eagle Cap 1200 Features an industry Exclusive California King (72"x 84") Bedroom Suite with dual access from both sides of the camper.

## The Best Truck Campers with the most interior room...



2019 - 1200 front to rear view w/std Sofa & Theater Seating Recliners -Denim



2019 - 1160 front to rear view w/Dream Dinette & Recliners-Domino Decor



2019 - 1200 rear to front view w/Recliners & Dual bedroom access-Denim Decor

**Top Right - 1200 Rear to Front View.** Notice the extremely large open space in this largest in the Industry 12' Truck camper. Note the dual access to the California King (72"x 84") Bedroom Suite. Also note the optional 32" Living room TV and the Theater Seating Recliners shown here with the Swing Away Tables. (Denim Décor)

**Top Left - 1200 Front to Rear view,** Notice the small apartment size truck camper, dual sofa's are standard, **note the ALP Exclusive Theater Seating Recliners** (optional) in the side slide not seen in any other truck camper!

**Left - 1160 Front to Rear View** To the right you see the standard Face to Face Dream Dinette that makes into a bed. At the rear you see the Industry Exclusive optional Theater Seating Recliners...

Notice: Eagle Cap's policy is one of continual improvement and reserves the right to make changes to all features and/or options at our discretion without prior notice and without incurring any obligation. Photos may not be of the current model year or interior color. Please confirm all options and details with your dealer and/or an Eagle Cap representative before ordering or making a final buying decision.



# Truck Camper Guide

## Matching a Camper to a Truck

When purchasing a Truck Camper, there are a few important factors to consider

- The payload capacity** – sometimes this rating is posted in the glove box of your truck, if not, another way to determine payload capacity would be to weigh your truck, full of fuel, people and of course the dog, and then subtract that weight from the (GVWR) posted on the door of your truck (see example to the right) and that difference would equal your payload capacity (weight of camper you can carry). Example, your truck weighs 6800lbs and the GVWR on the door reads 9900lbs your payload would be 3100lbs (9900lbs-6800lbs=3100lbs).
- GVWR (Gross Vehicle Weight Rating)** – is the maximum weight the manufacturer rates their truck to carry, including weight of the truck and all people, cargo, fuel etc.
- GAWR (Gross Axle Weight Rating)** – is the maximum rating the manufacturer rates the axles to carry. These ratings are usually posted on the driver's side doorpost. To determine these ratings on your truck with cargo (camper) weigh your truck with just the front and then just the rear axle on the scales. This will give you your axle weights for your truck with your camper, these weight should fall within the manufacturers axle ratings.
- Tire capacity (rating of your tire)** – This is the tiny fine print on the sidewall of your tire, see photo to the right, usually just behind the tire inflation number. This will usually be a direct correlation to the axle ratings and GVWR on new trucks. **This will always be your weak link** in your weight carrying capacity and should always be checked before carrying any load, including a passenger car for that matter. **SAFETY ALERT – Always make certain you choose tires with the proper load capacity to handle whatever load you are carrying with your vehicle! Another Way to determine Payload** is from the Tire sticker on the door post of your truck (right), this sticker is added on newer trucks reflecting tire load or payload rating
- COG (Center of Gravity)** – also known as Center of Balance, is the point that the weight of your camper is balanced, ALP notes the COG on every camper with a large red arrow, this is determined as it is weighed and balanced as it goes out the door. Your camper COG should fall into the "Load Range" of your truck, see your owners manual for this measurement. As you can see in this example, to the right, the COG of this camper easily falls into the load range of this truck. As the owner, it is your responsibility not to exceed the weight or COG specifications of your truck when purchasing a truck camper. Always think safety first before loading a camper on your truck. Please consult your dealer, who can help you select aftermarket items designed to aid in proper use of your truck and camper combination.



### Suspension Enhancements - Suspension enhancements allow you to

manage your load but does not change or add to a trucks GVWR. In some areas you can make upgrades to your truck and then have it inspected by a DOT (Department of Transportation) and you may be able to increase your "legal" GVWR, check with your local licensing agency for details in your area.

**Torklift Stable Loads** - We use and recommend this product. Today's truck manufacturers market trucks to be our everyday driver, thus they want the empty loaded truck to be as smooth a ride as possible. To accomplish this they lower the overload spring (the heavy weight bearing springs) 3" to 4" lower to give that smoother ride when empty. The problem with this is when you add any weight to the truck it appears to be sitting low in the rear or "overloaded" since the vehicle has to drop 3 to 4" before it touches the overload spring. Stable Loads by Torklift simply fill this space so that as soon as you add the load, the weight immediately sets on the overload springs allowing your trucks suspension to do what it was designed to do, carry a load, a camper in this case.



**Air Bags** - We use and recommend air bags also, in the correct application. Some truck manufacturers recommend airbags in all applications and suggest you inflate them 80 to 100 lbs in the bags. **We don't recommend air bags to be used in this way**, because in too many cases, this will raise your camper up off of the suspension causing you to have a spongier unsafe ride! If you choose air bags we only recommend you inflate them so that you are just touching the overload springs of your truck for the best ride and handling characteristics.



**BUILD YOUR OWN CAMPER ON OUR WEBSITE AT - AMLRV.com**



# Testimonials

**"Your company makes, in my opinion THE BEST TRUCK CAMPER ON THE MARKET TODAY!...we have had many R.V's & have viewed an abundance of truck campers critically! We've hashed over a variety of campers for over 2 years before making our decision, by dissecting them in every way possible...Adventurer products with the storage & drawers galore, accessibility to areas needed, beautiful cabinetry/decor, large baths, large fridge, ext. deck & comfort steps ETC!!! Maury was looking for a camper to fit our short box truck, yet meet all of my criteria too etc!" - Sharon (& Maury)**

## **You guys are doing things right...**

"Your campers really stand out from the crowd with all the innovative features, floor plans, and options. King beds, rear kitchens, etc. have drawn us to your brand as well as the construction and warranty. I wish I had a dually so I could get the 1165 model. A kitchen island in a camper, seriously... You guys are doing things right. Thank you again" - Jason



**"The videos are great and these campers look like the best that's on the market."** - Jim



## **Thanks for all the support and answering my questions.**

"Congratulations men very nice camper. Can not wait to get mine. Selling like hotcakes. Thanks for all the support and answering my questions." - Harley

## **The tour helped cement our decision to purchase a Eagle Cap 1165**

"We are writing to thank you for the great factory tour you gave us late on a Friday afternoon October 3. The tour helped cement our decision to purchase our Eagle Cap 1165. We were impressed with virtually every step of the design and build process. We look forward to using the camper on many adventures." -Sincerely, Bruce & Barb

## **You stand out in the world of manufacturers...**

"In our search for our Pickup camper we are blessed with God's guidance in each step of the way. In your statement regarding the enjoyment of traveling and enjoying the wonder of God's creation we appreciate your "witness" in words. Your campers stand out in all the searching and comparison shopping we have done. Thanks for your company, you stand out in the world of manufacturers, in all areas"

- Ken and Peggy

## **I was impressed with the info I got off your website!**

"I don't normally answer emails like this but I was impressed with the info I got off your website. I am just starting to look at options for a new/newer RV and I thought your website was super useful." - Thanks Dan



Your Authorized Dealer:



811 Single Slide



Manufactured by  
Adventurer LP (ALP)  
3303 West Washington Ave  
Yakima, WA 98903 PH: 509-895-7064

***Factory Tours - Welcomed!***  
***We invite you to visit our facility!***

***During your tour you will see Eagle Cap  
Truck Campers being assembled with  
tremendous pride, skill and exclusive  
techniques that show you why Eagle Cap is  
"Built Like None Other"!***

***Tours are available by appointment  
Please call for details or to make your appointment.  
See ya soon...***

**[www.AMLRV.com](http://www.AMLRV.com)**

***A Premium RV Manufacturer since 1969***