

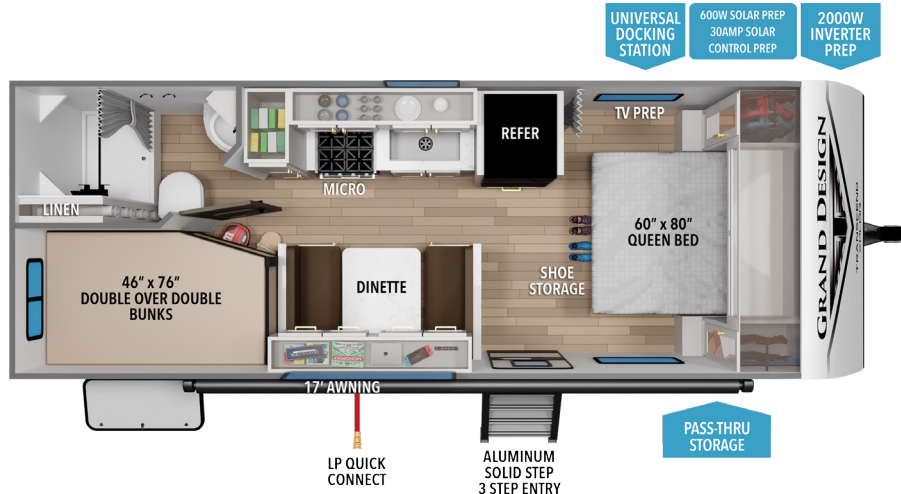

TRANSCEND XPLOR



**EXPLORE
MORE**



	EXT. LENGTH	UVW	HITCH	GVWR	AWNING	WATER CAPACITIES			SLEEPS
19BHX	26' 3"	4,942	782	6,995	17'	FRESH	GRAY	WASTE	
						56 (Gal.)	78 (Gal.)	39 (Gal.)	7

ALL TRANSCEND XPLOR FLOORPLANS

FLOORPLAN SPECIFIC

- 600W Solar Prep, 30AMP Solar Controller Prep, 2000W Inverter Prep - (Optional Installed 200W Panel and 30AMP Solar Controller Available)
- 10 cu 12V Refrigerator w/ Glass Cover
- Pull Out Trash Can Storage In Kitchen
- GDRV Branded Int/Ext Table w/ Dedicated Storage
- Pots and Pans Storage Drawers
- Paper Towel Holder in Kitchen
- JBL Bluetooth Head Unit + JBL Int and Ext Speakers
- Updated Bedroom Wardrobe w/ Folding and Hanging Storage
- New Interior Flush Mount Lighting
- Two in One Exterior Pet Leash and Bottle Opener

- Interior Dog Bowls w/ Dedicated Drawer
- Updated Exterior Griddle and Larger 1.7 cu Refer in Camp Kitchen (Select Models)
- Standard 13.5K Roof Mount A/C
- Heated and Enclosed Underbelly
- Magnetic Cabinet Door Catches
- Magnetic Interior and Exterior Door Catches
- 60 x 80 Residential Queen Bed
- Through Frame Flush Floor Slides
- Universal Docking Station

- True 60 x 80 Queen Bed
- Under 27'
- Smart RV Kitchen Storage
- Rear Bath w/ Linen Cabinet
- 2 46X76 Bunk Beds
- Starlink Prep
- EZ-Antifreeze

SIMILAR FLOORPLANS

23BHX

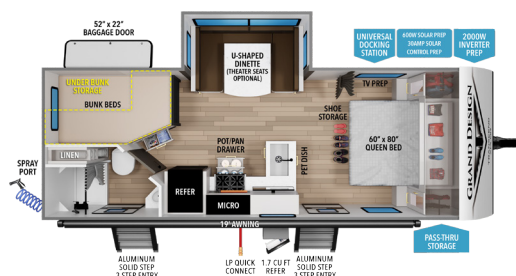

27DBX

