

FOREST RIVER PRESENTS

# ROCKWOOD

ROCKWOOD

MINI LITE ETC SERIES · MINI LITE SERIES · ROO SERIES



MINI LITE ETC SERIES · MINI LITE SERIES · ROO SERIES





MODEL 181

White Birch



*The Rockwood Mini Lite ETC is unique in it's class. It has a long list of std features including a full size regular awning, 13.5 K AC, LED exterior lights, Euro Style Jealousy windows, full size furnace and much, much more. With all of these features included, the ETC is still towable by a small SUV or Mini-van making this trailer a perfect fit.*



## Rockwood Mini Lite ETC Series Floorplans

181

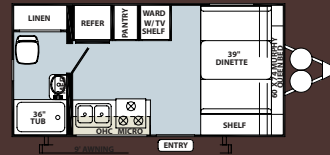

184

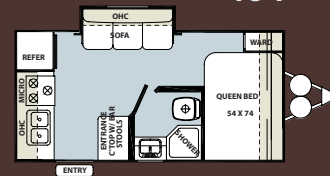

188

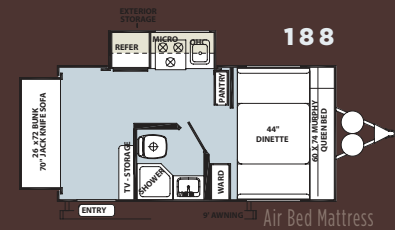

## Rockwood Mini Lite ETC Series Specifications

Model number of any particular unit does not necessarily reflect the overall length of the unit itself. Dry weight are estimates.

MODEL	181	184	188
GVWR (Gross Vehicle Weight Rating)	3649	3786	3858
BASE/DRY UNIT WEIGHT	2611	2773	3136
BASE DRY HITCH WEIGHT	347	286	358
BASE DRY AXLE WEIGHT	1988	2108	2405
CARGO CAPACITY	1000	1000	1058
LENGTH	18' 5"	18' 5"	18' 5"
WIDTH	90"	90"	90"
HEIGHT W/O A/C	105"	105"	105"
INTERIOR HEIGHT	78"	78"	78"
FRESH WATER CAPACITY	37 gal	37 gal	37 gal
GRAY WATER CAPACITY	30 gal	30 gal	30 gal
BLACK WATER CAPACITY	30 gal	30 gal	30 gal





MODEL 1809

AMERICAN

# Rockwood Mini Lite Series Floorplans

1809

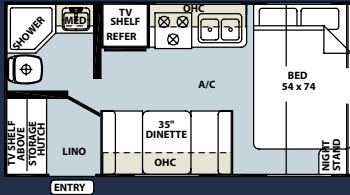

1809S

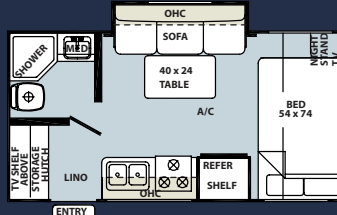

2104

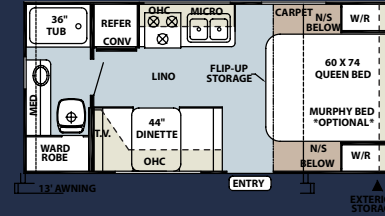

2304

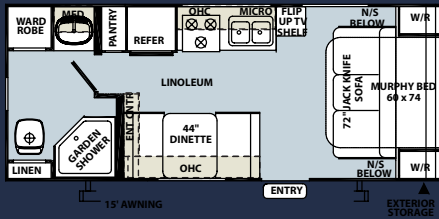

2306

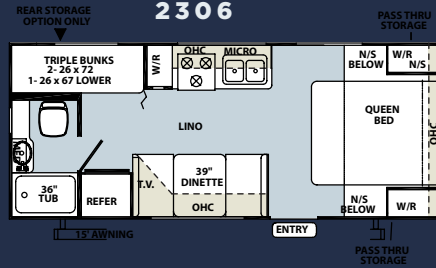

2502S

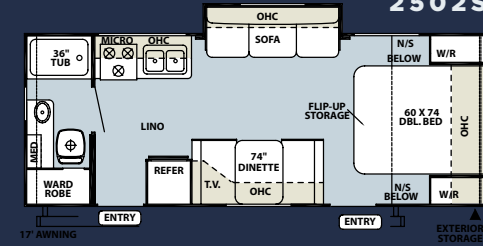

*Mini but mighty. The Mini Lite is here. Mini-lite trailers are excellent for those who want to move from the tent camper to the light-weight towable. The light, small compact design was created for families driving vans and small sport utility vehicles.*

*With residential amenities and excellent features, you're sure to enjoy the Mini Lites*

## Rockwood Mini Lite Series Specifications

Model number of any particular unit does not necessarily reflect the overall length of the unit itself. Dry weight are estimates.

MODEL	1809	1809S	2104	2304	2306	2502S
GVWR (Gross Vehicle Weight Rating)	4229	4300	4634	4761	4670	5756
BASE/DRY UNIT WEIGHT	2958	3029	3052	3139	3291	3885
BASE DRY HITCH WEIGHT	137	263	390	490	270	401
BASE DRY AXLE WEIGHT	2821	2766	2662	2649	3021	3484
CARGO CAPACITY	1233	1233	1233	1233	1233	1833
LENGTH	20' 1"	20' 1"	22'	23' 4"	23' 8"	25' 7"
WIDTH	96"	96"	96"	96"	96"	96"
HEIGHT W/O A/C	105"	105"	112"	112"	112"	112"
INTERIOR HEIGHT	78"	78"	78"	78"	78"	78"
FRESH WATER CAPACITY	37 gal	37 gal	37 gal	37 gal	37 gal	37 gal
GRAY WATER CAPACITY	30 gal	30 gal	30 gal	30 gal	30 gal	30 gal
BLACK WATER CAPACITY	30 gal	30 gal	30 gal	30 gal	30 gal	30 gal



# ROCKWOOD Features

*Rockwood takes careful consideration to each feature added into each product produced. Every detail is considered ranging from sleeping, relaxing, comfort and convenience.*

*Take time to review the features listed below and match them with the competition's products. We're confident you'll discover Rockwood the superior choice.*



A

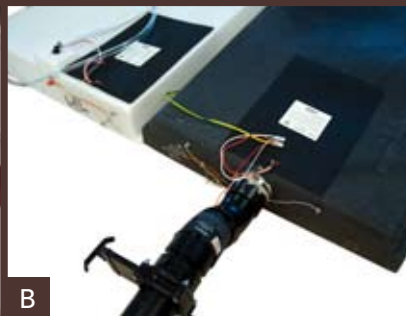

B



C



D



E



F

- A** RVQ grill (Opt.)
- B** Heated holding tanks with 12 volt heat pads. (Opt. N/A on ETC)
- C** Exterior shower (Std. N/A on ETC)
- D** Fantastic Fan (Std. Opt)
- E** Aluminum dinette frame with storage
- F** Heated Innerspring Mattresses (Std. Opt.)



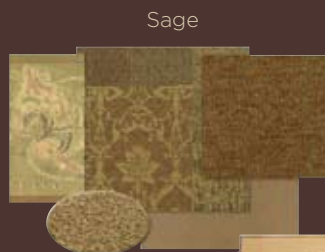
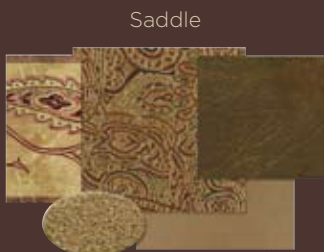
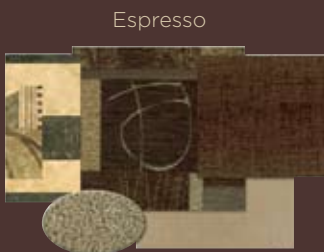

Cherry Décor Option



Standard Linoleum

Oak Décor Option  
(N/A on ETC)



Wood-Look Linoleum  
(Available Only with Tuscan Cream Décor)

Tuscan Cream Décor Option



A



B



C



D

- A** Power Awning with Adjustable Rain Dump *(Opt.)*
- B** Aluminum Rims *(Opt. but Std. on ETC)*
- C** Water Filter *(Std. Opt.)*
- D** Hardwood Doors & Drawers
- E** Outside Speaker *(Std. on ETC, C.P. on Mini Lite and Roos)*



E

# ROCKWOOD Construction

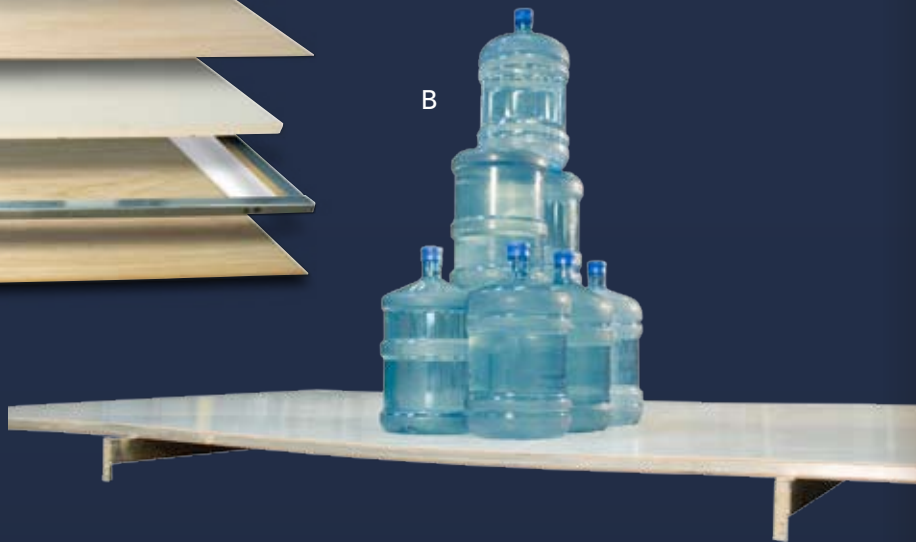

*Rockwood takes pride in constructing the very best products possible in each price point. From our entry level units to our top of the line products, no short cuts are taken to achieve excellence.*

*Where some may glue their cabinets together, we glue and screw each piece together ensuring a lasting fit. Rockwood drawers never bend under the weight of their contents. The full extension metal drawer guides not only open and close smoothly but will last far longer than the competition's plastic version.*

*From the all-steel I-beams to the residential interior amenities to the vacuum bonded exteriors, Rockwood products are quality-built from the ground-up.*

**A** Rockwood is one of the few light weight manufacturers that is a **fully** 6 sided vacuum bonded trailer. Our walls, floors, roof, fronts and backs are all built vacuum bonded to ensure a light weight strong structural trailer.

**B** Structurally engineered materials makes our vacuum-bonded walls some of the strongest in the industry.



**A** Power Awning with Adjustable Rain Dump (*Opt.*)

**D** All Steel "I" beam frame construction (*Most Models*)

**B** Glued and screwed cabinetry

**E** ALKO® AXLES AND EASY LUBE HUBS

- Fully independent wheel suspension.
- Lower trailer center of gravity for improved stability.
- No metal to metal contact and no springs, shackles, hangers, or U-bolts to break or wear out.

**C** Large dinette storage drawers with full extension drawer guides

**F** Full extension metal drawer guides in the kitchen



A



B



C



D

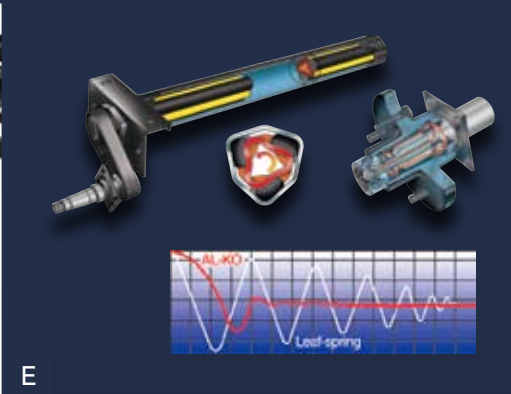

E



F



Roosoft Slide  
MODEL 21SS



Summer days or rainy nights have little affect on the interior thanks to the fully vacuum bonded exterior. Rockwood Roo is proud to be the only fully vacuum bonded expandable with a full vacuum bonded radius roof.

Interiors expand with flush-floor slides hosting residential kitchen features as solid wood door and drawers, full extension metal drawer guides, and water filtration system.

With all this and more, take a serious look at the Rockwood Roo. It's the best value for your investment.

- A** RVQ grill (Opt.)
- B** Outside speaker (Std. on ETC and C.P. on Roo and Mini Lite.)
- C** Exterior shower (Std. N/A on ETC)
- D** Fantastic Fan (Std. Opt)
- E** Bunk Cables (Std.) (No poles needed)
- F** Bunk Light Fan (Std.)
- G** Water Filter (Std. Opt.)
- H** Heated Innerspring Mattresses (Std. Opt.)
- I** Aluminum Rims (Std. on ETC, Opt. on Roo and Mini Lite)



A



B



C



D



E



F



G



H



I



A



B



C1



C2



D

## Rockwood Roo Series Specifications

Model number of any particular unit does not necessarily reflect the overall length of the unit itself. Dry weight are estimates.

MODEL	17	183	183L	19	19L	21SS	21BH	233	233S	23SS	21RS	23RS	21SSL
GVWR (Gross Vehicle Weight Rating)	3852	4638	7262	4639	7216	5626	4753	5504	5964	6322	5273	6061	7335
BASE/DRY UNIT WEIGHT	2789	3202	3946	3170	3602	3972	3189	3633	4093	4108	3659	3847	4783
BASE DRY HITCH WEIGHT	352	238	300	239	298	645	413	433	565	509	594	625	335
BASE DRY AXLE WEIGHT	2437	2964	3646	2931	3602	3327	2776	3200	3528	3599	3065	3222	4448
CARGO CAPACITY	1025	1233	2900	1233	2900	1233	1233	1833	1833	1833	1233	1833	2224
LENGTH	18' 11"	20' 9"	31' 1"	20' 9"	31'	21' 6"	22'	23' 9"	23' 9"	24' 6"	21' 8"	23' 9"	32'
TRAILER LENGTH (OPEN)	22' 11"	24' 9"	33' 5"	24' 9"	33' 5"	25' 6"	22' 6"	27' 9"	27' 9"	28' 6"	25' 2"	27' 3"	35' 6"
WIDTH	96"	96"	96"	96"	96"	96"	96"	96"	96"	96"	96"	96"	96"
HEIGHT W/O A/C	112"	112"	112"	112"	112"	112"	112"	112"	112"	112"	112"	112"	118"
INTERIOR HEIGHT	78"	78"	78"	78"	78"	78"	78"	78"	78"	78"	78"	78"	78"
FRESH WATER CAPACITY	37 gal	37 gal	37 gal	37 gal	37 gal	37 gal	37 gal	37 gal	37 gal	37 gal	37 gal	37 gal	37 gal
GRAY WATER CAPACITY	30 gal	30 gal	30 gal	30 gal	30 gal	30 gal	30 gal	30 gal	30 gal	30 gal	30 gal	30 gal	30 gal
BLACK WATER CAPACITY	30 gal	30 gal	30 gal	30 gal	30 gal	30 gal	30 gal	30 gal	30 gal	30 gal	30 gal	30 gal	30 gal

Family convenience, quality, and fun have all been wrapped up into one expandable trailer. Rockwood calls the Roo.

The Roo is loaded with amenities your family will enjoy every day they camp. The Rockwood Roo focuses on easy set-up and camping comfort so all your family has to do is enjoy the fun. With the Roo, we are confident that fun won't be a problem.

- A** Power Awning with Adjustable Rain Dump (Opt.)
- B** Aluminum dinette frame with storage
- C1** Vacuum Bonded Radius Roof
- C2** Radius roof foam with built in A/C ducts (N/A ETC and Models w/o Ducted Air)
- D** Vacuumed bonded floor with 16" on center floor joists (Roo only)





# Rockwood Roo Series Floorplans

17

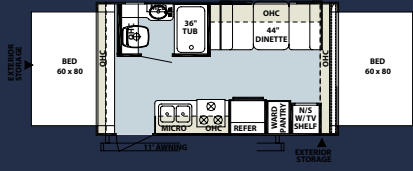

19

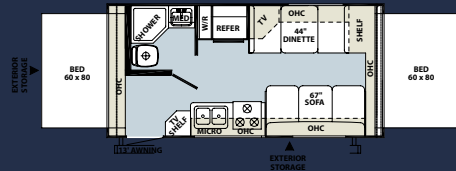

19L

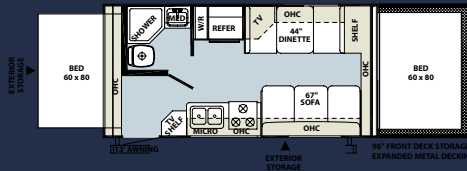

21BH

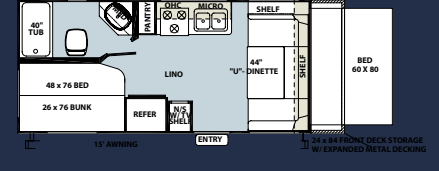

21RS

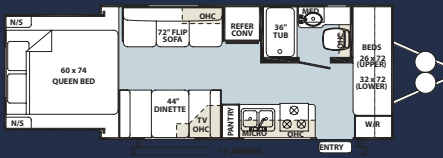

21SS

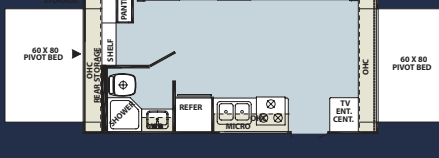

21SSL

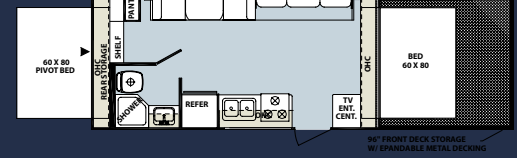

23RS

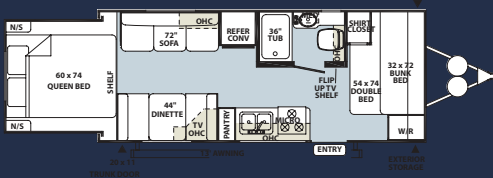

23SS

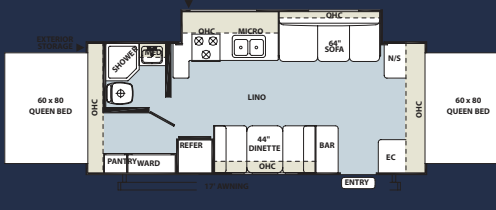

183

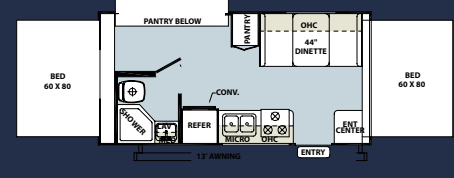

183L

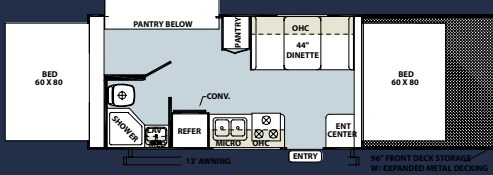

233

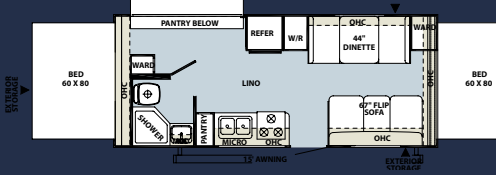

233S

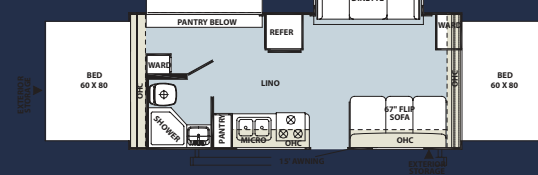

# Rockwood Mini Lite ETC, Mini Lite, & Roo Standards & Options

Standards and options are subject to change

MODELS	ETC	ML	R
· Fully Laminated Aluminum Frame (Floor, Sidewall, & Roof)	S	S	S
· Insulation Factors R-7 Side Wall, R-12 Floor and R-14 Ceiling	--	S	S
· R-7 Sidewalls and Ceiling, R-12 Floors	S	--	--
· Easy Lube Axles	S	S	S
· Foot Flush Toilets	S	S	S
· Aluminum Bed and Dinette Frames	S	S	S
· Laminated Filon Fiberglass Sidewalls	S	S	S
· Screwed and Glued Cabinetry	S	S	S
· Vinyl Roof	--	S	S
· Fiberglass Roof	S	--	--
· Torsion Axle, Rubber-Ryde Suspension	S	S	S
· Electric Slide-Out (Where Available)	S	S	S
· Ducted Furnace	S	S	S
· Solid Wood Raised Panel Doors and Drawers	S	S	S
· Digital AM/FM/CD/DVD w/ Remote	S	S	S

MODELS	ETC	ML	R
· Residential One-Piece Sink Cover/ Cutting Board	S	S	S
· Monitor Panel	S	S	S
· Tub Surround	S	S	S
· Three Burner High Output Gas Range	S	S	S
· Six Gallon "Quick Recovery" Water Heater	S	S	S
· Water Heater By-Pass Kit	S	S	S
· Outside Shower	--	S	S
· Phone Jack	S	S	S
· Two-20 Lb Gas Bottles	S	S	S
· Molded Bottle Cover	S	S	S
· Bathroom Skylight	S	S	S
· 55 Amp Converter With Charger	S	S	S
· Auto Gas/Electric Refrigerator	S	S	S
· Stabilizer Jacks	S	S	S
· Residential Drawer Guides	S	S	S
· Directional Reading Lights on Sofa Slides	S	S	S

MODELS	ETC	ML	R
· Create-A-Breeze Three Speed Fantastic Vent	SO	SO	SO
· <b>Extra</b> Create-a-Breeze Fan (N/A on 17, 19, 232 Roo's and 2502S mini lite only)	--	0	0
· Heated Mattress (N/A on 188)	SO	SO	SO
· Water-Pur Filtration System	SO	SO	SO
· 13,500 BTU Ducted Air (2502S Only)	--	CP	CP
· 13,500 Air (N/A Mini Lite 2502S, Roo models 183, 183L, 19L, 19 and 17)	S	CP	CP
· Microwave	S	CP	CP
· Gas Oven	S	0	0
· Awning	S	CP	CP
· Power Awning with Rain Dump (N/A 17, 21RS & 23RS ROO)	0	0	0
· Outside Gas Grill and Worktable	0	CP	0
· 110 DSI Gas/Electric Water	--	0	CP
· Raised Refrigerator Panels	--	0	0
· Tuscan Cream Raised Refer Fronts	--	0	0

ETC = MINI LITE ETC, ML = MINI LITE, R = ROO

S = STANDARD

0 = OPTIONAL

CP = CONVENIENCE PACKAGE

SO = STANDARD OPTION

-- NOT AVAILABLE



MODELS	ETC	ML	R
· Electronically Controlled Heated Holding Tanks	--	0	0
· Spare Tire Carrier & Cover	S	CP	0
· Aluminum Wheels	S	0	0
· Slide Out Toppers	--	--	0
· Stainless Steel Appliances	--	0	0
· CSA	0	0	0
· Outside Speakers	S	CP	CP
· Tinted Safety Glass	--	CP	CP
· Euro-Styled Jealousy Window with Built in Sun Shade	S	--	--
· LED Exterior Lights	S	--	--
· 15" LCD TV	0	CP	0
· Tire Pressure Monitoring System	--	0	0
· Carbon Monoxide Detector	SO	SO	SO
· Murphy Bed Option (2104 Mini Lite only, Std. 181, 188 & 2304)	S	0	--
· Radius Roofs	--	S	S

MODELS	ETC	ML	R
· Automotive Radial Tires	S	S	S
· Radius Corner Windows and Doors	S	S	S
· Decorative Frame Skirting	--	--	S
· Industrial Lockable Bed Latches	--	--	S
· Bed Cable System (No Poles)	--	--	S
· 14" Tires with Double Step	--	0	S
· Decorative Valances	--	S	S
· Bunk Fan/Light Combination with Each Bed	--	--	S
· Large Dinette Picture Window	S	S	S
· Indoor/Outdoor Table	S	S	S
· Sliding Front Storage Tray (Where Available)	--	--	0
· Power Jack	--	--	0
· Storm Windows	--	0	0
· Chrome-look Wheel Covers	--	0	0
· TV Antenna w/ Cable & Satellite Hook-Up	S	S	CP



ETC = MINI LITE ETC, ML = MINI LITE, R = ROO

S = STANDARD

0 = OPTIONAL

CP = CONVENIENCE PACKAGE

SO = STANDARD OPTION

-- NOT AVAILABLE

MINI LITE ETC  
MINI LITE  
ROO

ROCKWOOD

## FOREST RIVER'S HALLMARK OF EXCELLENCE PRE-DELIVERY INSPECTION FACILITIES



### THAT'S 20,000 SQUARE FEET OF QUALITY ASSURANCE. THE BARE ESSENTIALS FOR A PREMIUM PRODUCT.

Brought online in 2005, Forest River is proud of its state-of-the-art test facility. This beautiful building blends many of the old tried and true methods of testing our diverse types of RVs with new innovative ways of solving quality issues. Being centrally located to most Forest River manufacturing facilities, this 20,000 square foot

PDI (Pre-delivery Inspection) test building gives immediate daily feedback to individual managers. This assures the production facilities that nothing has slipped by the plant's quality assurance personnel and the units are "green" and ready to ship.

FOREST RIVER ENCOURAGES YOU TO

**BUY  
LOCALLY**  
FROM YOUR HOMETOWN DEALERSHIP.

Forest River, Inc. strongly encourages our retail customers to purchase from their local dealership whenever possible due to the following factors:

- 1) Our Dealers are as a rule, independently owned and operated businesses. Outside of those customers they personally sold products to, they are not contractually obligated to perform warranty service on Forest River products that were purchased elsewhere. There may be an occasion that you would be required to return to the point of purchase to satisfy warranty requirements.
- 2) Although many dealerships will eventually service products not purchased at their place of business, they will usually take care of their customers and other Forest River customers who are traveling away from their local dealer as they would their own.

3) Local purchases allow a customer to establish a relationship with a dealer close to home. This relationship provides the customer with a convenient location for service and support from a "home town" professional.

4) The opportunity for a thorough PDI (Pre Delivery Inspection) and product orientation is an additional benefit of buying from your local dealer. Further providing the opportunity for refresher courses or the ability to get questions answered much more conveniently.

5) For our Canadian customers, there are also requirements which must be met to bring an RV purchased out of the country to their home. Although not insurmountable, these requirements may involve such things as additional inspections and certifications, taxes and fees. Your local Canadian Dealer is a professional at meeting these requirements.

6) Forest River's goal is for all RV Owners to fully enjoy their RV experience. In light of this goal, and considering the advantages of buying local, we encourage you to be thorough when determining what product to purchase and which dealer to purchase it from as both are key to your ultimate satisfaction and the realization of your dreams.

For details on Rockwood's complete warranty program, see your Rockwood dealer. When it comes to backing products with the same quality and commitment it has when it begins the manufacturing process, the only name you have to remember when you're looking for a recreational vehicle is Rockwood. Rockwood offers the following additional limited warranties to the original purchasers. Consult written warranty for details.

- 1. Twelve-year vinyl roof warranty, 2. Two-year fiberglass warranty, 3. Five-year axle warranty, 4. Five-year tent warranty, 5. One-year bumper to bumper warranty, 6. Available second-year warranty



## PEACE OF MIND.

Forest River has yet another exclusive feature to offer: One year of free roadside assistance will be given to every 2010 Rockwood customer. This is just one more way to say "Thank you" and to ensure an enjoyable traveling experience.



**FOREST RIVER, INC.** 55470 C.R. 1 Elkhart, IN 46515  
574.389.4600 [www.forestriverinc.com](http://www.forestriverinc.com) [www.forestriveraccessories.com](http://www.forestriveraccessories.com)  
LITHO U.S.A FOR 0732

**YOUR ROCKWOOD DEALER**

All specifications contained herein are based on the latest product information at time of printing. Forest River reserves the right to make changes in colors, materials, equipment and specifications at any time without notice and assumes no responsibility for any errors in this brochure.