

EASY TO TOW
EASY TO GO

JAY FLIGHT
Swift

2012



JAY FLIGHT SWIFT® | TRAVEL TRAILERS BY JAYCO®

AMERICA'S MOST LIVEABLE RVs.



JAY FLIGHT SWIFT SLX | 184BH



AMERICA'S MOST LIVEABLE RVs

Liveability means making your camping experience more comfortable, in an RV you can depend on, at a price you'll feel good about. It's spending quality time together, without spending a fortune. And it's what makes Jayco America's Most Liveable RVs.

AMERICA'S FAMILY FAVORITE JUST GOT SMALLER

Say hello to the lightweight Swift and super towable Swift SLX, the newest additions to the 2012 Jayco Jay Flight series. Both travel trailers feature everything America loves about the Jay Flight, but in a smaller package. In fact, at just 2,330 pounds, the Swift SLX is light enough to be towed by most minivans, SUVs and crossovers.*

* Consult with your authorized automobile manufacturer or vehicle owner's manual.

JAY FLIGHT SWIFT SLX

Weight isn't the only reason Swift SLX is the newest lightweight dream. At 7-feet wide, it's easier to see around when towing, and at 8 ½-feet tall, it can fit into most residential garages. And at an affordable price, it'll easily fit into your budget, while giving you everything you need for comfort.

SLEEPING CAPACITY | **UP TO 5**
EXTERIOR LENGTH | **16' 6"– 20'**
UNLOADED WEIGHT | **2,330–2,740**
FLOORPLANS | **3**

JAY FLIGHT SWIFT

Swift continues Jay Flight's long tradition of putting family first, with standard amenities like a full bathroom, roof-mounted air conditioner and Concord Cherry cabinetry. Plus, with a queen-sized bed, a bunk bed arrangement, a convertible dinette and a sleeper J-Steel sofa, Swift sleeps up to nine adults.

SLEEPING CAPACITY | **UP TO 9**
EXTERIOR LENGTH | **23' 1"– 29' 1"**
UNLOADED WEIGHT | **3,925–4,565**
FLOORPLANS | **2**



JAY FLIGHT SWIFT | TRAVEL TRAILERS

EASY TO TOW
EASY TO GO



JAY FLIGHT SWIFT SLX | TRAVEL TRAILERS

NO LIMITS

You'll never have to sacrifice amenities with Jay Flight Swift SLX. While towable by most minivans, SUVs and crossovers,* Swift SLX is big on features, especially in the kitchen, where it's packed with a 2-burner range, 3 cu. ft. refrigerator and microwave oven.

* Consult with your authorized automobile manufacturer or vehicle owner's manual.



JAY FLIGHT SWIFT SLX | 184BH



JAY FLIGHT SWIFT SLX | 184BH



JAY FLIGHT SWIFT SLX | 184BH

SLEEP TIGHT

Thanks to comfy select model bunk beds, featuring sturdy construction, Swift SLX is built to be a new family favorite.

DINE OUT

With Swift SLX's inside/outside dinette table, you can enjoy family dinners outside as well. And when it's time to call it a night, you can convert it into a bed.

FRESHEN UP

Featuring a tub/shower combo with skylight and marine toilet with hand flush, Swift SLX provides all the necessities.



JAY FLIGHT SWIFT | TRAVEL TRAILERS

AFFORDABLE FUN

Jay Flight Swift offers space-saving floorplans, each packed with super affordable family-friendly features, including a modern kitchen, comfortable living area and sleeping accommodations for up to nine adults.



JAY FLIGHT SWIFT | 264BH



JAY FLIGHT SWIFT | 264BH



JAY FLIGHT SWIFT | 264BH

ROOM TO REST

Privacy included. With a separate bedroom complete with 312-coil innerspring, queen-sized mattress, privacy curtain and shirt wardrobe, you can have your own little haven.

EFFICIENT

Thanks to the Atwood appliance collection, which includes a standard water heater and furnace, plus an optional oven, you can efficiently run your RV's most important appliances.

CLEAN UP

Wash up in Swift's full-featured bathroom, complete with toilet, medicine cabinet, tub/shower combo and a bathroom exhaust fan.

JAYCO CONSTRUCTION

At Jayco, we've built a reputation for superior construction and craftsmanship. We always use top-quality materials and innovative manufacturing techniques—down to the smallest details. The result? Unmatched resale value and peace of mind in an RV that's built to handle whatever the road throws at it, while outlasting everything but your memories.



OLD WORLD CRAFTSMANSHIP

Jayco's dedicated production team includes Amish craftsmen who build with well-honed woodworking techniques passed down for generations.



THE PERFECT SIZE

Built at 7-feet wide, Swift SLX is easy to see around when towing, and at less than 8 1/2-feet tall, it's easy to fit into most residential garages.



All Jayco products are green certified. Jay Flight Swift received a gold rating through use of sustainable materials, environmentally friendly production methods and reduction of waste.



WALL CONSTRUCTION

- 1** 2" x 2" wooden studs: Creates Jay Flight's long-lasting framework
- 2** Hand-tucked and glued fiberglass insulation (R-7): Prevents insulation from sagging over time (vs. blanket-insulation technique), while helping increase insulation value near studs
- 3** Extra-wide corner seals: Prevents leaks on the corner molds, baggage and entrance doors and window seals

FLOOR CONSTRUCTION

- 4** Wall-to-wall vinyl flooring: Wipes up easily, a perfect fit for families
- 5** 5/8" decking on 2" x 3" wooden joists: Creates a solid foundation (n/a SLX)
- 6** Fiberglass insulation (R-7): Maintains interior temperatures
- 7** Full-width outriggers: Supports wall weight with 4-foot spacing (vs. 8-foot spacing) and wall-to-wall, full-width design

ROOF CONSTRUCTION

- 8** 3/8" decking on 4 1/2" arched wooden trusses: Handles the elements
- 9** Fiberglass insulation (R-7): Maintains interior temperatures
- 10** Seamless rubber roof: Features one-piece construction, ensuring better leak protection

OTHER FEATURES

- 11** Galvanized steel wheel wells (select models): Reduces heat loss through floor; prevents floor damage in case of a blown tire
- 12** Integrated A-frame: Runs through frame, preventing hitch from buckling because it isn't tack welded
- 13** Innovative, aerodynamic front profile: Eliminates angled profile, increasing towability

STANDARDS AND OPTIONS

STANDARD INTERIOR EQUIPMENT

- 1/2" plywood dinette, bed and bunk platforms (n/a SLX)
- 2-burner range with range hood and exhaust fan (SLX)
- Ball bearing drawer guides 50-lb. capacity with full-drawer extension (n/a SLX)
- Concord Cherry stained hardwood cabinet doors
- High-efficiency Atwood appliance collection (water heater and furnace) (n/a SLX)
- Glued and pocket screwed cabinetry
- Pleated shades throughout
- MaxView windows, large safety-glass windows
- Metal alloy plumbing fittings in kitchen and bath sinks
- Microwave oven (SLX)
- Multi-Media Sound System with iPod hookup
- Residential furniture, cushions and window treatments designed and made by Jayco
- Wall-mounted air conditioner (SLX)

STANDARD EXTERIOR EQUIPMENT

- 5/8" tongue-and-groove plywood flooring (n/a SLX)
- 4" cambered steel box tube frame (SLX)
- Aerodynamic front profile
- Fully decked and walkable roof
- Galvanized steel wheel wells
- Heavy-duty ABS holding tanks (n/a SLX)
- I-Class cambered structural I-beam frame (n/a SLX)
- Integrated A-frame
- Radius-cornered entrance and baggage doors
- Seamless marine-grade floor decking (SLX)
- Swift Dry Lock leak prevention system
- Tapered-crown roof construction (SLX)

OPTIONS (N/A SLX)

- Customer Value Package
- Customer Value Package with 15,000-BTU A/C
- Customer Convenience Package
- Spare tire and carrier

CUSTOMER VALUE PACKAGE (N/A SLX)

- 13,500 or 15,000-BTU A/C
- ABS tub surround
- Carefree patio awning
- Cable/satellite TV hookup
- HDTV antenna with digital tuner
- Microwave oven
- Multi-Media Premium Sound System AM/FM/CD stereo with iPod hookup
- Quilted bedspread
- Water heater bypass system

CUSTOMER CONVENIENCE PACKAGE (N/A SLX)

- 6-gal. gas/electric DSI water heater
- 6.3 cu. ft. double-door refrigerator
- High-efficiency Atwood oven
- Outside shower
- Stabilizer jacks (4)
- Tub surround

FLOORPLANS

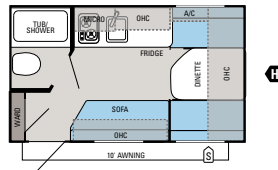

JAY FLIGHT SWIFT SLX | 145RB

Ext. Lgth: 16' 6" Ext. Ht: 101" Unloaded Wt (lbs.): 2,330 Sleeps: 2-3

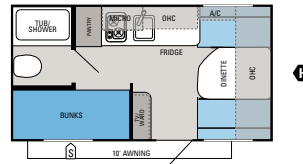

JAY FLIGHT SWIFT SLX | 154BH

Ext. Lgth: 17' 10" Ext. Ht: 99" Unloaded Wt (lbs.): 2,505 Sleeps: 3-4

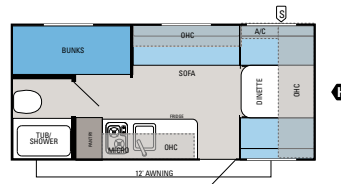

JAY FLIGHT SWIFT SLX | 184BH

Ext. Lgth: 20' Ext. Ht: 101" Unloaded Wt (lbs.): 2,740 Sleeps: 4-5

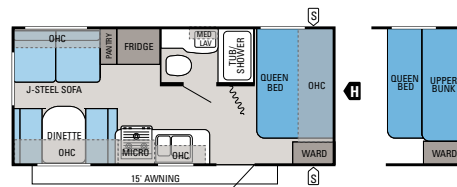

JAY FLIGHT SWIFT | 198RD

Ext. Lgth: 23' 1" Ext. Ht: 127" Unloaded Wt (lbs.): 3,925 Sleeps: 4-7

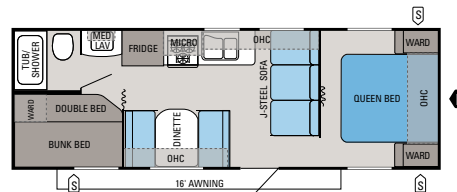

JAY FLIGHT SWIFT | 264BH

Ext. Lgth: 29' 1" Ext. Ht: 128" Unloaded Wt (lbs.): 4,565 Sleeps: 7-9

- OUTSIDE STORAGE
- TRAILER HITCH
- BATHROOM SINK
- MICROWAVE
- OVERHEAD CABINETS
- REFRIGERATOR
- WARDROBE



FOR A COMPLETE LIST OF STANDARDS AND OPTIONS, SCAN HERE WITH YOUR SMARTPHONE OR VISIT JAYCO.COM.

SPECIFICATIONS

	FLOORPLAN	EXTERIOR LENGTH	EXTERIOR WIDTH	EXTERIOR HEIGHT (WITH A/C)	INTERIOR HEIGHT	UNLOADED VEHICLE WEIGHT (LBS.)	DRY HITCH WEIGHT (LBS.)	GROSS VEHICLE WEIGHT RATING (LBS.)	CARGO CARRYING CAPACITY (LBS.)	FRESH WATER CAPACITY (GAL.) (WITH WATER HEATER)	GRAY WASTEWATER CAPACITY (GAL.)	TOILET/BLACK WASTEWATER CAPACITY (GAL.)
SWIFT	145RB	16' 6"	84"	101"	73"	2,330	245	2,950	620	16	15	9
SLX	154BH	17' 10"	84"	99"	73"	2,505	310	3,200	695	16	15	9
	184BH	20'	84"	101"	73"	2,740	295	3,500	760	26	15	9
SWIFT	198RD	23' 1"	96"	127"	81"	3,925	470	5,900	1,975	48	32.5	32.5
	264BH	29' 1"	96"	128"	81"	4,565	550	6,500	1,935	48	32.5	32.5



NOBODY OFFERS A BETTER WARRANTY THAN WE DO

YOU WANT YOUR RV TO LAST A LONG TIME.

That's why we offer our exclusive 2-year Co-Pilot Warranty, the best and most comprehensive warranty program in the industry. Every Jayco RV undergoes rigorous quality control testing before it leaves the factory, so you can be confident your new Jayco will continue to provide the ultimate in liveability and reliability for years to come.

For a copy of our 2-year limited warranty with full terms and conditions, ask your local Jayco dealer.

ROADSIDE ASSISTANCE

Travel worry-free with Jayco's Customer First Roadside Assistance program, yours at no cost during your first year of ownership. This program is offered through National Motor Club, the largest RV emergency road service in the country, and gives you immediate access to dependable roadside assistance and support services with a simple phone call.



TO LEARN MORE ABOUT OUR QUALITY CONTROL TESTING, SCAN HERE WITH YOUR SMARTPHONE.



TRUE VALUE OF OWNERSHIP



MORE STANDARD FEATURES

We pack more standard features into our RVs than anyone else. Even better, they're features we know you'll want, designed to make your RV more home-like, comfortable and convenient. Because at Jayco, it's always been about liveability.



BRAND-NAME COMPONENTS

We like living up to the name we've built for ourselves. That's why we only use dependable components in our RVs, made by companies that value their reputation as much as we do ours.



LESS MAINTENANCE

Our top-quality materials and production techniques let you spend more time enjoying your new RV and less time maintaining it.



BETTER AVERAGE RESALE VALUE

In the last three years, Jayco owners have been banking on their investments. According to the NADA, Jayco's average resale value was 4.81% higher than the competition, giving Jayco the top resale value in the RV industry.

With Jayco, you get more amenities, more liveable, home-like features and superior construction for less maintenance and greater resale value. **Simply put, you won't find another RV packed with more TRUE VALUE.**



CONVENIENT AMENITIES

Built for families, we've made sure there's enough room to accommodate yours. With **A** | a variety of bunk bed solutions, **B** | a dinette that lowers into a bed and **C** | a convertible J-Steel sofa (select models) with new residential styling, we've made your family's comfort one of our top priorities.

MODERN ELECTRONICS

Swift offers up top-notch features with **A** | its reliable Norcold refrigerator with adjustable temperature, **B** | a Multi-Media Sound System with AM/FM/CD stereo with iPod hookup and **C** | Swift SLX's air conditioner, side-mounted to increase your RV's aerodynamics when being towed.



PUTTING THE FOCUS ON CAMPING

At Jayco, we want your RV to be easy to use. And we want your RV to hold up to that use. That's where Swift's **A** | pleated shades and **B** | heavy-duty, metal alloy faucet fittings come in. Easy to use, our shades are less likely to break compared to metal blinds, while our metal fittings are more durable than typical plastic fittings, meaning the only thing you'll have to worry about in your camper is cleaning up the dishes.



LONG-LASTING QUALITY CONSTRUCTION

Known for quality construction, Jay Flight is built to hold its value years from now. Take for instance Swift's cabinetry. Featuring **A** | Amish-crafted hardwood doors with durable metal hinges, **B** | pre-drilled and screwed construction and **C** | a surplus of storage, your kitchen will stay beautifully functional.



A TRADITION OF LIVEABILITY

THE JAYCO STORY BEGAN IN 1968 when Jayco founder Lloyd Bontrager created an innovative, easy-to-use lifter system that led to a better fold-down camper. Loaded with more comforts and conveniences, Lloyd believed his camper would bring people closer together because it was more liveable. A devoted family man, Lloyd's passion extended to his business as well. In fact, our company's success stems from his insistence on treating everyone at Jayco as family — from our factory to our front office, our salespeople to our suppliers, and our customers to our community.

BLENDING OLD WORLD AMISH CRAFTSMANSHIP WITH INNOVATIVE TECHNOLOGY, Jayco is the nation's largest family-owned and operated RV manufacturer today. And while our product line has grown considerably over the years, every unit we build is still guided by Lloyd's vision and a humble desire to help make it easier for families to explore together and relax together. It's what separates us from other RV manufacturers. And it's what continues to make Jayco America's Most Liveable RVs.



AMERICA'S MOST **LIVEABLE** RVs.



Jayco proudly sponsors Tread Lightly!, a nonprofit organization whose mission is to empower generations to enjoy the outdoors responsibly through education and restoration.

Unloaded Vehicle Weight (UWV): Sometimes referred to as "Dry Weight," UWV means the typical weight of this trailer as built at the factory. The UWV, as used in product literature and other promotional materials, does not include cargo, fresh water, propane, options or dealer-installed accessories.

Gross Vehicle Weight Rating (GVWR): GVWR means the maximum permissible weight of the trailer, including the UWV plus passengers, personal items, all cargo, fluids, options, and dealer-installed accessories. The GVWR is equal to or greater than the sum of the UWV and the CCC.



From RV insurance to extended warranties, JayPlus has it covered. Ask your Jayco dealer about our exclusive JayPlus program today.

Cargo Carrying Capacity (CCC): CCC means the maximum weight of all passengers, personal items, food, fresh water, propane, tools, other cargo and dealer-installed accessories that can be carried by the trailer. CCC is equal to or less than GVWR minus UWV. The addition of options will decrease the CCC.

Hitch Weight (HW): The hitch weight, as used in product literature and other promotional materials, does not include cargo, fresh water, propane gas, options or dealer-installed accessories. The addition of these types of items will either add to or subtract from the stated hitch weight.



As a Jayco owner, you can be part of the Jayco Jafari International Travel Club. Ask your dealer about the Jafari "flight" in your area, write Jayco or visit our website.

It is important for your safety and enjoyment that your tow vehicle be adequately sized and equipped to tow and handle the GVWR of the RV you select. Review weights and rating of your tow vehicle and consult a competent advisor for questions or advice. Whether you are new to RVing or a veteran, get a feel for the performance of your tow vehicle before heading out on the roadways. When you tow an RV, you must drive differently than when you drive a single vehicle. Practice hooking up, driving, backing up and braking in a safe environment or seek out professional instruction. Jayco affixes a weight label to each RV which lists weight information for that vehicle. See specifications chart inside.

Jayco, Inc., P.O. Box 460, Middlebury, IN 46540, www.jayco.com 

See dealer for further information and prices. All information in this brochure is the latest available at the time of publication approval. Jayco reserves the right to make changes and to discontinue models without notice or obligation. Photos in this brochure may show optional equipment and props for photography purposes. RVs built for sale in Canada may differ to conform to Canadian codes. ©2011 Jayco, Inc. 12-JFSW-PL 0711-100K Printed in U.S.A.