

SUPER LITE SUPER TOWABLE

EAGLE

Super Lite

2012



EAGLE SUPER LITE® | TRAVEL TRAILERS AND FIFTH WHEELS BY JAYCO®

AMERICA'S MOST LIVEABLE RV'S.



EAGLE SUPER LITE HT FW 26.5RKS | AMBER



AMERICA'S MOST LIVEABLE RVs

Liveability means making your camping experience more comfortable, in an RV you can depend on, at a price you'll feel good about. It's spending quality time together, without spending a fortune. And it's what makes Jayco America's Most Liveable RVs.



LIGHTWEIGHT LIVEABILITY

Break away from the ordinary without breaking the bank in a 2012 Jayco Eagle Super Lite travel trailer or fifth wheel. These super lite super stars feature many of the same high-end amenities as our popular Eagle series, while their lighter weights make for easier towing.

EAGLE SUPER LITE TRAVEL TRAILER

With multiple slideouts, spacious living areas, a private bedroom and bunk rooms (select models), you get all the perks of home in an easily towable package.

SLEEPING CAPACITY	UP TO 10
EXTERIOR LENGTH	28' 5"– 35' 5"
UNLOADED WEIGHT	5,690–7,520
FLOORPLANS	6

EAGLE SUPER LITE HALF-TON FW

Designed for today's smaller trucks, the Eagle Super Lite HT is lighter than comparable fifth wheels, while boasting convenient features, like a 26" LCD HDTV and full-body gray fiberglass exterior.

SLEEPING CAPACITY	UP TO 8
EXTERIOR LENGTH	29' 7"– 31' 5"
UNLOADED WEIGHT	6,695–6,830
FLOORPLANS	3

EAGLE SUPER LITE FIFTH WHEEL

The Eagle Super Lite fifth wheel features raised-panel cabinetry, expansive pass-through storage, name-brand appliances and a modern kitchen—all in a lightweight package.

SLEEPING CAPACITY	UP TO 10
EXTERIOR LENGTH	33' 2"– 34' 9"
UNLOADED WEIGHT	8,170–9,135
FLOORPLANS	7



EAGLE SUPER LITE

SUPER LITE
SUPER TOWABLE



EAGLE SUPER LITE TT 298RES | BROWNSTONE



EAGLE SUPER LITE TT 298RES



EAGLE SUPER LITE TT 298RES | BROWNSTONE



EAGLE SUPER LITE TT 298RES | BROWNSTONE

EAGLE SUPER LITE | TRAVEL TRAILERS



ROOM TO LIVE

Not only is the Eagle Super Lite travel trailer considerably lighter than the competition, it also comes with more standard features and amenities, including a 26" LCD HDTV, J-Steel convertible sofa, overhead cabinetry and residential-style furniture. In fact, the living areas are so well-appointed, you'll forget you're camping.

FLOORPLANS

- S OUTSIDE STORAGE
- H TRAILER HITCH
- LAV BATHROOM SINK
- MICRO MICROWAVE
- OHC OVERHEAD CABINETS
- FRIDGE REFRIGERATOR
- WARD WARDROBE

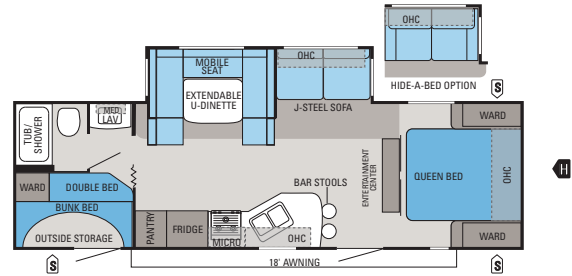
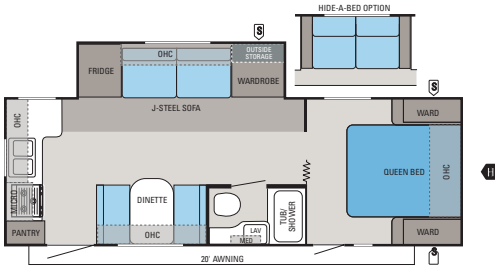

SUPER LITE TRAVEL TRAILER | 256RKS

Ext. Length: 28' 5" Ext. Height: 133" Unloaded Wt. (lbs.): 5,690 Sleeps: 6

SUPER LITE TRAVEL TRAILER | 284BHS

Ext. Length: 31' 9" Ext. Height: 132" Unloaded Wt. (lbs.): 6,365 Sleeps: 9

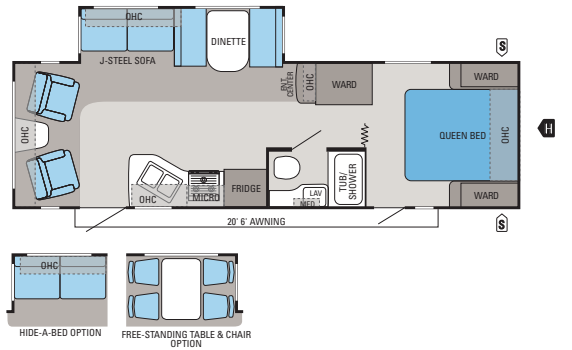
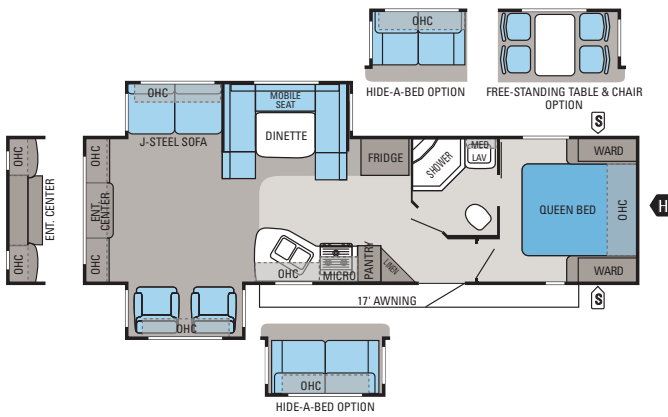

SUPER LITE TRAVEL TRAILER | 298RES

Ext. Length: 33' 11" Ext. Height: 133" Unloaded Wt. (lbs.): 7,100 Sleeps: 8

SUPER LITE TRAVEL TRAILER | 298RLS

Ext. Length: 31' 5" Ext. Height: 133" Unloaded Wt. (lbs.): 6,200 Sleeps: 6

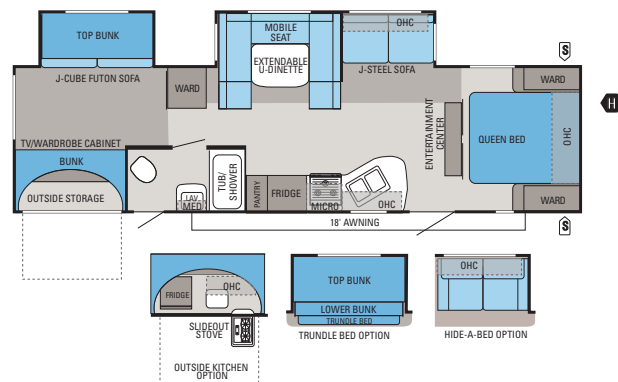
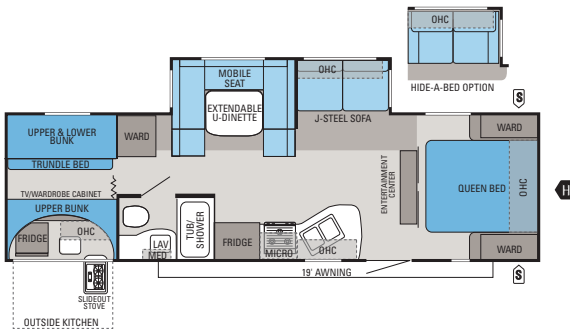

SUPER LITE TRAVEL TRAILER | 304BHK

Ext. Length: 33' 4" Ext. Height: 134" Unloaded Wt. (lbs.): 7,030 Sleeps: 10

SUPER LITE TRAVEL TRAILER | 314BDS

Ext. Length: 35' 5" Ext. Height: 133" Unloaded Wt. (lbs.): 7,520 Sleeps: 10



EAGLE SUPER LITE FW 30.5BHLT | EMERALD



EAGLE SUPER LITE FW 30.5BHLT | EMERALD



EAGLE SUPER LITE HT FW



EAGLE SUPER LITE FW 30.5BHLT | EMERALD

EAGLE SUPER LITE | FIFTH WHEELS



EAGLE SUPER LITE
HALF-TON FIFTH WHEEL

EAGLE SUPER LITE
FIFTH WHEEL

TOTAL PACKAGE

The Eagle Super Lite fifth wheels feature everything you love about its larger counterpart, but in a much lighter package. Whether you choose the half-ton or our economical Super Lite, you'll find you won't have to sacrifice space or amenities for towability.

FLOORPLANS

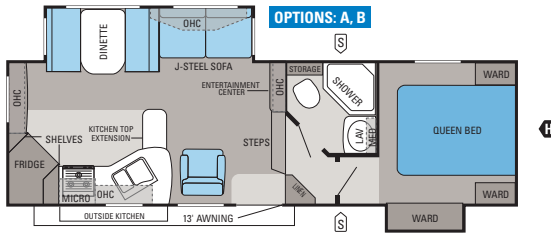

SUPER LITE HALF-TON FIFTH WHEEL | 26.5RKS

Ext. Length: 29' 11" Ext. Height: 145" Unloaded Wt. (lbs.): 6,705 Sleeps: 6

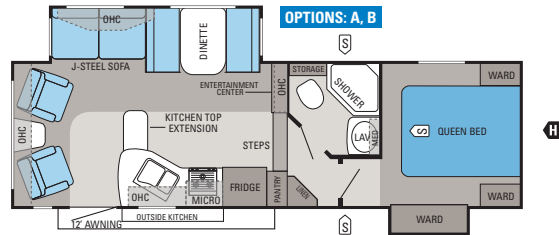

SUPER LITE HALF-TON FIFTH WHEEL | 26.5RLS

Ext. Length: 29' 7" Ext. Height: 147" Unloaded Wt. (lbs.): 6,695 Sleeps: 5

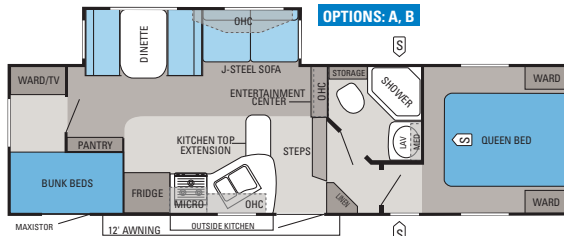

SUPER LITE HALF-TON FIFTH WHEEL | 27.5BH3

Ext. Length: 31' 5" Ext. Height: 145" Unloaded Wt. (lbs.): 6,830 Sleeps: 8

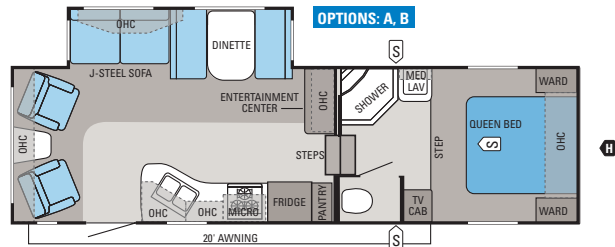

SUPER LITE FIFTH WHEEL | 28.5RLS

Ext. Length: TBD Ext. Height: TBD Unloaded Wt. (lbs.): TBD Sleeps: 6

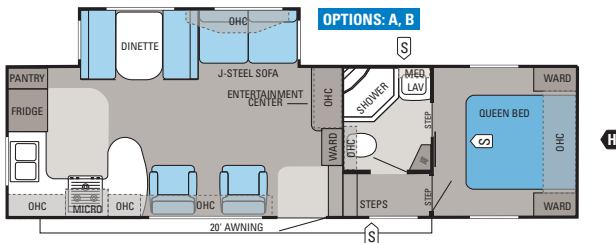

SUPER LITE FIFTH WHEEL | 29.5RKS

Ext. Length: TBD Ext. Height: TBD Unloaded Wt. (lbs.): TBD Sleeps: 6

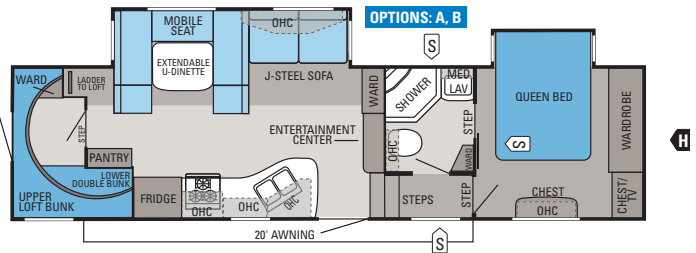

SUPER LITE FIFTH WHEEL | 30.5BHLT

Ext. Length: 34' 9" Ext. Height: 154" Unloaded Wt. (lbs.): 9,135 Sleeps: 9

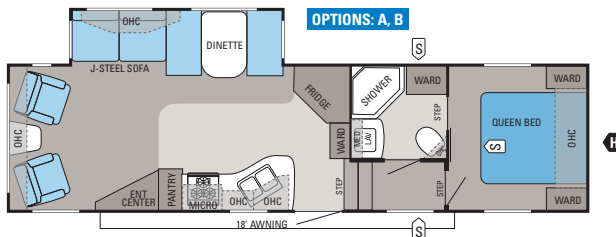

SUPER LITE FIFTH WHEEL | 30.5RLS

Ext. Length: 33' 2" Ext. Height: 152" Unloaded Wt. (lbs.): 8,170 Sleeps: 6

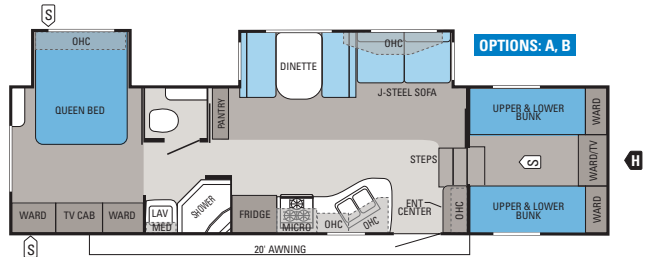

SUPER LITE FIFTH WHEEL | 31.5FBHS

Ext. Length: 34' 1" Ext. Height: 152" Unloaded Wt. (lbs.): 8,445 Sleeps: 10

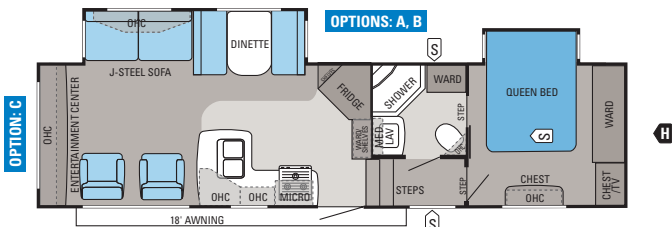

SUPER LITE FIFTH WHEEL | 31.5RLDS

Ext. Length: 34' 2" Ext. Height: 154" Unloaded Wt. (lbs.): 8,725 Sleeps: 6

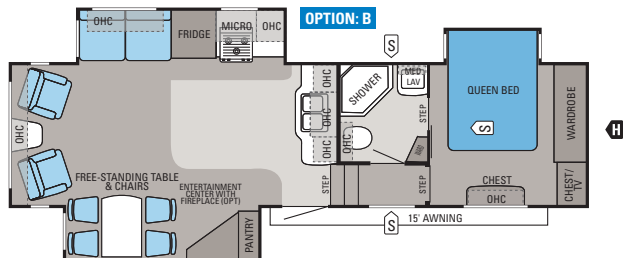

SUPER LITE FIFTH WHEEL | 31.5RLTS

Ext. Length: 33' 10" Ext. Height: 157" Unloaded Wt. (lbs.): 9,130 Sleeps: 4

OPTIONS

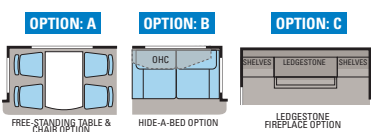

- STORAGE
- LAV BATHROOM SINK
- OHC OVERHEAD CABINETS
- TRAILER HITCH
- MICRO MICROWAVE
- FRIDGE REFRIGERATOR
- WARD WARDROBE

STANDARDS AND OPTIONS

STANDARD INTERIOR EQUIPMENT

- 3-burner range with 9,000-BTU SuperBurner and piezo igniter
- 6 cu. ft. Norcold refrigerator
- 32" LCD HDTV in living area
- 312-coil innerspring mattress
- A/C Chillgrille
- Ball bearing drawer guides 50-lb. capacity with full-drawer extension
- Cable and satellite TV prepped
- Crank-up HDTV antenna with signal booster
- Diamondflor vinyl flooring (n/a HT)
- Deep storage drawers under booth dinette (select series)
- Dream Dinette table mechanism (select models)
- Glass shower door
- Pleated night shades
- Porcelain toilet with foot flush
- Pre-drilled and screwed cabinet construction
- Raised-panel cabinet doors throughout (select series)
- Raised-panel refrigerator front
- Residential furniture, designed and made by Jayco
- Swivel rocker(s) (select models)

STANDARD EXTERIOR EQUIPMENT

- 30-amp power cord (select models)
- 30" x 72" radius-cornered main entry door
- 50-amp power cord (select models)
- Big Easy entrance step with 10" deep treads
- Black tank sprayer
- Diamond-plated panel on front (TT)
- E-Z Lube axles
- Foldable, exterior grab handle
- Frame prepped for bike rack/cargo tray (select models)
- Goodyear brand radial tires
- Heated and enclosed fresh water tank and holding tanks
- High-output marine grade exterior speakers (2)
- I-Class cambered structural steel I-beam frame

- MOR/ryde CRE 3000 axle equalizer (n/a HT)
- Outdoor media center (select series)
- Prep for outside grill
- Rain guttering, molded with extended drip spouts
- Reflective foil insulation in slideout floors and roof (R-15)
- Safety step light
- Seamless one-piece rubber floor
- Security light, door side
- Spare tire with carrier
- Stabilizer jacks (4) (TT)
- Tinted safety-glass windows
- TuffShell vacuum-bonded laminated sidewalls, slideouts, back wall and floor
- Water system winterization kit

OPTIONS

- 2nd A/C (select FW models)
- 8 cu. ft. Norcold refrigerator (n/a with Deluxe Package)
- Aluminum rims (std HT)
- Bedroom carpet (TT)
- Bike rack/cargo tray system (select models)
- Customer Value Package
- Customer Value Package with 15,000-BTU A/C
- Deluxe Package (n/a HT)
- Electric rear stabilizer jacks (HT and FW)
- Electric tongue and stabilizer jacks (TT)
- Extendable dinette (select models)
- Fireplace (select FW models)
- Free-standing table with 4 chairs (select models)
- Glacier Package (extra layer of R-11 insulation in roof and R-15 foil in main floor) (n/a HT)
- Hide-a-bed in lieu of 2 chairs (select TT models)
- Hide-a-bed with air mattress
- Keyless entry (n/a HT)
- Ledgestone fireplace (select models)
- Linoleum in living area (select models)

- MOR/ryde pin box (FW)
- Outside kitchen (select TT models)
- Portable, outside gas grill
- Reese Revolution pin box (FW)
- Roof ladder (TT)
- Satellite kit
- Thermal pane tinted safety-glass windows
- Trundle bed (select models)
- Water purification system

CUSTOMER VALUE PACKAGE (MANDATORY)

- 6-gal. gas/electric DSI auto-ignition water heater (TT)
- 30 lb. propane gas bottles (HT and FW)
- 13,500-BTU A/C with wall thermostat with louvered directional ceiling vents
- ABS propane bottle cover (TT)
- ABS tub surround
- Bathroom power vent (TT and FW)
- Bath skylight (HT and FW)
- Carefree Travel'r 12V adjustable pitch electric patio awning
- Microwave oven with carousel
- Multi-Media Premium Sound System AM/FM/CD/DVD stereo with MP3 input jack
- Outside shower (TT)
- Oversized 21" oven (TT)
- Quilted bedspread (HT and FW)
- Sink covers (2) (HT)
- Water heater bypass (HT and FW)

DELUXE PACKAGE (N/A HT)

- 8 cu. ft. Norcold refrigerator
- 16" aluminum rims
- Solid surface kitchen countertops
- Solid surface sink covers (2)
- Stonecast double-bowl kitchen sink

SPECIFICATIONS

	FLOORPLAN	EXT. LENGTH	EXT. WIDTH	EXT. HEIGHT (WITH A/C)	EXT. HEIGHT (WITH OPT. BEDROOM A/C)		UNLOADED VEHICLE WEIGHT (LBS.)	DRY HITCH WEIGHT (LBS.)	GROSS VEHICLE WEIGHT RATING (LBS.)	CARGO CARRYING CAPACITY (LBS.)	FRESH WATER CAPACITY (GAL.) (WITH WATER HEATER)	GRAY WASTEWATER CAPACITY (GAL.)	TOILET/BLACK WASTEWATER CAPACITY (GAL.)
					INT. HEIGHT	EXT. HEIGHT							
SUPER LITE TRAVEL TRAILER	256RKS	28' 5"	96"	133"	—	81"	5,690	680	7,500	1,810	36.5	65	32.5
	284BHS	31' 9"	96"	132"	—	81"	6,365	740	8,100	1,735	82	32.5	32.5
	298RES	33' 11"	96"	133"	—	81"	7,100	905	9,200	2,100	82	32.5	32.5
	298RLS	31' 5"	96"	133"	—	81"	6,200	800	7,950	1,750	36.5	32.5	32.5
	304BHK	33' 4"	96"	134"	—	81"	7,030	955	8,500	1,470	36.5	32.5	32.5
	314BDS	35' 5"	96"	133"	—	81"	7,520	950	9,250	1,730	36.5	32.5	32.5
SUPER LITE HALF-TON	26.5RKS	29' 11"	96"	145"	—	78"	6,705	1,365	9,950	3,245	48	65	32.5
	26.5RLS	29' 7"	96"	147"	—	78"	6,695	1,375	9,950	3,255	48	65	32.5
FIFTH WHEEL	27.5BHS	31' 5"	96"	145"	—	78"	6,830	1,330	9,950	3,120	48	65	32.5
SUPER LITE FIFTH WHEEL	28.5RLS	TBD	96"	TBD	—	77"	TBD	TBD	TBD	TBD	90	65	32.5
	29.5RKS	TBD	96"	TBD	—	72"	TBD	TBD	TBD	TBD	90	65	32.5
	30.5BHLT	34' 9"	96"	154"	154"	72"	9,135	1,825	11,700	2,565	92	65	32.5
	30.5RLS	33' 2"	96"	152"	—	72"	8,170	1,855	11,200	3,030	82	65	32.5
	31.5FBHS	34' 1"	96"	152"	—	67"	8,445	1,635	11,200	2,755	82	65	32.5
	31.5RLDS	34' 2"	96"	154"	154"	72"	8,725	2,020	11,700	2,975	82	65	32.5
	31.5RLTS	33' 10"	96"	157"	157"	72"	9,130	2,125	11,900	2,770	82	65	32.5

INTERIOR DÉCOR CHOICES

AMBER



BROWNSTONE



EMERALD

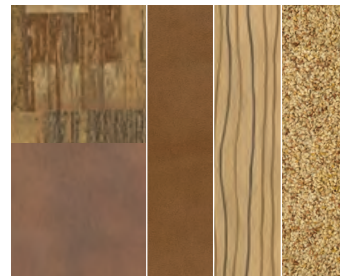

WOOD

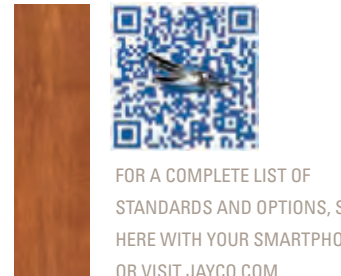

FOR A COMPLETE LIST OF STANDARDS AND OPTIONS, SCAN HERE WITH YOUR SMARTPHONE OR VISIT JAYCO.COM.

JAYCO CONSTRUCTION

At Jayco, we've built a reputation for superior construction and craftsmanship. We always use top-quality materials and innovative manufacturing techniques—down to the smallest detail. The result? Unmatched resale value and peace of mind in an RV that's built to handle whatever the road throws at it, while outlasting everything but your memories.



OLD WORLD CRAFTSMANSHIP

Jayco's dedicated production team includes Amish craftsmen who build with well-honed woodworking techniques passed down for generations.

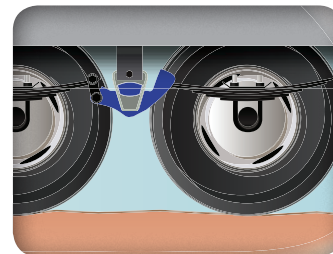

INDEPENDENT SUSPENSION

Replacing typical steel equalizers, Eagle's MOR/ryde suspension system uses rubber springs to reduce vibration and isolate road shock, helping reduce wear-and-tear (n/a HT).



All Jayco products are green certified. Eagle received a gold rating through use of sustainable materials, environmentally friendly production methods and reduction of waste.



WALL CONSTRUCTION

- 1 Vacuum-bonded sidewalls, slideouts and back wall:** Involves 15-18 minutes of 144 tons of pressure to ensure a stronger bond
- 2 Smooth fiberglass exterior:** Withstands use and travel—and Mother Nature, too
- 3 Welded aluminum frames:** Lighter than wood, increases Eagle Super Lite's towability

FLOOR CONSTRUCTION

- 4 Vacuum-bonded layers:** Backed by computer monitoring and constant quality control checks, Jayco prides itself in a solid foundation
- 5 Bead-foam insulation:** Maintains interior temperatures with an R-9 insulation value
- 6 Enclosed and heated underbelly:** Increases unit's aerodynamics while protecting undertanks

ROOF CONSTRUCTION

- 7 Seamless rubber roof:** Features one-piece construction, ensuring better leak protection
- 8 Fully decked with $\frac{3}{8}$ " plywood:** More moisture resistant, plywood holds up to the elements
- 9 Reflective foil insulation:** Boasts an R-22 insulation value (n/a HT)

FEATURES

- 10 Dexter Nev-R-Adjust brakes:** Adjusts continuously in forward motion, getting half the stopping distance compared to other brakes
- 11 WaterWorks system:** Boasts 75-plus gallons of fresh water and Pex water lines, built to weather the elements



NOBODY OFFERS A BETTER WARRANTY THAN WE DO

YOU WANT YOUR RV TO LAST A LONG TIME.

That's why we offer our exclusive 2-year Co-Pilot Warranty, the best and most comprehensive warranty program in the industry. Every Jayco RV undergoes rigorous quality control testing before it leaves the factory, so you can be confident your new Jayco will continue to provide the ultimate in liveability and reliability for years to come.

For a copy of our 2-year limited warranty with full terms and conditions, ask your local Jayco dealer.

ROADSIDE ASSISTANCE

Travel worry-free with Jayco's Customer First Roadside Assistance program, yours at no cost during your first year of ownership. This program is offered through National Motor Club, the largest RV emergency road service in the country, and gives you immediate access to dependable roadside assistance and support services with a simple phone call.



TO LEARN MORE ABOUT OUR QUALITY CONTROL TESTING, SCAN HERE WITH YOUR SMARTPHONE.



TRUE VALUE OF OWNERSHIP

↑ MORE STANDARD FEATURES

We pack more standard features into our RVs than anyone else. Even better, they're features we know you'll want, designed to make your RV more home-like, comfortable and convenient. Because at Jayco, it's always been about liveability.

↑ BRAND-NAME COMPONENTS

We like living up to the name we've built for ourselves. That's why we only use dependable components in our RVs, made by companies that value their reputation as much as we do ours.

↑ LESS MAINTENANCE

Our top-quality materials and production techniques let you spend more time enjoying your new RV and less time maintaining it.

↑ BETTER AVERAGE RESALE VALUE

In the last three years, Jayco owners have been banking on their investments. According to the NADA, Jayco's average resale value was 4.81% higher than the competition, giving Jayco the top resale value in the RV industry.

With Jayco, you get more amenities, more liveable, home-like features and superior construction for less maintenance and greater resale value. **Simply put, you won't find another RV packed with more TRUE VALUE.**

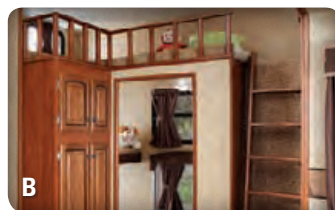

VALUABLE AMENITIES

With standard features, like **A** | a surplus of storage—inside and out—**B** | family-friendly bunk rooms (select models) and **C** | the Eagle Super Lite HT's grey-colored fiberglass exterior, you'll load up on True Value with Jayco.

ENTERTAINMENT AND ESSENTIALS

Eagle Super Lite offers up top-notch features, like **A** | an indoor 32" LCD HDTV with 180-degree viewing angle, **B** | a Norcold refrigerator with adjustable temperature and **C** | an easy push-button Carefree awning.

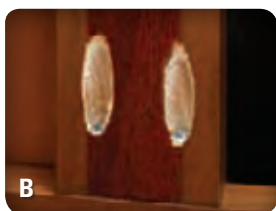

PUTTING THE FOCUS ON CAMPING

At Jayco, we don't want you fretting over your RV—today or years from now. So first, we make sure your RV is easy to use with amenities, like the Eagle Super Lite's all-new **A** | black tank flush. Then, we make sure your Jayco will stay in top shape by using only the highest-quality materials, like **B** | durable pre-drilled and screwed cabinet construction.



HOLDING ITS VALUE

Years down the road, the Eagle will still be a RVer's dream. Complete with **A** | full-extension ball bearing drawer guides, **B** | an impressive 90-degree turning radius and **C** | an optional outside kitchen (select models), Eagle Super Lite is packed with amenities that make it appealing years from now.

A TRADITION OF LIVEABILITY

THE JAYCO STORY BEGAN IN 1968 when Jayco founder Lloyd Bontrager created an innovative, easy-to-use lifter system that led to a better fold-down camper. Loaded with more comforts and conveniences, Lloyd believed his camper would bring people closer together because it was more liveable. A devoted family man, Lloyd's passion extended to his business as well. In fact, our company's success stems from his insistence on treating everyone at Jayco as family — from our factory to our front office, our salespeople to our suppliers, and our customers to our community.

BLENDING OLD WORLD AMISH CRAFTSMANSHIP WITH INNOVATIVE TECHNOLOGY, Jayco is the nation's largest family-owned and operated RV manufacturer today. And while our product line has grown considerably over the years, every unit we build is still guided by Lloyd's vision and a humble desire to help make it easier for families to explore together and relax together. It's what separates us from other RV manufacturers. And it's what continues to make Jayco America's Most Liveable RVs.



AMERICA'S MOST **LIVEABLE** RVs.



Jayco proudly sponsors Tread Lightly!, a nonprofit organization whose mission is to empower generations to enjoy the outdoors responsibly through education and restoration.

Unloaded Vehicle Weight (UVW): Sometimes referred to as "Dry Weight," UVW means the typical weight of this trailer as built at the factory. The UVW, as used in product literature and other promotional materials, does not include cargo, fresh water, propane, options or dealer-installed accessories.

Gross Vehicle Weight Rating (GVWR): GVWR means the maximum permissible weight of the trailer, including the UVW plus passengers, personal items, all cargo, fluids, options, and dealer-installed accessories. The GVWR is equal to or greater than the sum of the UVW and the CCC.



From RV insurance to extended warranties, JayPlus has it covered. Ask your Jayco dealer about our exclusive JayPlus program today.

Cargo Carrying Capacity (CCC): CCC means the maximum weight of all passengers, personal items, food, fresh water, propane, tools, other cargo and dealer-installed accessories that can be carried by the trailer. CCC is equal to or less than GVWR minus UVW. The addition of options will decrease the CCC.

Hitch Weight (HW): The hitch weight, as used in product literature and other promotional materials, does not include cargo, fresh water, propane gas, options or dealer-installed accessories. The addition of these types of items will either add to or subtract from the stated hitch weight.



As a Jayco owner, you can be part of the Jayco Jafari International Travel Club. Ask your dealer about the Jafari "flight" in your area, write Jayco or visit our website.

It is important for your safety and enjoyment that your tow vehicle be adequately sized and equipped to tow and handle the GVWR of the RV you select. Review weights and rating of your tow vehicle and consult a competent advisor for questions or advice. Whether you are new to RVing or a veteran, get a feel for the performance of your tow vehicle before heading out on the roadways. When you tow an RV, you must drive differently than when you drive a single vehicle. Practice hooking up, driving, backing up and braking in a safe environment or seek out professional instruction. Jayco affixes a weight label to each RV which lists weight information for that vehicle. See specifications chart inside.

Jayco, Inc., P.O. Box 460, Middlebury, IN 46540, www.jayco.com 

See dealer for further information and prices. All information in this brochure is the latest available at the time of publication approval. Jayco reserves the right to make changes and to discontinue models without notice or obligation. Photos in this brochure may show optional equipment and props for photography purposes. RVs built for sale in Canada may differ to conform to Canadian codes. ©2010 Jayco, Inc. 12-EGSL-PL 0611-100K Printed in U.S.A.