

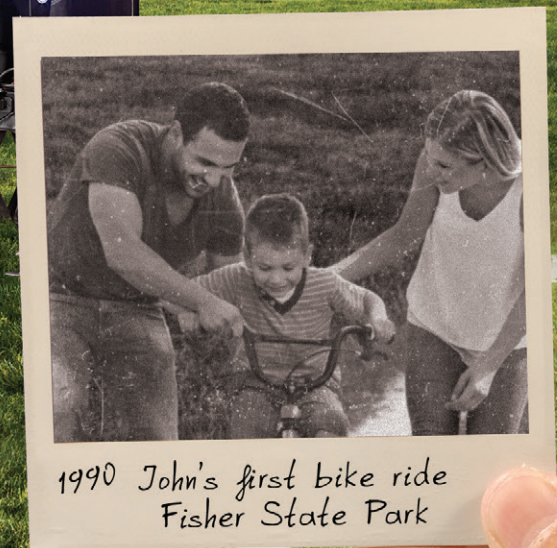

# 2019 WHITE HAWK



1990 John's first bike ride  
Fisher State Park

**2**  
**YEAR**  
LIMITED  
WARRANTY

**WHITE HAWK**



29FLS MAIN INTERIOR



29FLS BEDROOM



23MRB MURPHEY BED UP



23MRB MURPHEY BED DOWN



32BHS MAIN INTERIOR



32BHS BEDROOM CLOSET



32BHS BUNK/BATHROOM

# WHITE HAWK FLOORPLANS

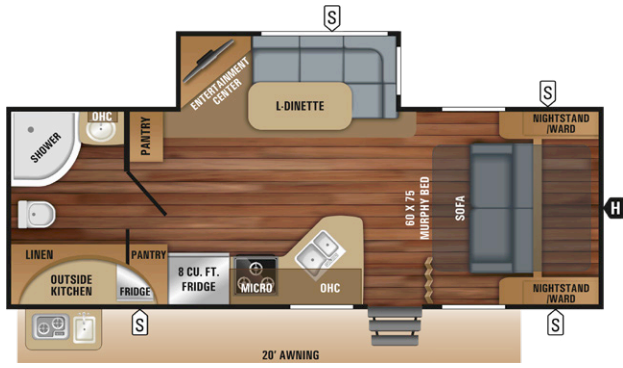

**23MRB** OPTION A

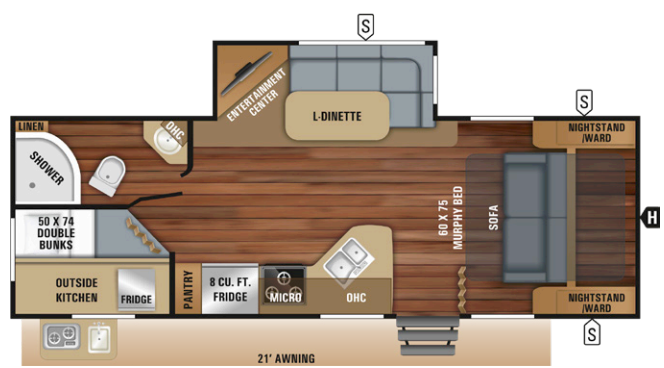

**24MBH** OPTION A

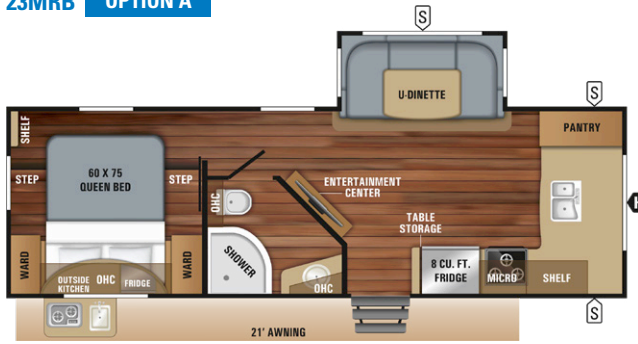

**25FK** OPTIONS: A, B

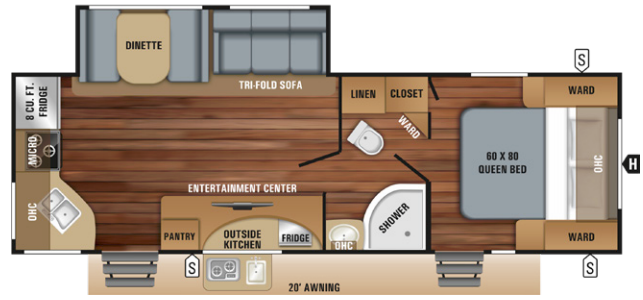

**26RK** OPTIONS: A, B

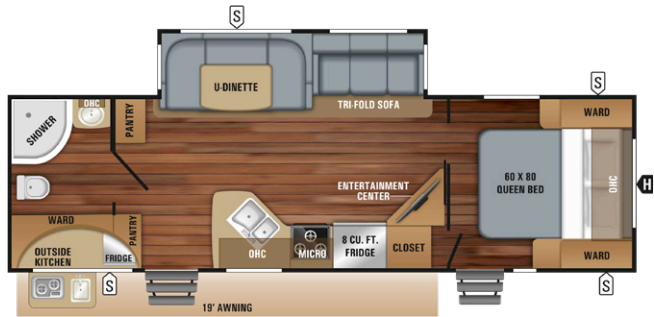

**27RB** OPTIONS: A, B

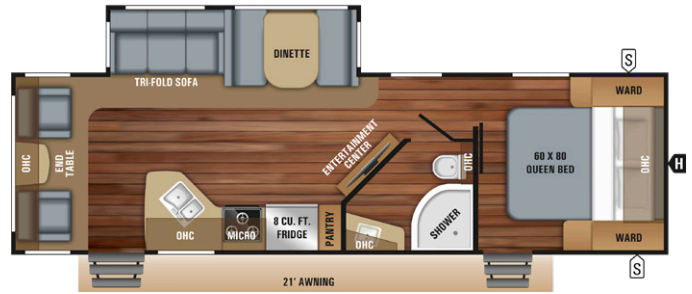

**28RL** OPTIONS: A, B

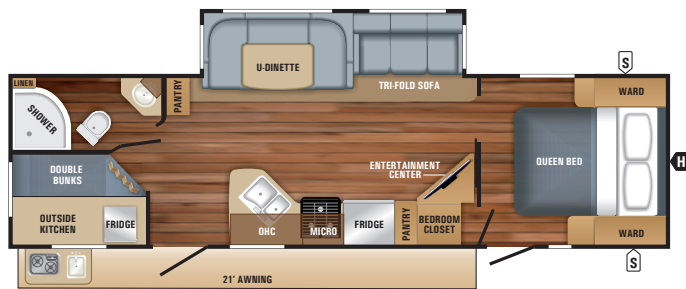

**29BH** OPTIONS: A, B

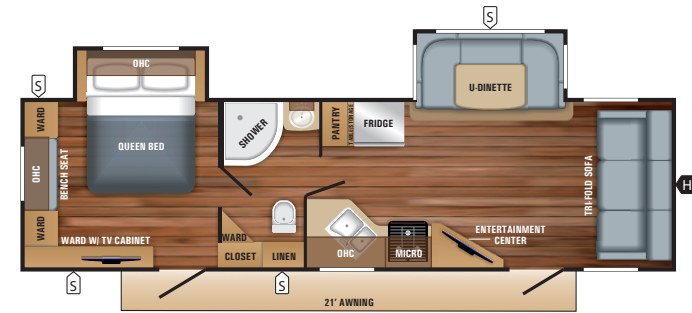

**29FLS** OPTIONS: A, B

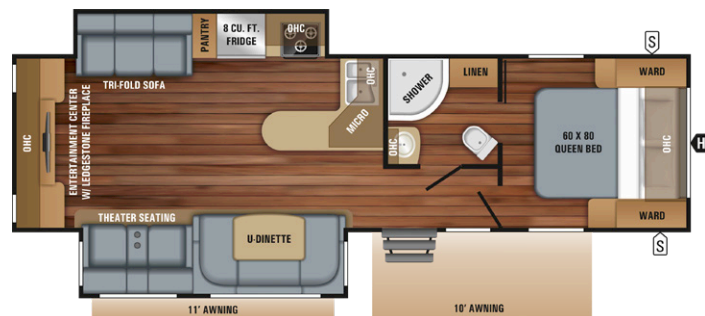

**29RE** OPTION A

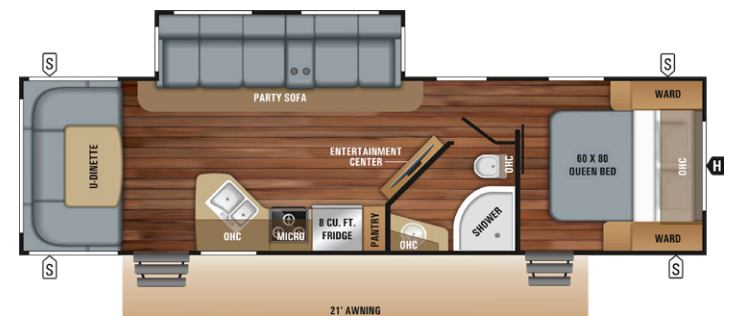

**30RD**

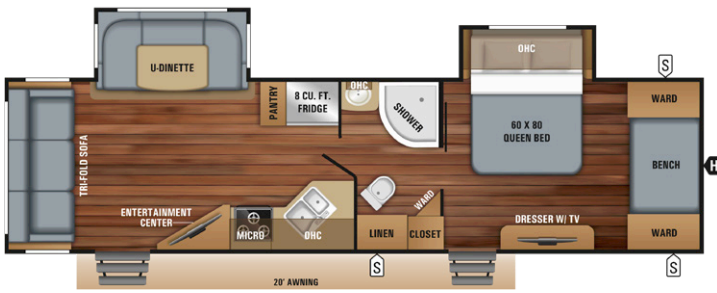

**30RLS** OPTIONS: A, B

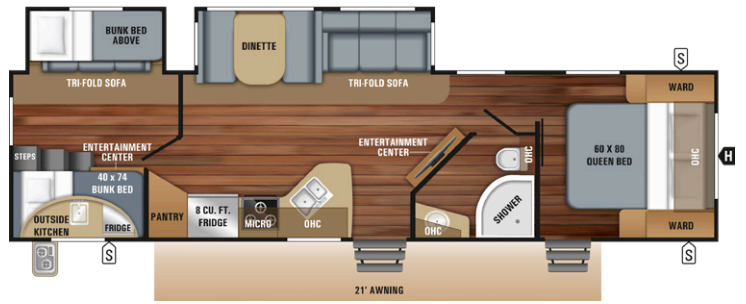

**31BH** OPTIONS: A, B

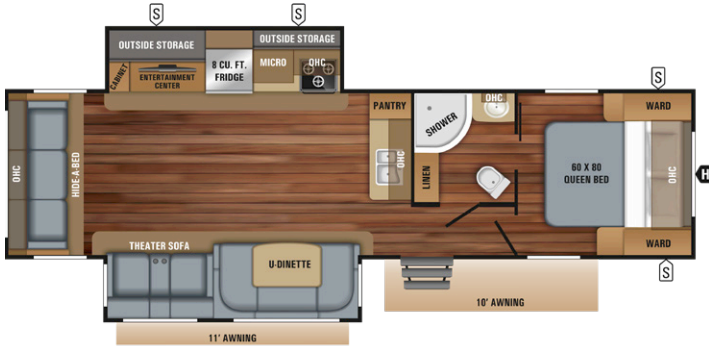

**31RL** OPTION A

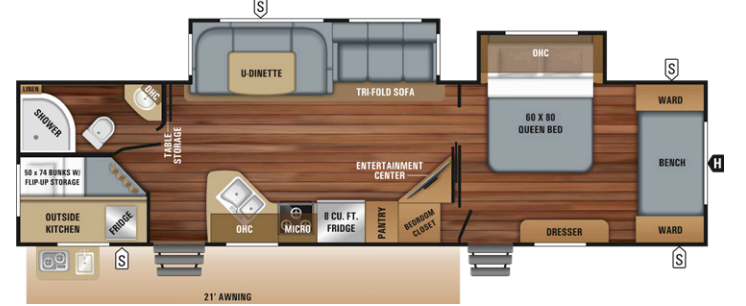

**32BHS** OPTIONS: A, B

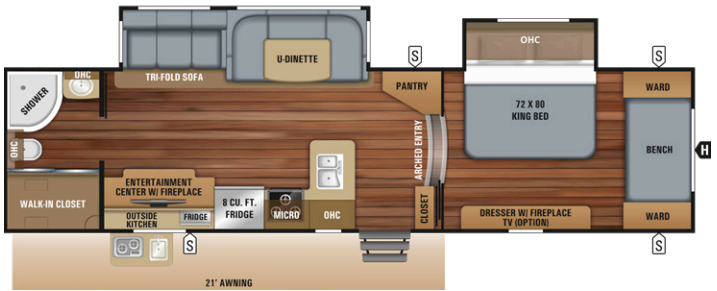

**32KBS** OPTIONS: A, B

**LEGEND**

- STORAGE
- OHC OVERHEAD CABINETS
- TRAILER HITCH
- FRIDGE REFRIGERATOR
- MICRO MICROWAVE
- WARD WARDROBE

**OPTIONS**

**OPTION A**



TABLE & CHAIRS OPTION

**OPTION B**



THEATER SOFA OPTION

**SPECS**

FLOORPLAN	EXTERIOR TRAVEL LENGTH	EXTERIOR WIDTH	EXTERIOR HEIGHT W/AC	INTERIOR HEIGHT	UNLOADED VEHICLE WEIGHT (LBS.)	DRY HITCH WEIGHT (LBS.)	GROSS VEHICLE WEIGHT RATING (LBS.)	CARGO CARRYING CAPACITY (LBS.)	FRESH WATER CAPACITY (GAL.) (INCLUDES WATER HEATER)	GREY WASTE WATER CAPACITY (GAL.)	BLACK WASTE WATER CAPACITY (GAL.)	SLEEP CAPACITY
<b>23MRB</b>	28' 2"	8' 0"	10' 11"	6' 9"	5,385	475	7,250	1,865	48	30.5	30.5	3 - 4
<b>24MBH</b>	29' 2"	8' 0"	10' 11"	6' 9"	5,625	565	7,350	1,725	48	30.5	30.5	7 - 8
<b>25FK</b>	TBD	8' 0"	TBD	6' 9"	TBD	TBD	TBD	TBD	48	TBD	30.5	3 - 4
<b>26RK</b>	31' 2"	8' 0"	10' 11"	6' 9"	6,165	780	7,750	1,585	48	61**	30.5	5 - 6
<b>27RB</b>	32' 8"	8' 0"	10' 11"	6' 9"	6,510	645	8,200	1,690	48	61**	30.5	5 - 6
<b>28RL</b>	33' 4"	8' 0"	11' 3"	6' 9"	6,475	675	8,150	1,675	48	61**	30.5	5 - 6
<b>29BH</b>	34' 7"	8' 0"	11' 3"	6' 9"	6,945	750	8,500	1,555	48	61**	30.5	9 - 10
<b>29FLS</b>	34' 6"	8' 0"	11' 3"	6' 9"	6,800	770	8,350	1,550	48	61**	30.5	5 - 6
<b>29RE</b>	35' 0"	8' 0"	11' 4"	6' 9"	7,315	795	8,950	1,635	48	30.5	30.5	5 - 6
<b>30RD</b>	35' 3"	8' 0"	11' 3"	6' 9"	6,620	790	8,500	1,880	48	61**	30.5	4 - 5
<b>30RLS</b>	36' 2"	8' 0"	11' 4"	6' 9"	7,290	850	8,750	1,460	48	30.5	30.5	5 - 6
<b>31BH</b>	37' 6"	8' 0"	11' 4"	6' 9"	7,715	790	9,500	1,785	48	61**	30.5	10 - 14
<b>31RL</b>	36' 11"	8' 0"	11' 4"	6' 9"	7,650	885	9,250	1,600	48	30.5	30.5	5 - 6
<b>32BHS</b>	37' 10"	8' 0"	11' 4"	6' 9"	7,575	810	8,995	1,420	48	61**	30.5	9 - 10
<b>32KBS</b>	TBD	8' 0"	TBD	6' 9"	TBD	TBD	TBD	TBD	48	TBD	30.5	5 - 6

\*Split tanks

**Unloaded Vehicle Weight (UVW):** Sometimes referred to as "Dry Weight," UVW means the typical weight of this trailer as built at the factory. The UVW, as used in product literature and other promotional materials, does not include cargo, fresh water, propane, options or dealer-installed accessories.

**Gross Vehicle Weight Rating (GVWR):** GVWR means the maximum permissible weight of the trailer, including the UVW plus personal items, all cargo, fluids, options and dealer-installed accessories. The GVWR is equal to or greater than the sum of the UVW and the CCC.

**Cargo Carrying Capacity (CCC):** CCC means the maximum weight of personal items, food, fresh water, propane, tools, other cargo and dealer-installed accessories that can be carried by the trailer. CCC is equal to or less than GVWR minus UVW. The addition of options will decrease the CCC.

**Hitch Weight (HW):** The hitch weight, as used in product literature and other promotional materials, does not include cargo, fresh water, propane gas, options or dealer-installed accessories. The addition of these types of items will either add to or subtract from the stated hitch weight.

It is important for your safety and enjoyment that your tow vehicle be adequately sized and equipped to tow and handle the GVWR of the RV you select. Review weights and rating of your tow vehicle and consult a competent advisor for questions or advice. Whether you are new to RVing or a veteran, get a feel for the performance of your tow vehicle before heading out on the roadways. When you tow an RV, you must drive differently than when you drive a single vehicle. Practice hooking up, driving, backing up and braking in a safe environment or seek out professional instruction. Jayco affixes a weight label to each RV which lists weight information for that vehicle. See specifications chart above.

## STANDARDS AND OPTIONS

### STANDARD EXTERIOR EQUIPMENT

Aerodynamic, rounded front profile with front diamond plate  
 Stronghold VBL™ vacuum-bonded, laminated side, rear and front walls (including slideout room walls)  
 Magnum Truss™ Roof System with seamless DiFlex II material  
 5/8 inch tongue and groove plywood decked flooring  
 Norco® NextGen frame with integrated A-frame  
 G-20 dark tinted safety-glass windows  
 30 inch friction hinged main entry doors (most models)  
 Swing out grab handle  
 Exterior TV bracket with 110V and cable outlets  
 Outdoor Camp Kitchen with embossed metal countertops (select models)  
 Slam latches on front pass-through storage doors (select models)  
 Marine-grade exterior speakers (2)  
 American-made Dexter® axles with EZ Lube®  
 Galvanized steel, impact-resistance wheel wells  
 Slide out rooms with double seals, barrier sponges and U-channel drip spouts  
 30 amp service  
 Stabilizer jacks with sand pads (4)  
 Furrion® mounted camera bracket for pre-wired rear back-up prep  
 Keyed Alike™ lock system  
 Detachable power cord  
 Exterior LED lighting  
 A-Frame mounted solar prep

### STANDARD INTERIOR EQUIPMENT

Solid hardwood, jointed cabinets with screwed and glued lumbercore cabinet stiles  
 Overhead cabinetry with smoked glass inserts  
 Deep, split bowl, stainless steel sink with high rise, pullout faucet and dry rack/sink cover combo  
 3 burner 9,000-BTU range  
 Decorative backsplash  
 Ball-bearing drawer glides with 75 lb. capacity  
 Arched interior ceiling  
 LED lighting throughout  
 Directional and closeable central air conditioner vents  
 AM/FM/CD/DVD/Bluetooth® stereo with speakers  
 Plywood dinette, bunk and bed bases  
 Woodgrain accent paneling on select interior walls  
 60 inch x 80 inch queen beds (60 inch x 75 inch in 23MRB, 24BHM, and 25FK)  
 Jayco exclusive Simmons® mattress with bedspread (N/A 23MRB and 24BHM)  
 Murphy bed design allowing pass-through exterior storage access (select models)  
 Full height hanging wardrobes with adjustable shelves  
 Solid wood door enclosures for master bedroom (N/A Murphy bed models)  
 Full bedroom closet (27RB, 29BH, 32BHS)  
 Fixed bunks with 110V outlet and corner shelf  
 Jayco exclusive teddy bear "Soft-Touch" bunk mats (bunk models only)  
 Bathroom medicine cabinets  
 14 inch x 14 inch powered roof vents in bathroom and main bedroom  
 Residential vinyl plank flooring with cold crack resistance  
 High output auto ignition furnace with wall thermostat  
 Stainless steel appliances with upgraded cooktop burner  
 2'x4' folding picnic table (N/A 29FLS, 30RLS, 32KBS)

### CUSTOMER VALUE PACKAGE (MANDATORY)

American-made nitro-filled Goodyear® radial tires  
 Self-adjusting electric brakes  
 Solar prep (roof mounted)  
 8 cu. ft. refrigerator with stainless front panels  
 Porcelain foot flush toilet  
 34 inch radius showers with solid enclosure  
 40 inch LED TV (N/A on 32KBS)  
 50 inch LED TV (32KBS Only)  
 Black tank flush  
 Roof ladder  
 13,500 BTU air conditioner  
 Spare tire with cover  
 Stainless steel microwave  
 6 gallon gas/electric auto ignition water heater  
 ABS propane bottle cover  
 30 lb. propane bottles (2)  
 Bath skylight  
 Outside shower  
 Oven  
 Aluminum rims  
 Power awning with LED light  
 Power tongue jack  
 Detachable power cord

### 50TH ANNIVERSARY PACKAGE (MANDATORY)

Enclosed underbelly with glacier package  
 Kitchen skylight with shade  
 Front molded fiberglass cap with automotive-style windshield and blue LED accent lighting  
 Frameless windows  
 Aluminum tread entry steps  
 Solid-surface kitchen countertops

### OPTIONS

Customer Value Package (MANDATORY)  
 Customer Value Package with 15,000 BTU air conditioner  
 Freestanding table with 4 chairs in place of booth dinette (select models)  
 Theater seating with heat, massage, and LED lighting (select models)  
 2nd 13,500 BTU A/C (requires 50 amp service)  
 30 amp electric fireplace  
 50 amp service with 2nd A/C prep (required with 2nd A/C)  
 Power stabilizer jacks  
 Outside bumper-mount grill  
 Fan-Tastic Fan power roof vent (location varies by model)  
 Norco stabilizing system with 4 power jacks, 2 lock arms, and power tongue jack with stabjack controls

## INTERIOR DÉCOR

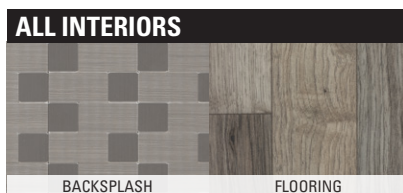
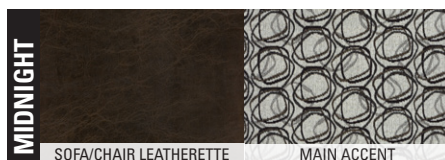
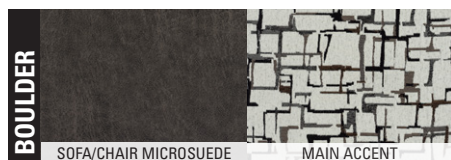

# WHITE HAWK COMPETITIVE ADVANTAGES



8 CU. FT. REFRIDGERATOR



40" LED TV (50" IN 32KBS)



34 INCH RADIUS SHOWER WITH SOLID ENCLOSURE



FRONT FIBERGLASS CAP WITH AUTOMOTIVE-STYLE WINDSHIELD AND BLUE LED LIGHTING



FRAMELESS WINDOWS



ALUMINUM TREAD STEPS



EMBOSSED METAL OUTSIDE KITCHEN COUNTERTOPS



SOLID-SURFACE COUNTERTOPS WITH UNDERMOUNT SINK



KITCHEN SKYLIGHT WITH SHADE



AMERICAN-MADE DEXTER AXLES WITH SELF-ADJUSTING BRAKES AND GALVANIZED WHEEL WELLS

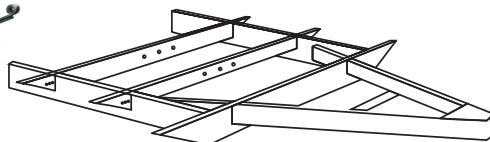

AMERICAN-MADE NORCO NEXT-GEN FRAME WITH INTEGRATED A-FRAME

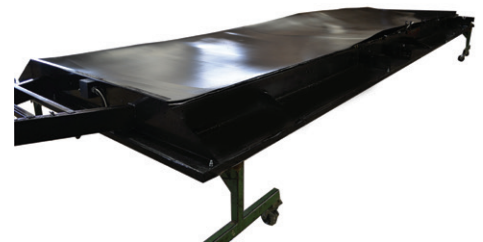

ENCLOSED UNDERBELLY WITH GLACIER PACKAGE

# Is your tow vehicle WHITE HAWK ready?



Scan to learn more

**2**  
YEAR  
WARRANTY

## TRAVEL WITH CONFIDENCE

At Jayco, we build our RVs to handle every adventure, then back them with our industry-leading 2-year limited warranty. We, with support from our select partners, have you covered for **2 camping seasons**. That's **730 days**. You won't find a better warranty in the business, because the only strings we attach are those that deliver the ultimate in reliability. That's the Jayco difference. So go explore. For a copy of our 2-year limited warranty with complete terms and conditions, please contact your local Jayco dealer.



### JAYCO'S ROOF vs. OTHER ROOFS



4,500 POUNDS ON A JAYCO ROOF VS. OTHER ROOFS

## THE MAGNUM TRUSS™ ROOF SYSTEM 50 percent stronger

**GOODYEAR**

Featuring Durawall® Technology—ENGINEERED  
to help you tow with confidence



MADE IN USA



Jayco, Inc. | P.O. Box 460 | Middlebury, IN 46540 ☎ RVIA

See dealer for further information and prices. All information in this brochure and on [www.jayco.com](http://www.jayco.com) is the latest available at the time of publication approval. Jayco reserves the right to make changes and to discontinue models without notice or obligation. Photography may show optional equipment or props used for decoration purposes only. RVs built for sale in Canada may differ to conform to Canadian codes. JAYCO and the JAYCO BIRD IN FLIGHT are registered trademarks of Jayco, Inc. Printed in USA 75K 7/2018 ©2018 Jayco, Inc. 274876

Follow Jayco  
#Jayco50



Meet your Jayco Dealer \_\_\_\_\_

We work hard—so you can play hard. From finding the perfect Jayco for your family to providing flexible financing options and full-service support, we're here to help.