

TOY HAULERS  
[keystonerv.com/impact](http://keystonerv.com/impact)

FUZION

# IMPACT

EDITION



**Keystone RV  
Company**

The ultimate  
ownership experience.



# The ultimate ownership experience.

The goal of Keystone RV Company is to surprise and delight our owners at each and every touchpoint. We're happy when our campers are happy, and we are committed to providing the very best ownership experience in the industry.



## 1 EASIER SHOPPING.

At Keystone, we make choosing an RV as easy as finding the Big Dipper on a dark summer night. With comprehensive online product information, Key Connect™ product advisors, and an unparalleled dealer network, we will help you select the perfect RV for your family's adventure.

## 2 INNOVATIVE THINKING.

The road's a nicer place when you have the industry's smartest features behind you. Keystone leads the pack in patented innovations that make our RVs safer, more comfortable, and easier to operate.

## 3 LONG HAUL QUALITY.

To keep you on the road, there are certain things we just won't build a Keystone RV without. Game-changing features like our Unified Wiring Standard, Tru-Fit™ five-point slide construction, and no-fail Tuf-Lok™ A/C duct joiners combined with exhaustive testing and inspections are some of the reasons why Keystone is able to offer our owners the industry's best 3-year limited structural warranty.

## 4 WORRY-FREE CUSTOMER SERVICE.

Wherever the road takes you, you're never too far from an authorized Keystone service center. We also offer live service assistance, ultra-fast parts shipping, online maintenance tips and tricks, and a single-point warranty claims policy. *That's* peace of mind.

## 5 KEYSTONE NATION.

When you choose Keystone, you become a part of one of the largest camping families in the country. We're Keystone Nation. A friendly community where people share photos, travel tips and amazing stories – all in the spirit of camaraderie and adventure. Come join us.

Experience the Impact lifestyle by visiting [#keystoneimpact](https://www.impactlifestyle.com)





# IMPACT

WORK HARD, PLAY HARDER



FIFTH WHEELS | TRAVEL TRAILERS

It's where you play that matters most.

Get ready to gear-up with Keystone RV's Impact edition toy haulers. Impact offers weekend warriors a lineup of shorter toy haulers, lightweight travel trailers, and fifth wheels—all with the same robust construction as the brand's big brother, Keystone's Fuzion. Focused on providing the most value for your dollar, Impact makes it easy for you to get out and play.

For more information, please visit [keystonerv.com/impact](http://keystonerv.com/impact)





# Keystone EXCLUSIVE Innovations

Year after year, Keystone RV's experienced team delivers Built For the Long Haul quality you expect and exclusive innovations you won't find anywhere else.



## 3-year Limited Structural Warranty, 1-year Limited Base Warranty

Every new Keystone RV comes with the industry's best three-year limited structural warranty AND a one-year limited base warranty. Ask your dealer, visit [keystonerv.com](http://keystonerv.com), or call Keystone owner relations for details.



## KeyTV™

Game-changing single-point control of over-the-air, cable and satellite feeds.



## Color-Coded Wiring

Easy-to-trace circuits simplify electrical and entertainment system troubleshooting.



## 4G LTE and Wi-Fi Prep

All units are equipped with a new antenna that integrates 4G LTE and Wi-Fi with standard VHF/UHF/AM/FM reception.



## In-Floor Heating Ducts

Ducting allows for more airflow that distributes heat evenly for optimal comfort.

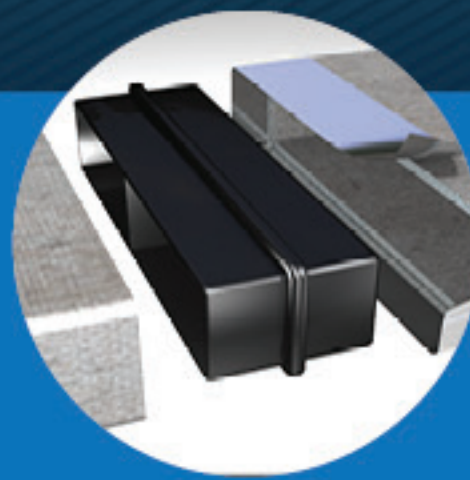

## Tuf-Lok™ A/C Duct Joiners

Crush resistant design securely joins A/C ductwork, drastically reducing chilled-air leaks and boosting cooling efficiency and comfort.



## Tru-fit™ slide Construction

A more durable slide room design that minimizes functional motor and structural stress, resists leaking.



## Power Performance

Innovative tech and robust construction that allows your Impact to play harder than the competition.

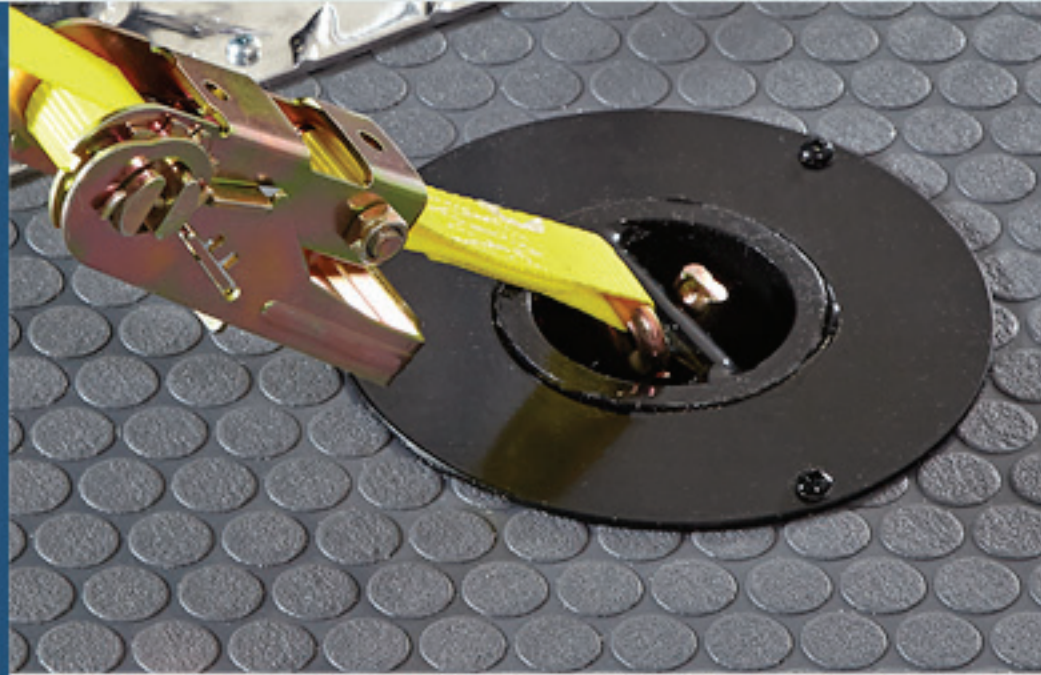

### 5K Interlock Tie-Down System

Industry-leading 5,000 lb. capacity frame-welded tie-downs for increased safety & security.



### G-Rated Tires on Fifth Wheel Trailers

Tow your toys confidently with higher ply, heavy duty tires.



### Gen. Prep with 30-Gallon Fuel Station

Built-in fueling for more hours of play.



### Dexter Axles w/ Electric Self Adjusting Brakes

Equipped with U.S. made, heavy-duty axles, and electric self-adjusting brakes that significantly decrease stopping distance and cause less wear and tear on your tow vehicle.



### No Carpet in Bedroom

More durable and easier to maintain.



### 8' Ramp Door

Lower pitch for a better load angle.



### LED TV w/ DVD and 3-Zone Stereo

Have total control of your entertainment.



### CNC Precision-Routed Sidewalls

Keystone's CNC routing process ensures perfectly cut / perfectly fit windows, doors, and slide-boxes.

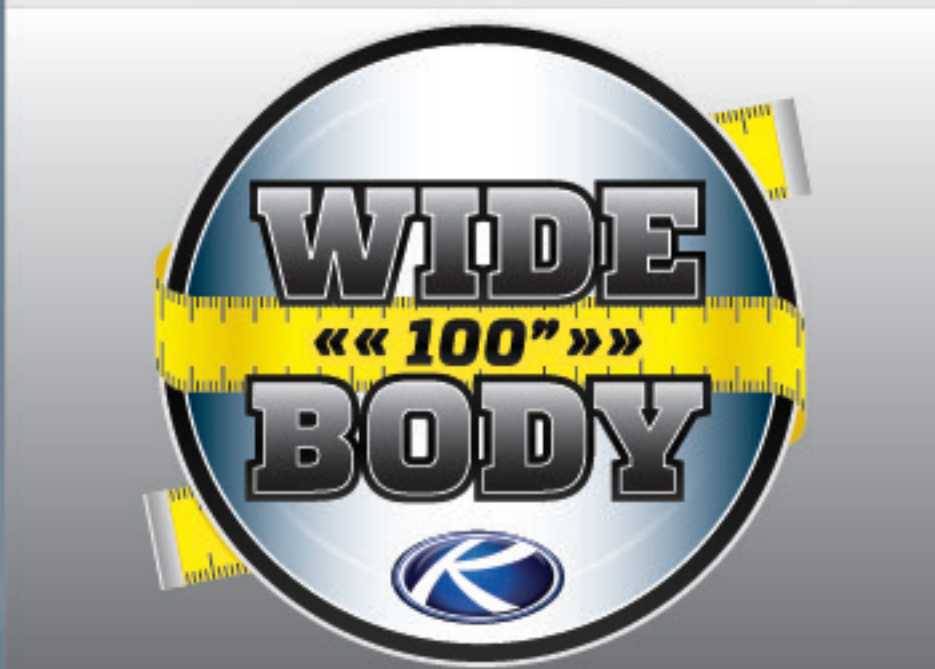

### 100" Wide Body Construction

Added width provides more carrying capacity for large toys.



### Oversized Refrigerators

Keep more food on hand with 8 cu. ft. of refrigerator and freezer storage in most units, and 12 cu. ft. in 343, 367 and 415 floorplans.

## Ultimate Convenience

Do more. Store more. Travel often. Impact's many impressive features provide maximized accessibility.





**317** | NEW TOY BOX, TANDEM-AXLE, TWO SLIDES, 11' GARAGE | Weight: 9670 LBS. | Length: 37' 6"

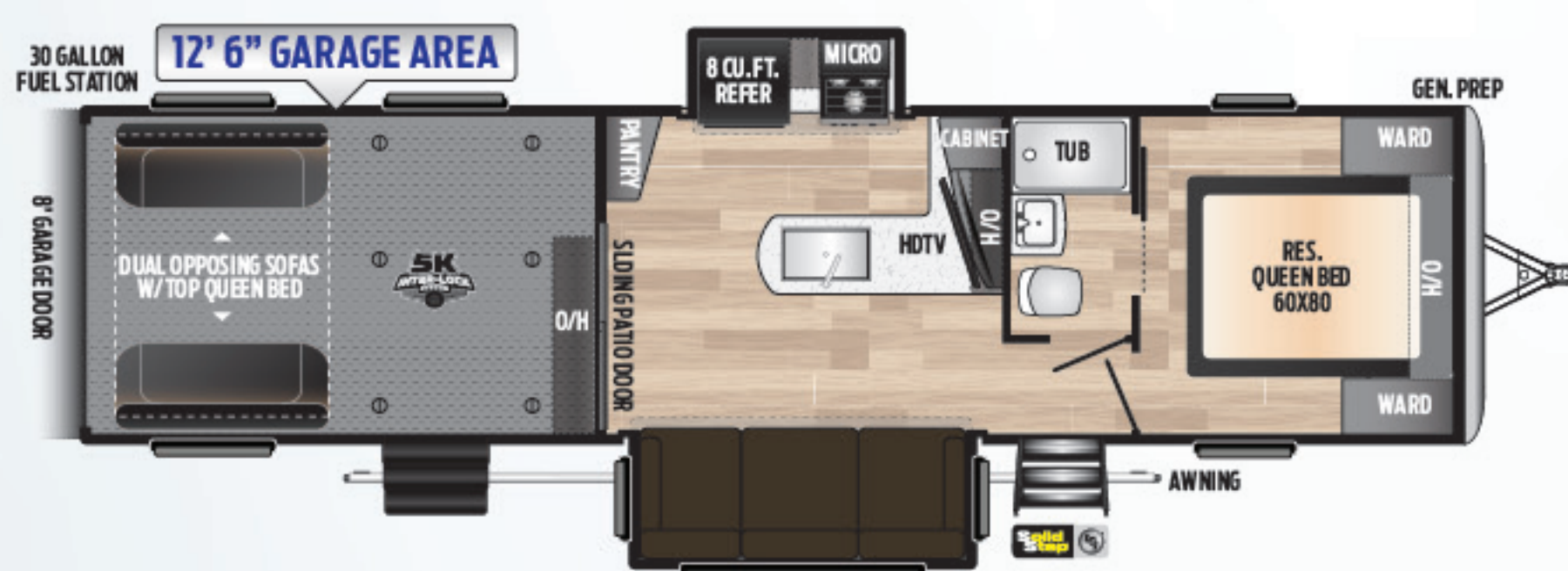

**330** | TANDEM-AXLE, TWO SLIDES, 12' 6" GARAGE | Weight: 9454 LBS. | Length: 37' 6"

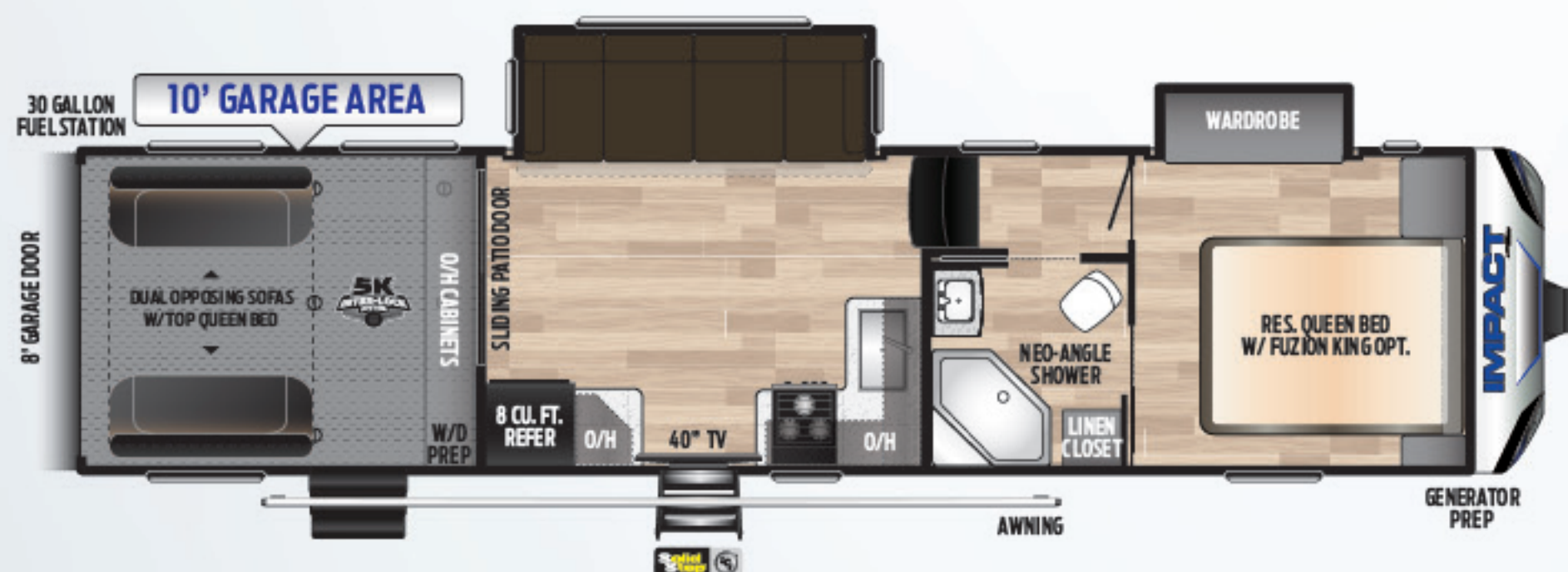

**311** | TANDEM-AXLE, TWO SLIDES, 10' GARAGE | Weight: 11447 LBS. | Length: 35' 7"

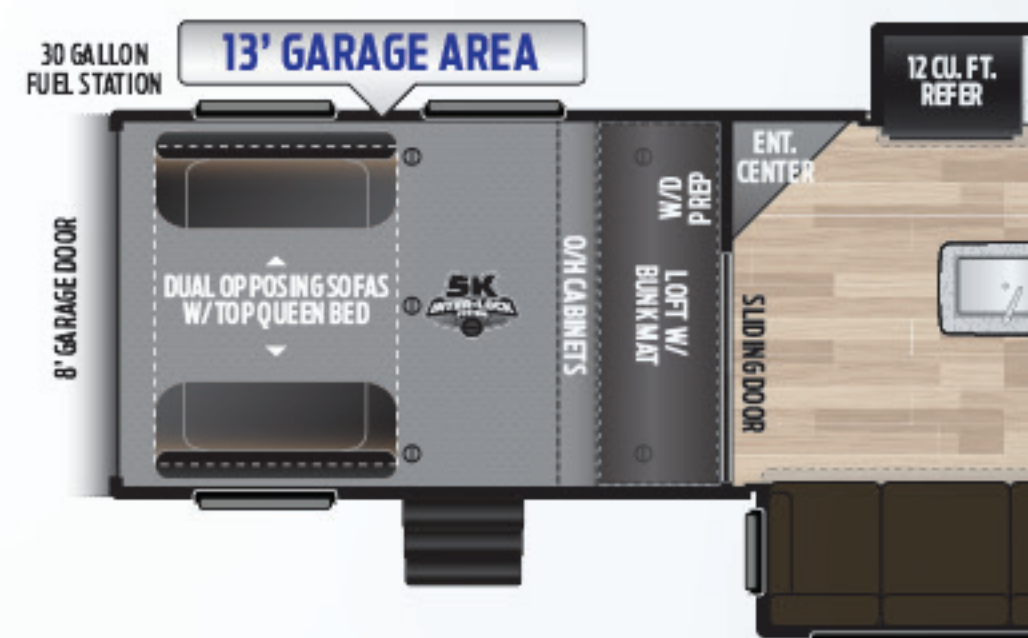

**343** | TANDEM-AXLE, THREE SLIDES, 13' GARAGE

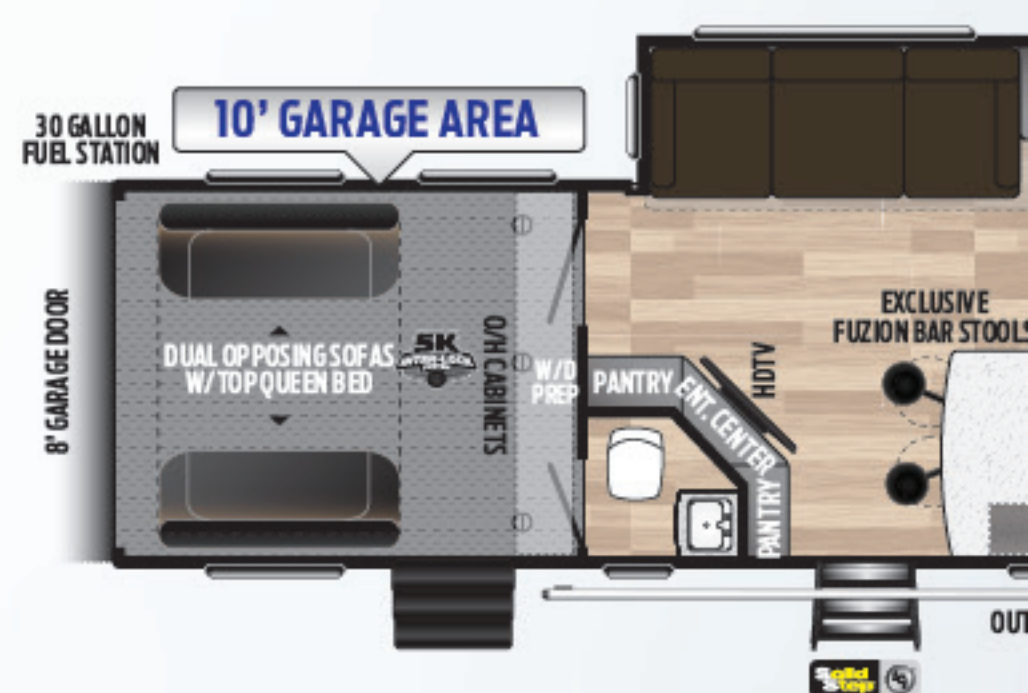

**359** | TANDEM-AXLE, 1 1/2 BATH, 10' GARAGE

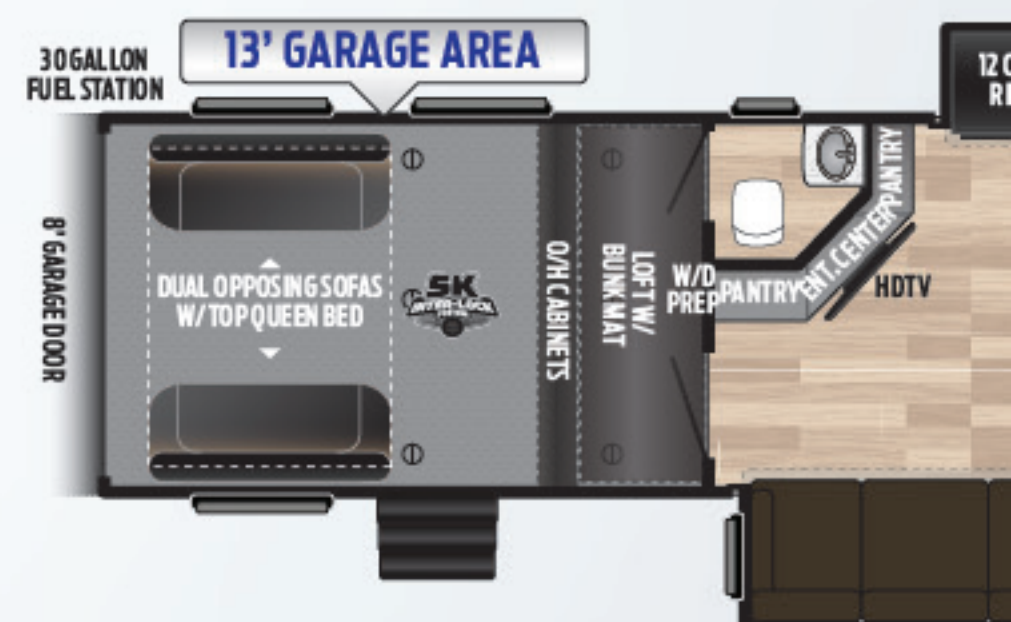

**367** | TANDEM-AXLE, 1 1/2 BATH, 13' GARAGE

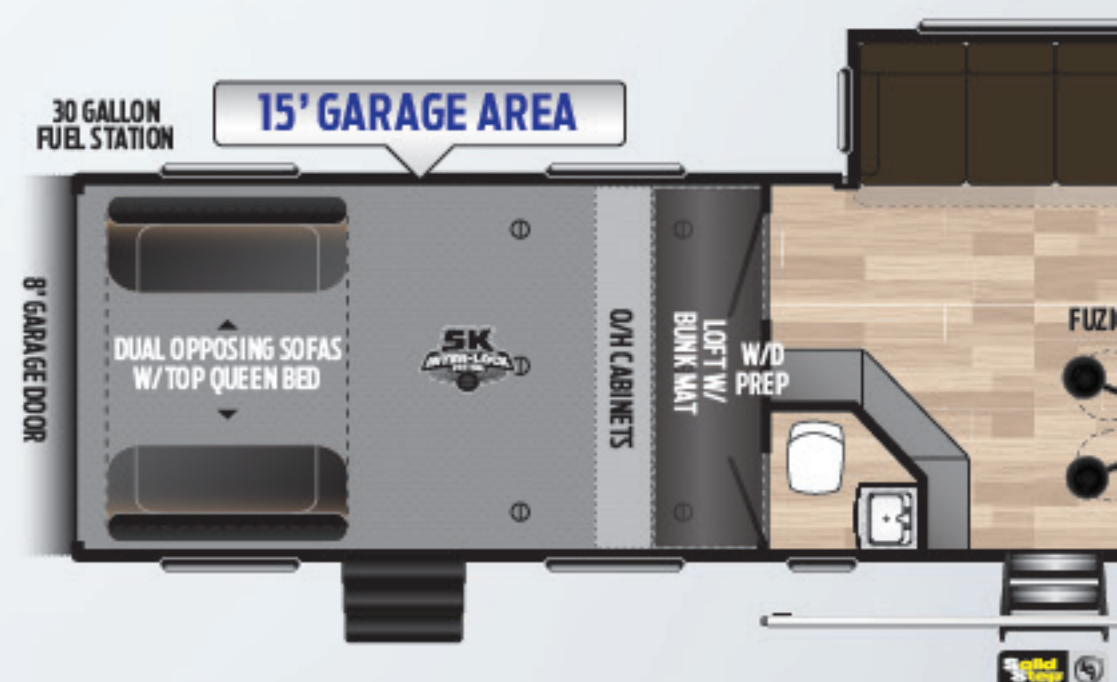

**NEW! 415** | TRIPLE-AXLE, 15' GARAGE, 12 CU. FT. REFER



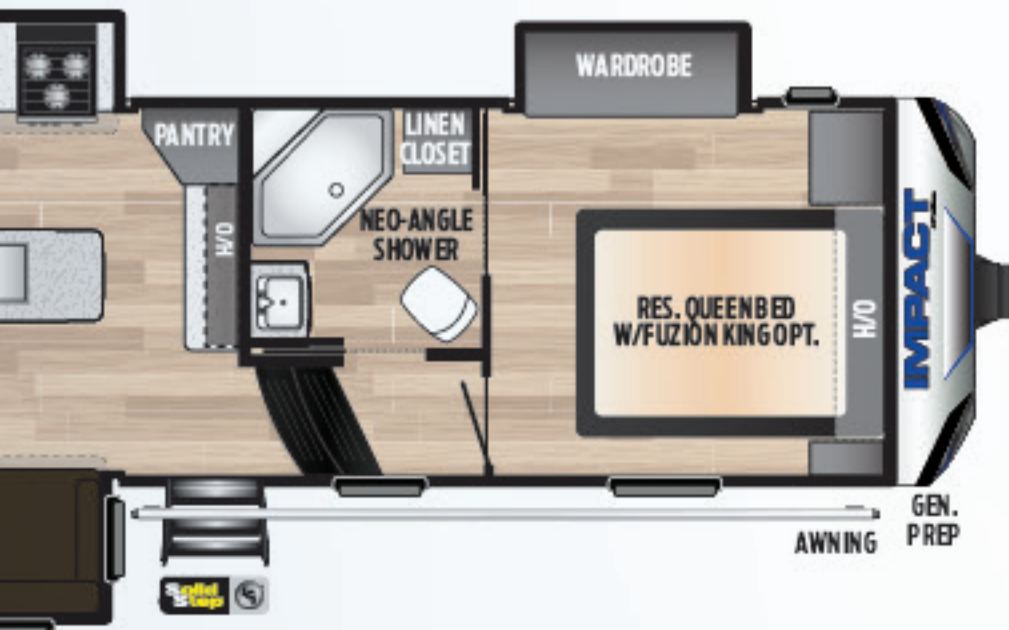

GARAGE | Weight: 12312 LBS. | Length: 39' 0"

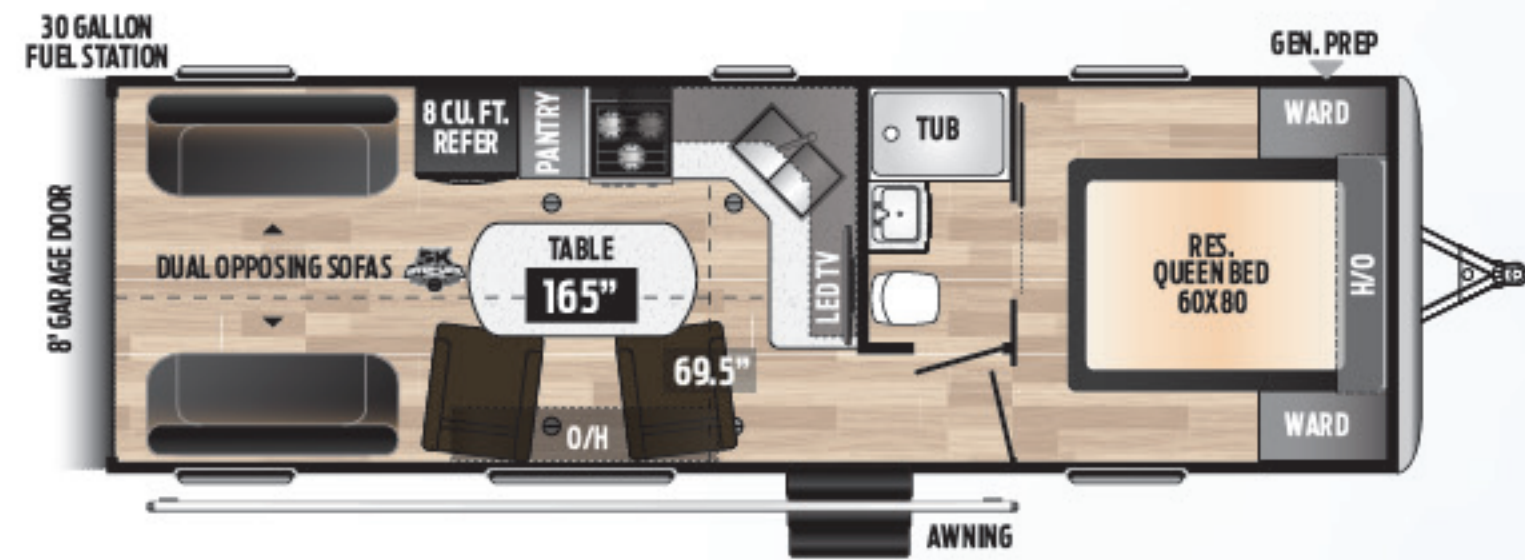

26V | LIGHTWEIGHT, OPEN CONCEPT, TANDEM-AXLE, 13' 9" GARAGE | Weight: 6645 LBS. | Length: 30' 6"

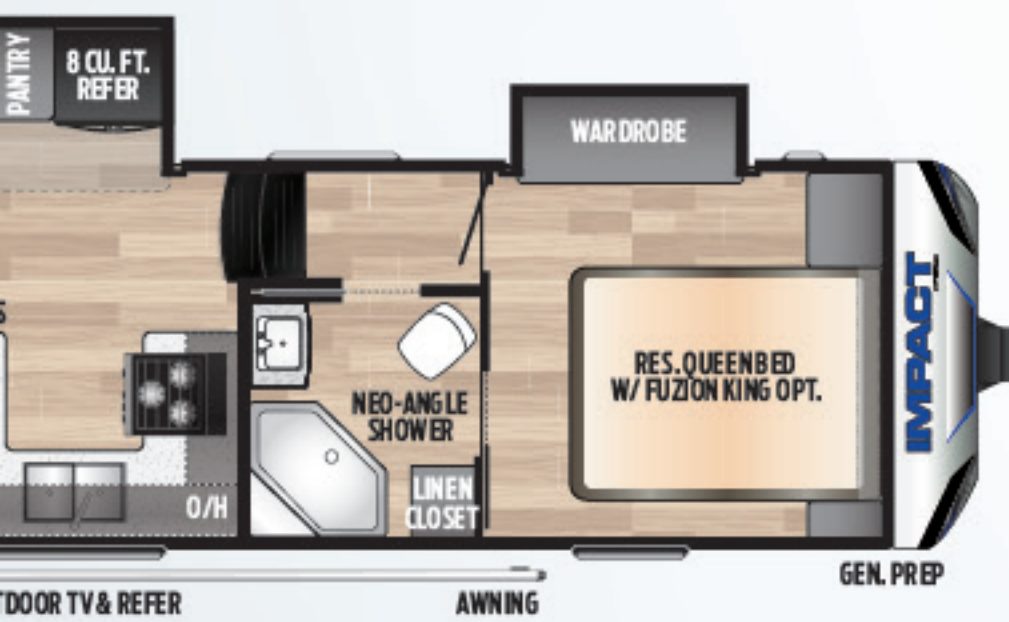

GARAGE | Weight: 12355 LBS. | Length: 39' 0"

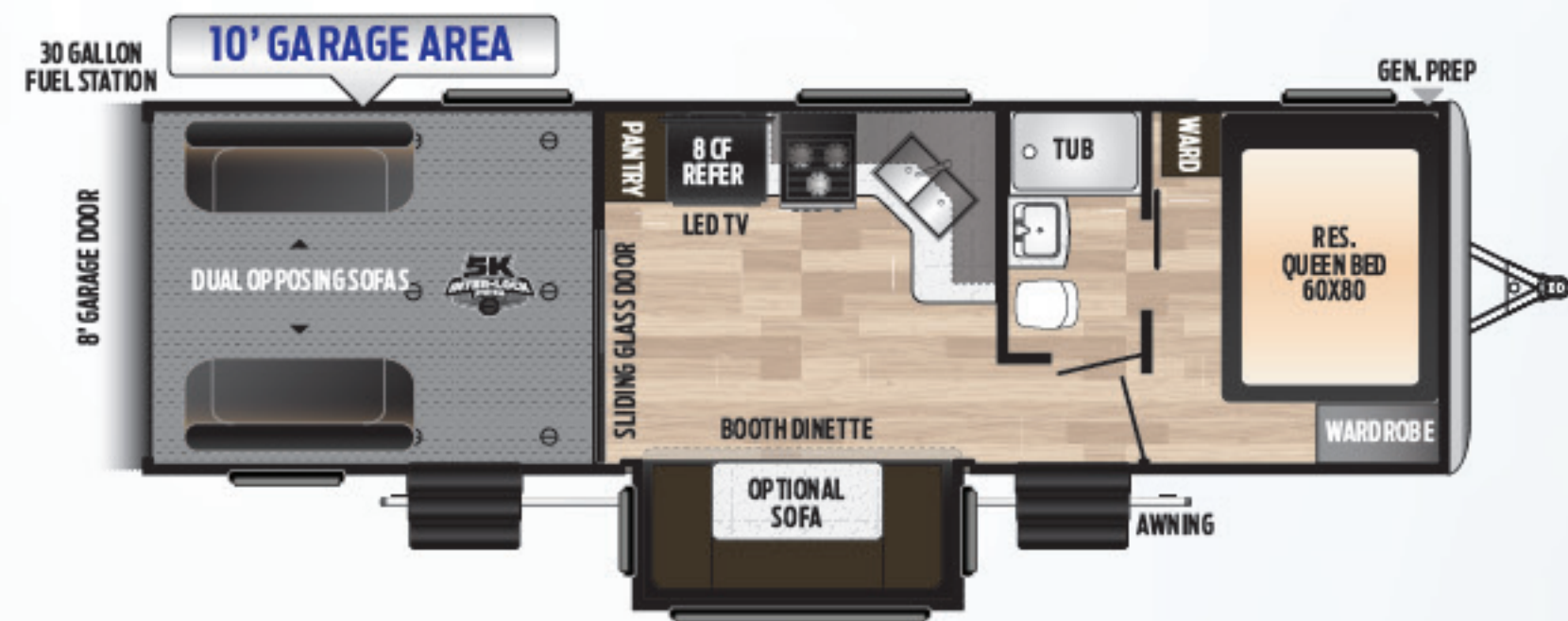

28V | LIGHTWEIGHT, ONE SLIDE, TANDEM-AXLE, 10' GARAGE | Weight: 7330 LBS. | Length: 32' 8"

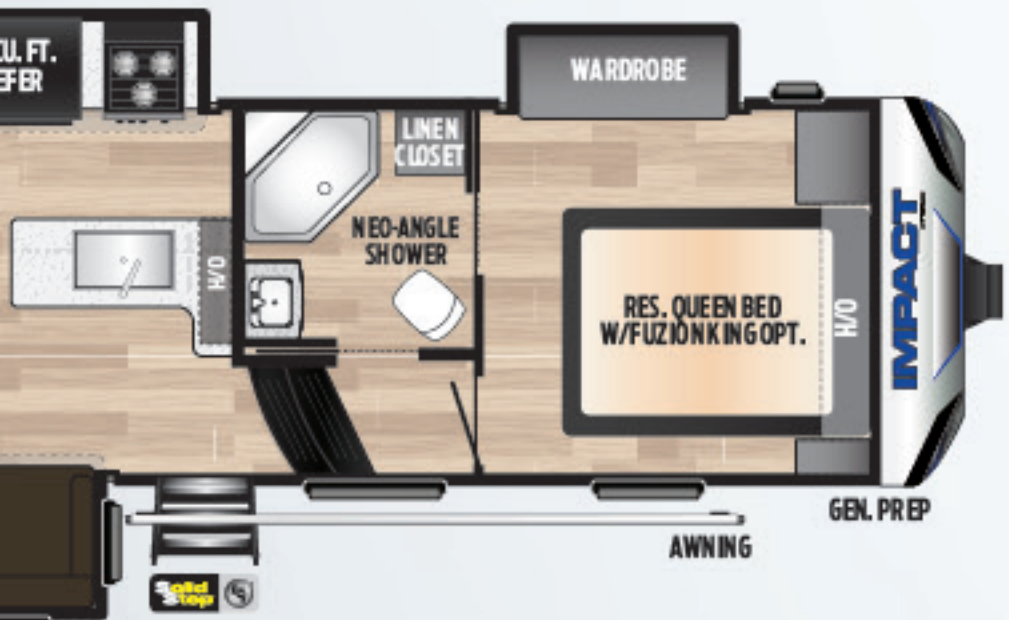

GARAGE | Weight: 12607 LBS. | Length: 39' 0"

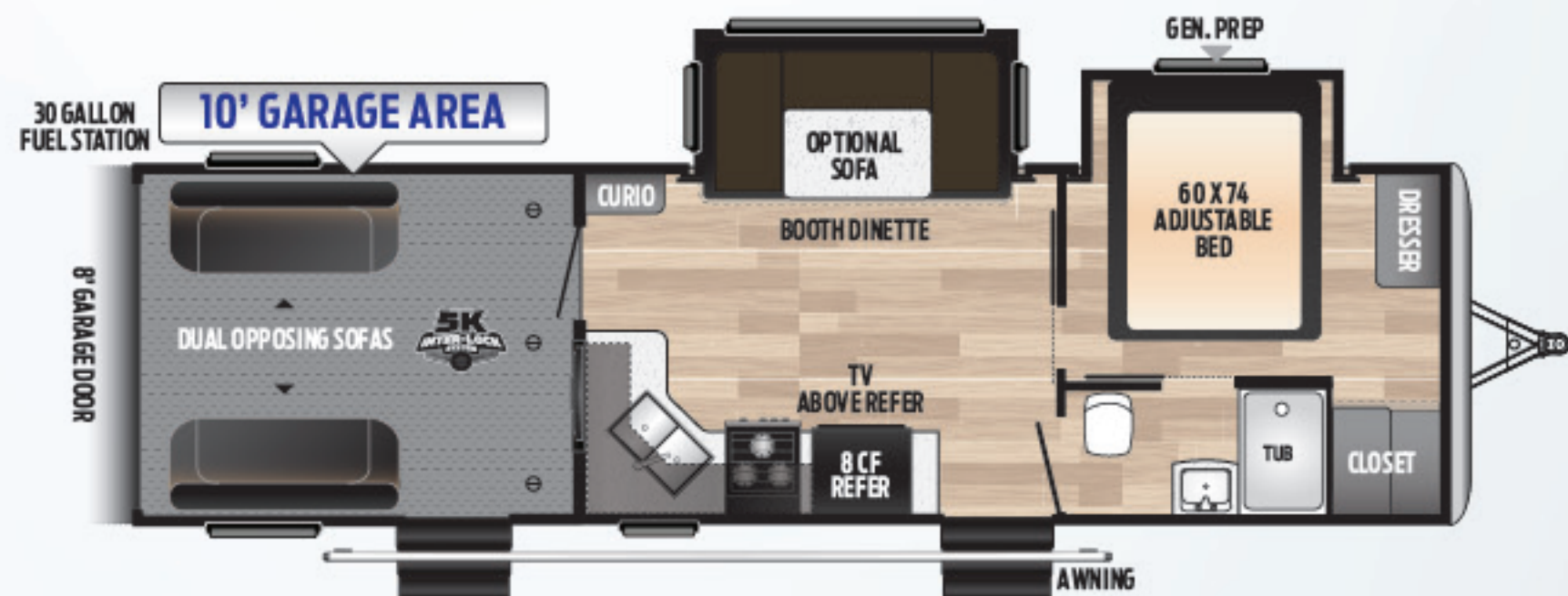

29V | LIGHTWEIGHT, TWO SLIDES, TANDEM-AXLE, 10' GARAGE | Weight: 7725 LBS. | Length: 33' 10"

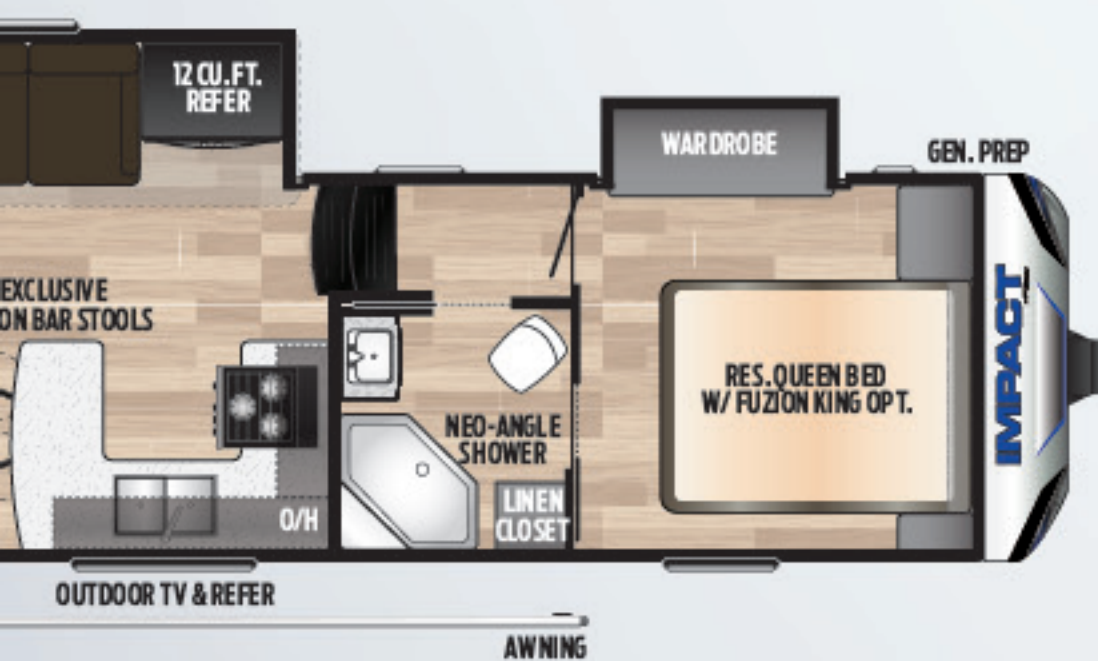

FT. REFER, OUTDOOR TV | Weight: 13835 LBS. | Length: 44' 0"





more product detail at  
[www.keystonerv.com/Impact](http://www.keystonerv.com/Impact)



## Bright and Inviting Interiors

Our fresh, farmhouse-style interior offers a bright inviting space with newly re-designed features. Impact interiors have painted gray cabinets, subway tile backsplash, white marbled countertops with bamboo sink covers and sleek black appliances. Impact offers two decors, Brindle (see website) and Eastwood (as shown).





Newly re-designed master bedroom  
is now carpet-free with reclaimed  
wood-inspired accents, dual entry,  
and deep linen cabinets.

Garage lengths span from 10'  
to an impressive 15'.



MODEL	WEIGHT	CARRYING CAPACITY	HITCH WEIGHT	FRESH WATER	WASTE WATER	GRAY WATER	LPG	LENGTH*	HEIGHT
317	9670	3330	1425	100	30	60	60	37' 6"	12' 4"
330	9454	3546	1415	100	30	60	60	37' 6"	12' 4"
332	9646	3354	1560	100	60	60	60	37' 6"	12' 4"
311	11447	5003	2450	106	44	88	60	35' 7"	13' 1"
343	12312	4588	2905	106	44	86	60	39' 0"	13' 1"
359	12355	4525	2880	106	88	88	60	39' 0"	13' 1"
367	12607	4393	2970	106	88	88	60	39' 0"	13' 1"
415	13835	5165	3155	106	88	88	60	44' 0"	13' 3"
26V	6645	3125	970	60	30	30	60	30' 6"	12' 2"
28V	7330	2670	1225	60	30	30	60	32' 8"	12' 2"
29V	7725	2275	1225	60	30	60	60	33' 10"	12' 2"

DISCLAIMER: Product information is as accurate as possible as of the date of publication of this brochure. All features, floor plans, and specifications in this brochure are subject to change without notice. Please also consult Keystone's web site at [www.keystonerv.com](http://www.keystonerv.com) for more current product information and specifications. Tow Vehicle Disclaimer. CAUTION: Owners of Keystone recreational vehicles are solely responsible for the selection and proper use of tow vehicles. All customers should consult with a motor vehicle manufacturer or their dealer concerning the purchase and use of suitable tow vehicles for Keystone products. Keystone disclaims any liability or damages suffered as a result of the selection, operation, use or misuse of a tow vehicle. KEYSTONE'S LIMITED WARRANTY DOES NOT COVER DAMAGE TO THE RECREATIONAL VEHICLE OR THE TOW VEHICLE AS A RESULT OF THE SELECTION, OPERATION, USE OR MISUSE OF THE TOW VEHICLE. \*Length is defined as the distance from the centerline of hitch pin/coupler to rear bumper of trailer. Please review owner's manual prior to purchase for more information on service warranties, extended use, towing and maintenance. Owner's manuals can be found at [keystonerv.com](http://www.keystonerv.com).

Keystone  
Exclusive



## Operate two A/C units simultaneously for the most cooling power in the industry.

Keystone's Impact engineering team partnered with Dometic to build a game changing air conditioning system for our owners who like to play in hotter climates. With Omni Chill, Impact owners can operate two of their toy hauler's air conditioners simultaneously on a 30-AMP circuit. Other manufacturers' systems require owners to cycle their air conditioners, running only one unit at a time. Testing has shown that OmniChill's revolutionary technology keeps coaches up to eight degrees cooler than our competitors in 100°F ambient temperature.

### 3/4 TON HIGH EFFICIENCY AIR CONDITIONER SYSTEM

### MOST ENERGY EFFICIENT, HIGHEST PERFORMING SYSTEM AVAILABLE

### RUN 2 A/C'S ON A 30-AMP SERVICE WITH POWER TO SPARE

### DELIVERS 15% GREATER AIRFLOW



	FW	TT	VL
<b>EXTERIOR</b>			
Aluminum constructed, fully laminated fiberglass sidewalls	○	○	○
Electric front and rear stab jacks	○	○	
100" wide body	○	○	○
8 ft. ramp door	○	○	○
Exterior convenience center	○		
16" wheels with 7,000 lb. Dexter EZ Lube® axles	○	○	
15" wheels with 4,400 lb. Dexter EZ Lube® axles			○
Spare tire with carrier	○	○	○
LED lighted electric awning	○	○	○
Diamond plate rock guard on front TT only		○	○
12-gallon gas/electric water heater with DSI FW only	○		
6-gallon gas/electric water heater with DSI TT only		○	○
30-gallon fuel station with pump	○	○	○
6-rated tires	○		
F-rated tires		○	
E-rated tires			○
Generator prep	○	○	○
LED tail lights, brake lights & ramp loading lights	○	○	○
Aluminum wheels	○	○	○
Exterior shower with hot and cold water	○	○	○
Heated enclosed underbelly	○	○	○
<b>INTERIOR</b>			
Oversized shower	○		
40" LED TV (Impact)	○	○	
32" LED TV (Vapor Lite)			○
Bluetooth CD/DVD Player with MP3 connection	○	○	○
Residential reclining furniture w/ heat, LED, massage	○	○	
Dual electric beds with collapsible rollover sofa	○	○	
8 cu. ft. refrigerator	○	○	○
12 cu. ft. refrigerator (343, 367, 415 Only)	○		

	FW	TT	VL
<b>INTERIOR (CONT.)</b>			
Furrion® 3-burner stove w/ oven	○	○	○
Hardwood cabinetry	○	○	○
30" wide entry doors	○	○	○
Tuff Ply flooring in the cargo area	○	○	○
35K BTU ducted furnace	○	○	○
2 Interior, 2 exterior speakers	○	○	○
Residential queen-sized mattress in bedroom	○	○	○
Night shades	○	○	○
Microwave oven	○	○	○
3/4 ton A/C system	○	○	○
5K InterLock system	○	○	○
Two (2) RAM air vents in the cargo area	○	○	○
Stainless steel single bowl sink	○	○	○
<b>SAFETY</b>			
Fire extinguisher	○	○	○
Smoke detector	○	○	○
LPG detector	○	○	○
CO detector	○	○	○
Safety chains		○	○
Emergency breakaway switch	○		
<b>OPTIONS</b>			
King bed Glide-A-Bed system w/ under-bed storage	○		
Frameless dual-pane safety glass windows	○	○	
Ramp door patio package	○	○	○
Onan 5500 watt gasoline generator	○	○	
Onan 4000 watt gasoline generator			○
Dual ¾ ton A/C's	○	○	
3-seat sofa w/ LED, heat, massage (28v, and 29v) IPO booth dinette			○
HappiJac® bed w/ upper bunks & table	○	○	
HappiJac® bed system w/ table and upper bunk			○



# BUILT FOR THE LONG HAUL



PRINT 10.2019

