

# JAY FLIGHT SLX 8

## TRAVEL TRAILERS (IDAHO)



**212QBW**

Ext. Lgth: 25' 8" Weight: 4,135 lbs. Hitch: 460 lbs.

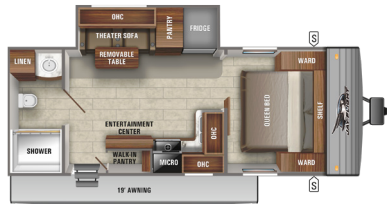

**237RBSW**

Ext. Lgth: 26' 10" Weight: TBD Hitch: TBD

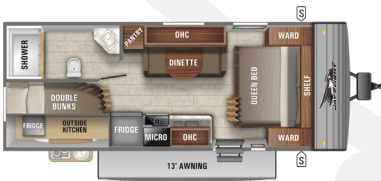

**224BHW**

Ext. Lgth: 27' 1" Weight: 4,350 lbs. Hitch: 410 lbs.



**245RLSW**

Ext. Lgth: 28' 1" Weight: TBD Hitch: TBD

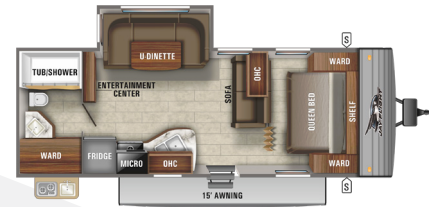

**248RBSW**

Ext. Lgth: 28' 8" Weight: TBD Hitch: TBD

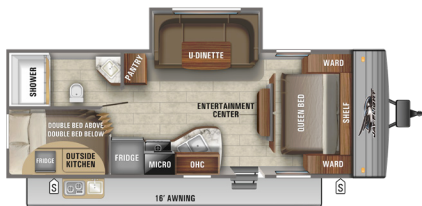

**242BHSW**

Ext. Lgth: 29' 2" Weight: TBD Hitch: TBD

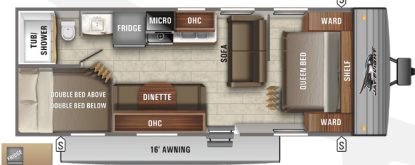

**264BHW**

Ext. Lgth: 29' 5" Weight: 4,550 lbs. Hitch: 465 lbs.



**267BHSW**

Ext. Lgth: 30' 2" Weight: 5,656 lbs. Hitch: 645 lbs.



**275RLSW**

Ext. Lgth: 30' 8" Weight: 5,815 lbs. Hitch: 695 lbs.



**286BHSW**

Ext. Lgth: 33' 2" Weight: TBD Hitch: TBD

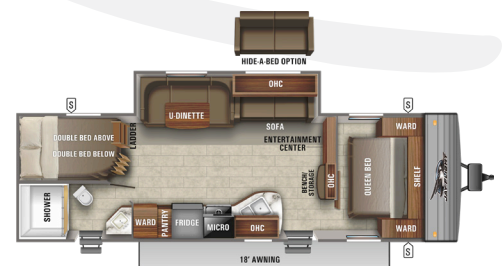

**287BHSW**

Ext. Lgth: 33' 5" Weight: TBD Hitch: TBD

# STANDARDS & OPTIONS

## STANDARD EXTERIOR EQUIPMENT

Axles with electric, self-adjusting brakes and easy-lube hubs  
 I-Class™ cambered structural steel I-beams  
 Fully integrated A-frame  
 Black tank flush  
 5/8 in. tongue-and-groove plywood floor decking  
 Magnum Truss™ Roof System with plywood decking and seamless DiFlex II material  
 2-sided reflective foil insulation in flush floor slideout floors  
 13,500 BTU roof-mounted A/C  
 Galvanized steel, impact-resistant wheel wells  
 30-amp service  
 20 lb. propane bottles (2)  
 Pull-out camp kitchen (select models)  
 Exterior TV bracket  
 LED exterior lighting  
 G20 dark tinted safety-glass privacy windows

## STANDARD INTERIOR EQUIPMENT

81 in. ceiling height  
 Solid hardwood cabinet doors  
 LED interior lighting  
 Wardrobe/pantry storage  
 J-Steel™ jackknife sofa  
 Vinyl flooring  
 Residential grade carpet (select models)  
 Premium multimedia sound system with MP3/iPod input jacks and Bluetooth® connectivity  
 Digital TV antenna  
 Cable/satellite TV hookup  
 Smoked-glass cabinet door inserts (select models)  
 Large 50/50 acrylic kitchen sink  
 Brushed nickel faucets  
 Heavy-duty, 75 lb., full-extension, steel ball-bearing drawer guides  
 Residential-height plywood bed platforms  
 Bedroom doors in place of curtains (select models)  
 Queen bed struts  
 Queen Serta® mattress  
 Bedroom LED accent lighting  
 300 lb. rated bunk beds (select models)

600 lb. rated bunk beds (double bunks only)  
 Privacy curtains in bunk areas (select models)  
 4 in. thick bunk mats (select models)  
 Marine-grade toilet with foot flush  
 Tub surround  
 Bathroom exhaust vent  
 Shower curtain with curved shower track (select models)  
 Wood-trimmed mirror in bathroom

## CUSTOMER VALUE PACKAGE (MANDATORY)

Goodyear® Endurance® tires (made in the USA)  
 6 gal. gas/electric DSI water heater  
 Water heater bypass  
 Front diamond plate  
 Keyed-Alike™ entry and baggage doors  
 Outside shower  
 Power awning with speakers and LED lights  
 Spare tire with cover  
 Stabilizer jacks (4)  
 Hitch light  
 Rooftop solar prep  
 JaySMART™ (Safety Markers And Reverse Travel) LED lighting (patent-pending)  
 Large folding entry door grab handle  
 Power tongue jack  
 Pleated window shades  
 Range hood  
 3-burner range with glass cover  
 6 cu. ft. stainless steel refrigerator with temperature controls  
 Oven with glass door and interior light  
 Stainless steel microwave oven  
 Bedspread  
 Bathroom skylight

## ROCKY MOUNTAIN EDITION (OPTIONAL)

2nd fresh water tank- 80 gal. total capacity  
 Deluxe colored metal  
 Decorative slide room lighting  
 8 cu. ft. refrigerator  
 Pull-out kitchen faucet with sprayer  
 Sink cover and one rolling drying rack

Kitchen backsplash  
 Bathroom medicine cabinet  
 Porcelain foot flush toilet

## BAJA EDITION PACKAGE (OPTIONAL)

30 lb. propane bottles (2)  
 Flipped axle  
 16 in. Goodyear® off-road tires  
 Triple step

## OPTIONS

Rocky Mountain Edition  
 Baja Edition Package  
 15,000 BTU roof-mounted A/C  
 50-amp service (286BHSW, 287BHSW & 324BDSW)  
 Roof ladder  
 Exterior bumper-mount grill  
 Cargo accessory receiver (N/A 212QBW, 224BHW, 264BHW & 267BHSW)  
 Aluminum rims (N/A with Baja Edition Package)  
 Enclosed underbelly  
 Thermal package: insulated, heated, and enclosed underbelly and reflective foil insulation in main roof and slideout floors  
 Chil N' Stor (245RLSW & 264BHW)  
 MORryde® StepAbove™ Entry Steps  
 30 lb. propane bottles (standard with Baja Edition Package option)  
 Solar Power Package (100W roof solar panel & 30-amp digital controller)  
 LED TV  
 Free-standing table with 4 chairs (245RLSW, 267BHSW, 275RLSW & 285RLSW)  
 Hide-a-bed with tri-fold mattress (select models)

FLOORPLAN	EXTERIOR TRAVEL LENGTH	EXTERIOR WIDTH	EXTERIOR HEIGHT (WITH A/C)	INTERIOR HEIGHT	UNLOADED VEHICLE WEIGHT	DRY HITCH WEIGHT	GVWR	CARGO CARRYING CAPACITY	FRESH WATER CAPACITY (INCLUDING WATER HEATER)	GRAY WASTE WATER CAPACITY	BLACK WASTE WATER CAPACITY	SLEEPING CAPACITY
212QBW	25' 8"	8' 0"	10' 7"	6' 9"	4,135	460	6,000	1,865	46	39	39	4-5
237RBSW	26' 10"	8' 0"	11' 0"	6' 9"	TBD	TBD	TBD	TBD	46	39	39	2
224BHW	27' 1"	8' 0"	10' 7"	6' 9"	4,350	410	6,000	1,650	48	39	39	7-8
245RLSW	28' 1"	8' 0"	11' 1"	6' 9"	TBD	TBD	TBD	TBD	86	39	39	4-6
248RBSW	28' 8"	8' 0"	11' 1"	6' 9"	TBD	TBD	TBD	TBD	82	39	39	4-5
242BHSW	29' 2"	8' 0"	10' 1"	6' 9"	TBD	TBD	TBD	TBD	82	39	39	7-8
264BHW	29' 5"	8' 0"	10' 7"	6' 9"	4,550	465	6,500	1,950	48	39	39	8-9
267BHSW	30' 2"	8' 0"	11' 4"	6' 9"	5,656	645	7,500	1,844	82	39	39	8-10
275RLSW	30' 8"	8' 0"	11' 3"	6' 9"	5,815	695	7,800	1,985	46	39	39	3-5
286BHSW	33' 2"	8' 0"	11' 3"	6' 9"	TBD	TBD	TBD	TBD	86	78**	39	8-10
287BHSW	33' 5"	8' 0"	11' 5"	6' 9"	TBD	TBD	TBD	TBD	86	39	39	8-10

Some specs at the time of print may include estimates, for the most updated information, please visit [Jayco.com](http://Jayco.com)

\*\*Indicates split tanks



### TRAVEL WITH CONFIDENCE • NO ONE OFFERS A BETTER WARRANTY

At Jayco, we build our RVs to handle every adventure, then back them with our industry-leading 2+3 limited warranty. Our 2-year limited warranty has you covered for 2 camping seasons. That's 730 days. In addition, our 3-year structural limited warranty has you covered for 3 camping seasons or 1,095 days. You won't find a better limited warranty in the business, because the only strings that we attach are those that deliver the ultimate in reliability. That's the Jayco difference. So go explore. For a copy of our 2-year limited + 3-year limited structural warranty with complete terms and conditions, please contact your local Jayco dealer.



Scan QR code for specification definitions



Generations of family fun.