

Class A Motorhomes | 2018



Generations of family fun.



Precept • Alante



Generations of family fun.

HANDS DOWN, THE BEST RIDE.

2
YEAR
WARRANTY



Our Wings Get You There

Family fun happens when you spread your wings. Thanks to Jayco's amenity-packed floorplans, rock-solid construction and two full camping seasons, or 24,000 miles, of warranty coverage, you can. Greater peace of mind and added comfort mean better memories and lasting bonds. So go ahead. Hit the road—and let the good times fly.

Generations of Family Fun



PRECEPT

Atlante

CLASS A MOTORHOMES

The lineup delivers an unmatched combination of performance and value. With industry-exclusive technology, premium ride and handling features, and oh-so-comfortable spaces, these coaches have something for every traveler.

THE JAYCO DIFFERENCE

1. **120-inch panoramic windshield** equipped with oversized wiper blades allows for maximum visibility
2. **Exterior entertainment center** comes standard with an LED TV mounted on a swivel bracket
3. **One-piece fiberglass roof** offers unmatched durability
4. **Lockable pass-through storage** with easy-to-use Slam-latch™ doors
5. **Seatbelts in every seating position** secure the most precious cargo

WE CARE ABOUT GETTING THERE AS MUCH AS BEING THERE

JRide® is a powerful blend of precise handling and renowned stability. Hands down, it's the best ride. Experience JRide for yourself—visit your local dealer and take a test drive.



A PRECEPT STANDARD



Precept:
<https://www.jayco.com/products/class-a-motorhomes/2018-precept/jride-plus/>



AN ALANTE STANDARD



Alante:
<https://www.jayco.com/products/class-a-motorhomes/2018-alante/jride/>

*Each model contains different JRide components. Visit Jayco.com for details.



COMPUTER-BALANCED DRIVESHAFT

Ensures smooth and efficient power transfer from the engine to the wheels

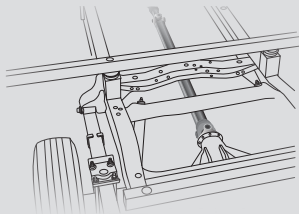

OUNCE BUMPERS

Assist during extreme road occurrences to absorb impact and dampen excess road noise

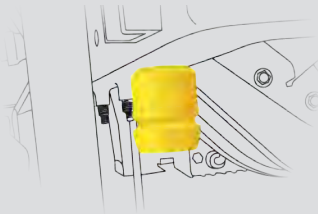

STABILIZER BAR(S)

Reduces the body roll of a vehicle during fast cornering or over road irregularities

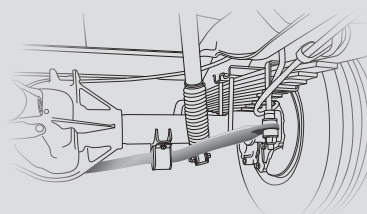

SACHS SHOCK ABSORBERS

Large-diameter tube design pairs gas and hydraulics to resist heat and pressure while independently adjusting to changing road conditions

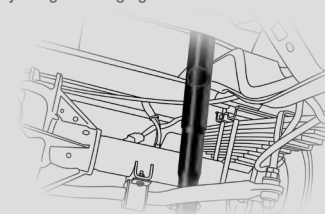

HEAVY-DUTY FRONT STABILIZER BAR

A larger bar and polyurethane bushings, instead of rubber, transfer power faster for extra support, more stability and easier handling

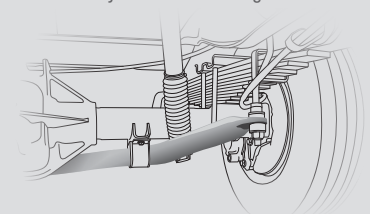

JAYCO-EXCLUSIVE GARMIN® INFOTAINMENT SYSTEM POWERED BY FUSION®

New for 2018 and exclusive to Jayco motorhomes, this easy-to-use, detachable touchscreen system delivers the convenience of connectivity, doubling as a custom RV navigation and four-zone AM/FM/Bluetooth®/USB entertainment system.



FEATURED FLOORPLAN: 33U

PRECEPT

FEATURE KEY: 1. Solid-surface countertops with integrated stainless steel sink 2. Day/night roller shades 3. Expandable L-shaped sofa (33U) 4. Overhead bunk with 750-pound capacity



TRUMA AquaGo® ON-DEMAND WATER HEATER



EXTERIOR ENTERTAINMENT CENTER WITH LED LIGHTS AND ELECTRIC AWNING



12-CUBIC-FOOT REFRIGERATOR

PRECEPT FLOORPLANS

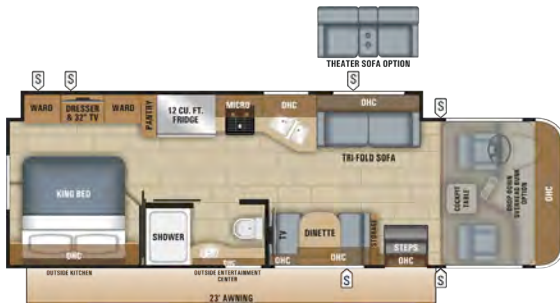

PRECEPT | 29V



PRECEPT | 31UL



PRECEPT | 33U

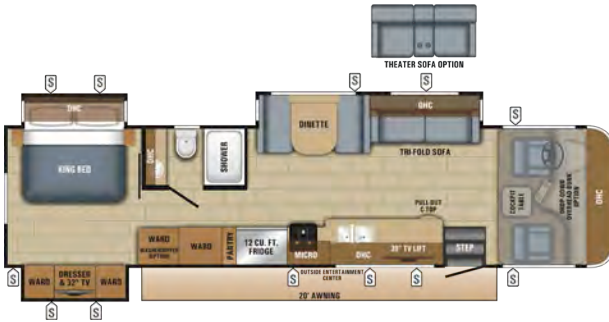

PRECEPT | 35S



PRECEPT | 36T

PRECEPT EXTERIOR SELECTIONS



Graphics
Sahara Dream



Premium Paint Option
Desert Sky



Premium Paint Option
Moon Bay



Premium Paint Option
Summer Wood

PRECEPT INTERIOR DÉCOR

CHATEAU

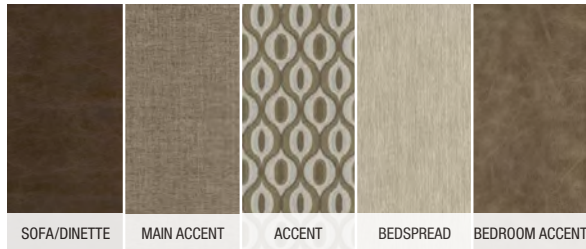

MINERAL

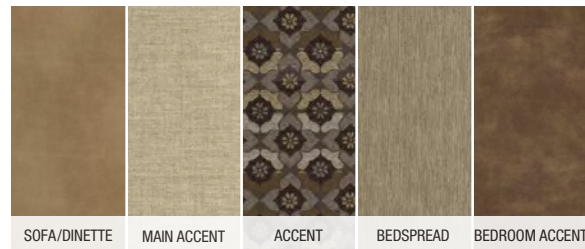

PRECEPT SPECS

MODELS	DIMENSIONS					TANKS (GALS.)			
	FLOORPLAN	EXTERIOR LENGTH	EXTERIOR WIDTH	EXTERIOR HEIGHT (WITH A/C)	INTERIOR HEIGHT	WHEEL BASE	FRESH WATER CAPACITY (INCLUDES WATER HEATER)	GREY WASTE WATER CAPACITY	BLACK WASTE WATER CAPACITY
29V		32' 2"	101"	12' 7"	84"	190"	72	40 / 8.5	50
31UL		32' 11"	101"	12' 7"	84"	228"	72	40	50
33U		36' 3"	101"	12' 7"	84"	228"	72	40 / 31	51 / 31
35S		36' 7"	101"	12' 7"	84"	228"	72	40	50
36T		38' 2"	101"	12' 7"	84"	242"	72	40 / 40	51 / 51



FEATURED FLOORPLAN: 31R

ALANTE

FEATURE KEY: 1. Hardwood cabinet doors 2. Roller shades 3. LED living room TV 4. 3-burner range and oven with 9,000-BTU SuperBurner™ and piezo igniter



OPTIONAL DROP-DOWN BUNK WITH 750-POUND RATING



31V BEDROOM



26X COCKPIT

ALANTE FLOORPLANS



ALANTE | 26X

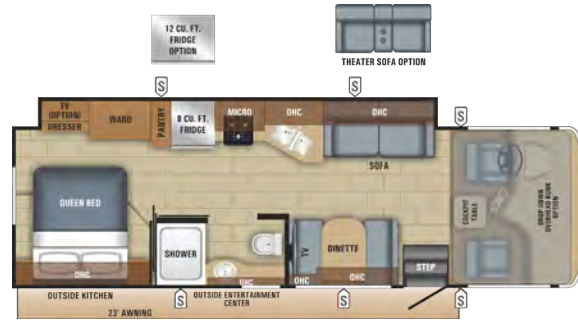

ALANTE | 29S



ALANTE | 31P



ALANTE | 31R



ALANTE | 31V

ALANTE EXTERIOR



Sparkling Sand Graphics

ALANTE INTERIOR DÉCOR

ALBANY

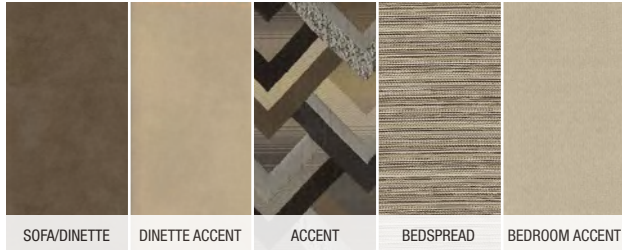

CHAMBRAY



NANTUCKET

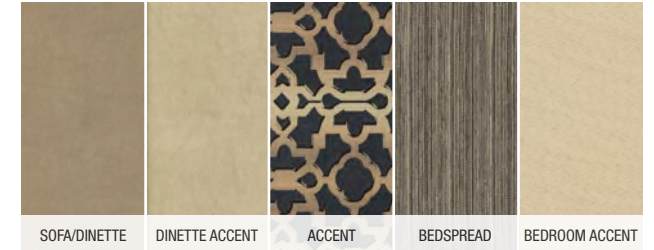

ALANTE SPECS

MODELS	DIMENSIONS					TANKS (GALS.)			
	FLOORPLAN	EXTERIOR LENGTH	EXTERIOR WIDTH	EXTERIOR HEIGHT (WITH A/C)	INTERIOR HEIGHT	WHEEL BASE	FRESH WATER CAPACITY (INCLUDES WATER HEATER)	GREY WASTE WATER CAPACITY	BLACK WASTE WATER CAPACITY
26X		27' 5"	101"	12' 5"	84"	158"	59	40	32
29S		31' 4"	101"	12' 5"	84"	190"	79	40 / 9	50
31P		31' 6"	101"	12' 5"	84"	191"	79	41	51
31R		34' 10"	101"	12' 5"	84"	228"	79	40	50
31V		31' 11"	101"	12' 5"	84"	190"	78	40	50

Gross Vehicle Weight Rating (GVWR): The maximum permissible weight of the motorhome, including the Unloaded Vehicle Weight (UUV) plus passengers, personal items, all cargo, fluids, options and dealer-installed accessories. The GVWR is equal to or greater than the sum of the UUV and the Cargo Carrying Capacity.

Gross Combined Weight Rating (GCWR): The maximum allowable combined weight of the motorhome used as a tow vehicle and the attached towed vehicle. It is important for your safety and enjoyment that you are aware of the weights and tow ratings of the RV you select. Consult a competent advisor for questions or advice.

Whether you are new to RVing or a veteran, get a feel for the performance of your RV before heading out on the roadways. When you tow a vehicle with your RV, you must drive differently than when you drive a single vehicle. Practice hooking up, driving, backing up and braking in a safe environment or seek out professional instruction. Jayco affixes a weight label to each RV which lists weight information for that vehicle. Refer to that label to verify the vehicle will meet your requirements.

STANDARDS AND OPTIONS

PRECEPT

CUSTOMER VALUE PACKAGE

JRide® Plus Package: Computer-balanced driveshaft, heavy-duty front stabilizer bar, standard rear stabilizer bar, jounce bumpers, SACHS shock absorbers

Automatic hydraulic leveling jacks

Jayco-exclusive Garmin® infotainment system powered by Fusion®

Backup and sideview cameras

Frameless windows

Electric patio awning with LED lights

Slideout cover awnings

Exterior entertainment center with LED TV mounted on swivel bracket and CD/DVD/AM/FM radio and speakers

Onan® Marquis Gold Genset 5,500-watt generator with auto-gen start

1000-watt inverter

50-amp electrical service

15,000-BTU A/C unit with heat pumps (2)

Truma AquaGo® on-demand water heater

Solid-surface kitchen countertops with integrated stainless steel sink

LED living room TV

Day/night roller shades

Driver/passenger cockpit table

STANDARD EXTERIOR EQUIPMENT

High-gloss fiberglass walls

One-piece fiberglass roof

Entrance door with industry's largest travel-view window

One-piece fiberglass front and rear cap

Bead-foam insulation (R-24 max roof, R-9 max floor, R-8 max walls)

Electric-powered entrance steps

Lockable pass-through storage compartments with easy-to-use Slam-latch™ doors

12V house battery

12V demand water pump

Theftford® Sani-Con® Turbo macerator system

120-inch panoramic windshield

STANDARD INTERIOR EQUIPMENT

Soft-touch vinyl ceiling

High-intensity, recessed LED ceiling lights

Ball-bearing drawer guides

3-burner range with 9,000-BTU SuperBurner™ and piezo igniter

Convection microwave oven

12-cubic-foot gas/electric refrigerator

Water filtration system

Dream Dinette™ mechanism, easily raises/lowers tabletop

Seatbelts in all seating positions

Soft-touch vinyl dash

30,000-BTU auto-ignition ducted furnace (29V, 31UL) (2- 33U, 36T)

35,000-BTU auto-ignition ducted furnaces (35S)

Prep for satellite dish

Cable TV hookup with RG-6 coax and video selector switch

Digital antenna with signal booster

Shower with surround, glass door, skylight and light

Stainless steel lavatory sink

Porcelain toilet with foot flush

Powered roof vent in bathroom with wall switch

Queen-size bed with under-bed storage (33U, 36T)

King-size bed with under-bed storage (29V, 31UL, 35S)

32-inch LED TV in bedroom

Bunk beds (300-pound rating) (36T)

Decorative kitchen backsplash

Entrance door with large frameless window and keyless entry

STANDARD DRIVING EQUIPMENT

Ford® F53 chassis:

20,500-pound GVWR (29V, 33U)

22,000-pound (31UL, 35S)

24,000-pound GVWR (36T)

6.8L Triton® V-10 320HP gas engine with electronic fuel injection and 460 lb.-ft. torque

6-speed automatic TorqShift® transmission with overdrive and tow-haul mode

130-amp alternator

56-pound, 16.5-gallon propane tank

12V chassis battery

Front and rear disc, 4-wheel anti-lock brakes

5,000-pound-rated rear hitch receiver with dual connector

7-pin plug

6-way power, swivel driver and passenger seats

Flush-mount LED marker lights

Third brake light

OPTIONS

Canadian standards

Premium Paint Options: Desert Sky, Moon Bay, Summer Wood

Drop-down overhead bunk in cab area with 750-pound capacity

Washer/dryer combination (33U, 35S, 36T)

Power theater seats (n/a in 33U)

ALANTE

CUSTOMER VALUE PACKAGE

JRide Package: Computer-balanced driveshaft, jounce bumpers, standard front and rear stabilizer bars, SACHS shock absorbers

Jayco-exclusive Garmin infotainment system powered by Fusion

Backup and sideview cameras

Electric patio awning with LED lights

Slideout cover awnings

LED living room TV

Roller shades

One-piece fiberglass roof

Exterior entertainment center with LED TV mounted on swivel bracket and CD/DVD/AM/FM radio and speakers

1,000-watt inverter

Driver/passenger cockpit table

STANDARD EXTERIOR EQUIPMENT

Automatic hydraulic leveling jacks

White, high-gloss fiberglass walls

One-piece fiberglass front cap

Frameless windows

Entrance door with industry's largest travel-view window

Bead-foam insulation (R-24 max roof, R-9 max floor, R-8 max walls)

Electric-powered double entry step

Lockable pass-through storage compartments with easy-to-use Slam-latch doors

12V house battery

12V demand water pump

30-amp electrical service cord

4-inch tube bumper with sewer hose storage

Onan Marquis Gold Genset 4,000-watt generator

11,000-BTU A/Cs (2) (n/a on 26X)

15,000-BTU A/C (26X)

Energy Management System

Outside shower

STANDARD INTERIOR EQUIPMENT

Stainless steel sinks in kitchen and bathroom

Kitchen countertops with large double sink

High-intensity, recessed LED ceiling lights

Hardwood cabinet doors throughout

Ball-bearing drawer guides

3-burner range with oven, 9,000-BTU SuperBurner and piezo igniter

1.6-cubic-foot microwave

8-cubic-foot gas/electric refrigerator

Water filtration system

Seatbelts in all seating positions

31,000-BTU auto-ignition ducted furnace

Prep for satellite dish

Cable TV hookup with RG-6 coax and video selector switch

Digital antenna with signal booster

Shower with glass door, skylight and light

Toilet with foot flush

Bathroom powered roof vent with wall switch

Bedroom power vent (26X)

Full two-toned dash with grey burl accents

6-gallon gas/electric water heater

Linoleum flooring

Queen-size bed with bedspread

Decorative window valance

Bunk beds (300-pound rating) (31R)

STANDARD DRIVING EQUIPMENT

Ford F53 chassis:

16,000-pound GVWR (26X)

18,000-pound GVWR (29S, 31P, 31V)

20,500-pound GVWR (31R)

6.8L Triton V-10 320HP gas engine with electronic fuel injection and 460 lb.-ft. torque

6-speed automatic TorqShift transmission with overdrive and tow-haul mode

175-amp alternator

56-pound, 16.5-gallon propane tank

12V chassis battery

19.5-inch Goodyear® radial tires

Front and rear disc, 4-wheel anti-lock brakes

5,000-pound-rated rear hitch receiver with dual connector

7-pin plug

6-way power driver seat

LED marker lights

Third brake light

Power front shade

OPTIONS

Canadian standards

LED TV in bedroom

Drop-down overhead bunk in cab area with 750-pound capacity

12-cubic-foot gas/electric refrigerator (29S, 31P, 31R)

Theater seats (n/a in 26X, 31R)



Generations of family fun.

Meet your Jayco Dealer

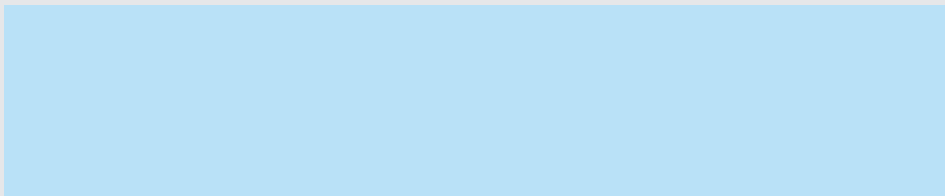

We work hard—so you can play hard. From finding the perfect Jayco for your family to providing flexible financing options and full-service support, we're here to help.

Follow Jayco



Jayco, Inc. | P.O. Box 460 | Middlebury, IN 46540

Jayco reserves the right to make changes and to discontinue models without notice or obligation. Photography may show optional equipment or props used for decoration purposes only. RVs built for sale in Canada may differ to conform to Canadian codes. JAYCO and the JAYCO BIRD IN FLIGHT are registered trademarks of Jayco, Inc. Printed in USA 20K 2/18 ©2018 Jayco, Inc. 274785-1

Travel with Confidence



At Jayco, we build our RVs to handle every adventure, then back them with our industry-leading 2-year limited warranty. We, with support from our select partners, have you covered for **2 camping seasons** or **twenty-four thousand (24,000) miles** (mileage limitation applies to motorized products only), whichever occurs first, from the original date of purchase. You won't find a better warranty in the business, because the only strings we attach are those that deliver the ultimate in reliability. That's the Jayco difference. So go explore. We have the warranty that will follow you. For a copy of our 2-year limited warranty with complete terms and conditions, please contact your local Jayco dealer.

FREE

ROADSIDE ASSISTANCE

A year's access to Coach-Net™—the country's largest RV emergency road service.



eco advantage™

Jayco's long-term commitment to generations of family fun

After six years of increased efforts to eliminate waste, conserve energy and increase recycling, we've come a long way in building RVs that are not only better for your family—but also better for the planet.

Learn more at Jayco.com/EcoAdvantage