



2019 JAY FEATHER



Our first camping trip!
Black Rock State Park 1986

2
YEAR
WARRANTY

JAY FEATHER HYBRID



X23E MAIN INTERIOR



X23E KITCHEN



X23E MAIN INTERIOR



X23E OPEN



X23E CLOSED

JAY FEATHER



27BH MAIN INTERIOR



24BHM MURPHY BED UP



24BHM MURPHY BED DOWN

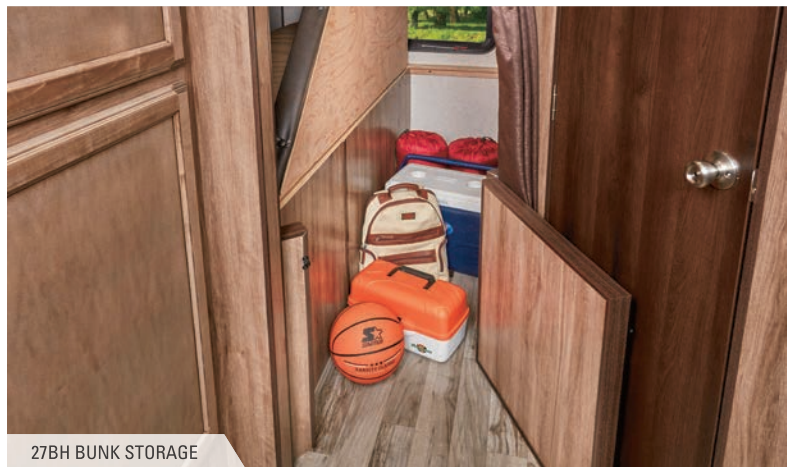

27BH BUNK STORAGE



27BH BAJA PACKAGE

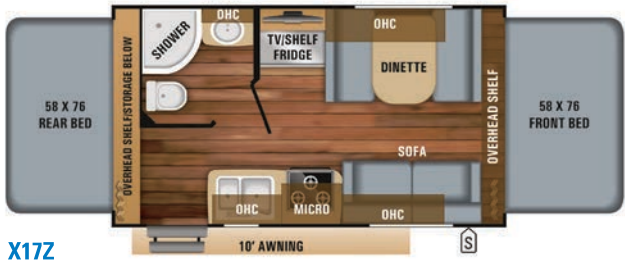

X17Z

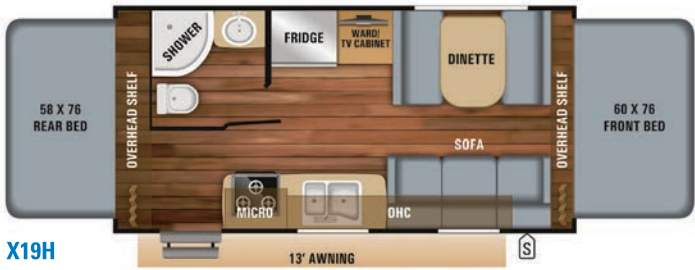

X19H

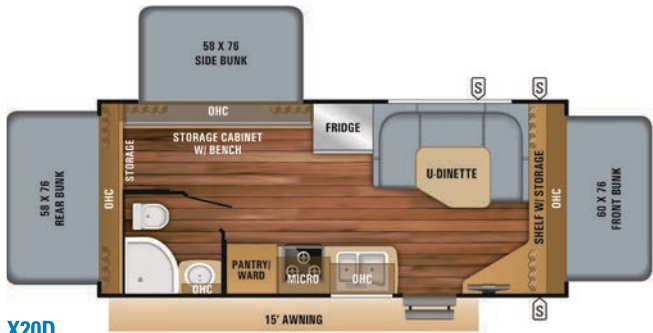

X20D

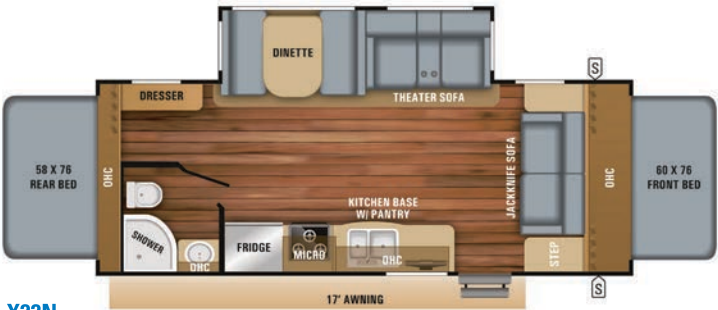

X22N

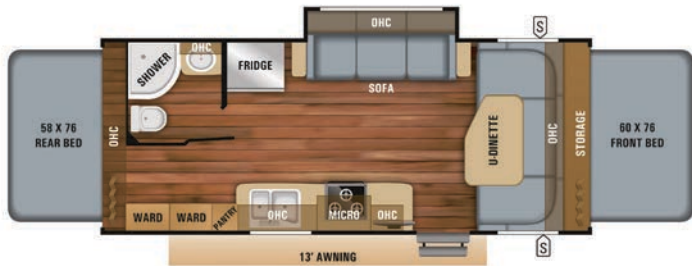

X23B

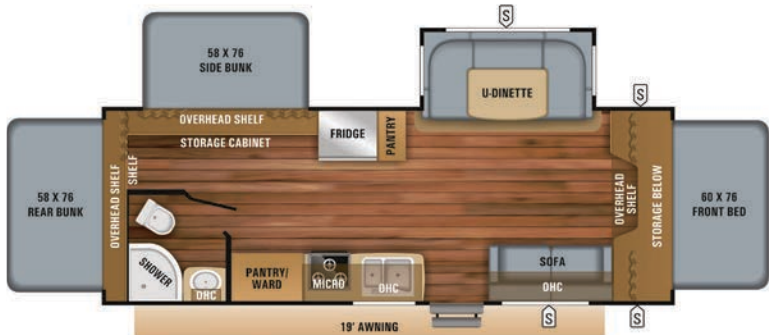

X23E OPTION: B

LEGEND

- S** STORAGE
- H** TRAILER HITCH
- MICRO** MICROWAVE
- OHC** OVERHEAD CABINETS
- FRIDGE** REFRIGERATOR
- WARD** WARDROBE

OPTIONS

OPTION A

OPTION B

OPTION C

JAY FEATHER HYBRID SPECS

FLOORPLAN	EXTERIOR TRAVEL LENGTH	EXTERIOR WIDTH	EXTERIOR HEIGHT (WITH A/C)	INTERIOR HEIGHT	UNLOADED VEHICLE WEIGHT	DRY HITCH WEIGHT	GROSS VEHICLE WEIGHT RATING	CARGO CARRYING CAPACITY	FRESH WATER CAPACITY (INCLUDES WATER HEATER)	GREY WASTE WATER CAPACITY	BLACK WASTE WATER CAPACITY	SLEEP CAPACITY
X17Z	18' 4"	8' 0"	10' 0"	6' 6"	3,195	450	3,950	755	28.5	30.5	22.5	6 - 7
X19H	20' 8"	8' 0"	10' 3"	6' 6"	3,815	367	4,950	1,135	48.0	30.5	22.5	6 - 7
X20D	22' 9"	8' 0"	10' 0"	6' 6"	4,070	426	5,000	930	48.0	30.5	30.5	7 - 8
X22N	25' 6"	8' 0"	10' 9"	6' 6"	5,130	550	6,150	1,020	48.0	30.5	30.5	5 - 6
X23B	24' 5"	8' 0"	10' 3"	6' 6"	4,425	495	5,500	1,075	48.0	30.5	22.5	6 - 7
X23E	26' 8"	8' 0"	10' 8"	6' 6"	5,105	620	6,150	1,045	48.0	30.5	22.5	8 - 9

Unloaded Vehicle Weight (UVW): Sometimes referred to as “Dry Weight,” UVW means the typical weight of this trailer as built at the factory. The UVW, as used in product literature and other promotional materials, does not include cargo, fresh water, propane, options or dealer-installed accessories.

Gross Vehicle Weight Rating (GVWR): GVWR means the maximum permissible weight of the trailer, including the UVW plus personal items, all cargo, fluids, options and dealer-installed accessories. The GVWR is equal to or greater than the sum of the UVW and the CCC.

Cargo Carrying Capacity (CCC): CCC means the maximum weight of personal items, food, fresh water, propane, tools, other cargo and dealer-installed accessories that can be carried by the trailer. CCC is equal to or less than GVWR minus UVW. The addition of options will decrease the CCC.

Hitch Weight (HW): The hitch weight, as used in product literature and other promotional materials, does not include cargo, fresh water, propane gas, options or dealer-installed accessories. The addition of these types of items will either add to or subtract from the stated hitch weight.

It is important for your safety and enjoyment that your tow vehicle be adequately sized and equipped to tow and handle the GVWR of the RV you select. Review weights and rating of your tow vehicle and consult a competent advisor for questions or advice. Whether you are new to RVing or a veteran, get a feel for the performance of your tow vehicle before heading out on the roadways. When you tow an RV, you must drive differently than when you drive a single vehicle. Practice hooking up, driving, backing up and braking in a safe environment or seek out professional instruction. Jayco affixes a weight label to each RV which lists weight information for that vehicle. See specifications chart on next page.

JAY FEATHER FLOORPLANS



X213

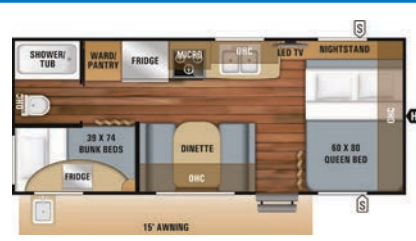

20BH OPTION: A



21RD



23BHM OPTION: A

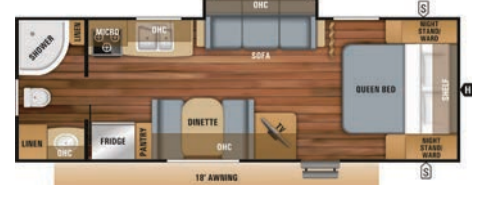

23RB

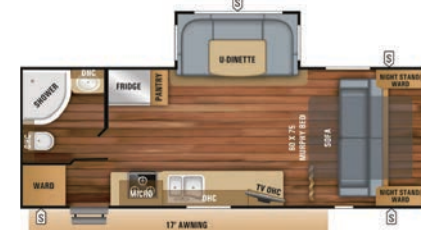

23RBM OPTIONS: B, C



24BHM



23RB

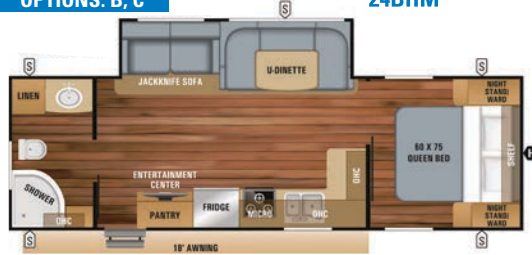

25RB OPTIONS: A, B

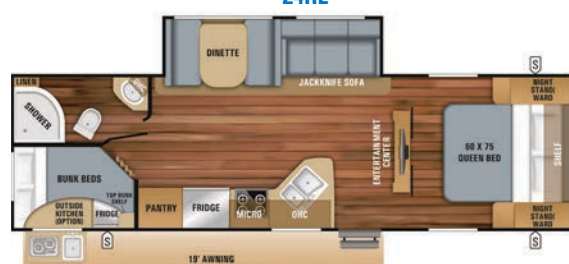

27BH OPTIONS: A, B



27RL OPTION: B

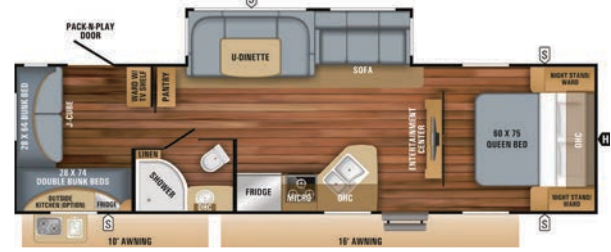

29QB OPTIONS: A, B

JAY FEATHER SPECS

FLOORPLAN	EXTERIOR TRAVEL LENGTH	EXTERIOR WIDTH	EXTERIOR HEIGHT (WITH A/C)	INTERIOR HEIGHT	UNLOADED VEHICLE WEIGHT	DRY HITCH WEIGHT	GROSS VEHICLE WEIGHT RATING	CARGO CARRYING CAPACITY	FRESH WATER CAPACITY (INCLUDES WATER HEATER)	GREY WASTE WATER CAPACITY	BLACK WASTE WATER CAPACITY	SLEEP CAPACITY
X213	24' 1"	8' 0"	10' 3"	6' 6"	4,460	438	5,500	1,040	48.0	30.5	22.5	6 - 9
20BH	23' 9"	8' 0"	10' 3"	6' 6"	4,290	505	5,500	1,210	48.0	30.5	30.5	5 - 8
21RD	24' 11"	8' 0"	10' 4"	6' 6"	4,295	535	5,500	1,205	48.0	30.5	30.5	3 - 4
23BHM	28' 9"	8' 0"	10' 3"	6' 6"	4,850	530	6,000	1,150	48.0	30.5	30.5	7 - 8
23RB	28' 3"	8' 0"	10' 3"	6' 6"	4,805	500	6,000	1,195	48.0	30.5	30.5	4 - 5
23RBM	27' 0"	8' 0"	10' 8"	6' 6"	5,040	525	6,250	1,210	48.0	30.5	30.5	3 - 4
24BHM	29' 2"	8' 0"	10' 8"	6' 6"	5,465	585	6,750	1,285	48.0	30.5	30.5	5 - 8
24RL	28' 5"	8' 0"	10' 10"	6' 6"	5,285	584	6,500	1,215	48.0	30.5	30.5	4 - 5
25RB	30' 5"	8' 0"	10' 9"	6' 6"	5,595	560	7,000	1,485	48.0	30.5	30.5	4 - 6
27BH	32' 4"	8' 0"	10' 11"	6' 6"	6,015	630	7,500	1,485	48.0	61*	30.5	8 - 10
27RL	31' 6"	8' 0"	10' 11"	6' 6"	5,755	650	7,000	1,245	48.0	30.5	30.5	4 - 6
29QB	34' 11"	8' 0"	10' 11"	6' 6"	6,425	725	7,500	1,075	48.0	61*	30.5	7 - 12

STANDARDS AND OPTIONS

STANDARD EXTERIOR EQUIPMENT

Aerodynamic, rounded front profile with front diamond plate
Modern retro graphics package with two-colored sidewall
Stronghold VBL™ vacuum-bonded, laminated floor, side, rear and front walls including slideout room walls
Vacuum-bonded, laminated bed platforms with reverse-cambered support (1,100 lb. capacity) (all hybrids)
Keyed Alike™ lock system on tent latches (all hybrids)
Magnum Truss™ Roof System with one-piece seamless DiFlex II material
Norco® NextGen frame with integrated A-frame
Single axle (X17Z only)
Dual axles (N/A X17Z)
G20 tinted safety glass windows
Marine-grade exterior speakers (2)
American-made Dexter EZ Lube® axles
Galvanized steel, impact-resistant wheel wells
Slideouts with double seals, barrier sponges and U-channel drip spout (select models)
30 amp service
Outside grill propane quick-connect port
Water-repellent, scratch-resistant Jayco DuraTek™ vinyl tent material with zipper windows (all hybrids)
Permanently attached tent-to-bed base design (all hybrids)
Rear camera backup prep (select models)
Folding assist handle on main entry doors

STANDARD INTERIOR EQUIPMENT

Screwed and glued cabinetry
Smoked glass decorative inserts (select overhead cabinets)
Ball-bearing drawer glides with 75 lb. capacity
Crown molding on ceiling
LED lighting throughout
6 cu. ft. refrigerator (5 cu. ft. X17Z)
Residential oven with 3 burner cooktop and upgraded grate exterior
Residential-style seamless kitchen countertops
Vinyl plank-style flooring
Microwave
Plywood dinette, bunk and bed bases
Murphy bed design allowing pass-through exterior storage access
4 inch high density dinette cushions with vinyl backing
Woodgrain accent paneling on select interior walls
Jayco exclusive Simmons® mattress with bedspread (select models)
Jayco exclusive teddy bear “soft-touch” residential-style mattress (select models)
110V outlet and corner shelf in fixed bunks
USB/110V recessed tower in kitchen or living area
Plastic foot flush toilet in all models
Bath skylight and roof vent
Solid shower enclosure (select models)
Tub/shower surround (select models)

CUSTOMER VALUE PACKAGE (MANDATORY)

American-made nitro-filled Goodyear® radial tires with self-adjusting brakes
Aluminum rims
20 lb. propane bottles with auto regulator (2)
13,500 BTU A/C
Spare tire with cover
Detachable power cord
Power awning with LED lights
Black tank flush
Outside shower
Exterior TV bracket with 110V electric and cable outlets
Power tongue with manual stabilizer jacks (4)
6 gallon gas/electric DSI water heater
Solar prep (roof mounted)
AM/FM/CD/DVD/Bluetooth® stereo
Enclosed underbelly with glacier package

OPTIONS

Drying rack/sink cover
24 inch LED TV (select models)
32 inch LED TV (select models)
15,000 BTU roof-mounted A/C
Exterior grill
Fan-Tastic Fan power roof vent (placement specific per model)
Outside cook kitchen (select models)
Roof ladder (select models)
2-bike carrier rack (A-frame mounted)
Baja Edition 15 inch off-road Goodyear mud tires, aluminum rims, flipped axle, enclosed underbelly with foil insulation (select models)
Tri-fold sofa in lieu of jackknife sofa (select models)
50 amp service (23RL, 25BH, 27RL, and 29RB)
2nd A/C
Power stabilizing jacks (select models)
30 lb. propane bottles with auto regulator (2) (select models)
Theater seating in lieu of jackknife sofa (select models)

INTERIOR DÉCOR

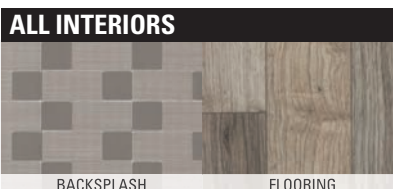
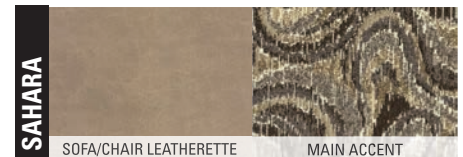
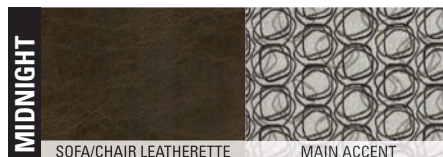
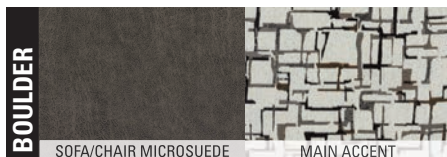

EXPANDABLE TENTS DELIVER SPACE TO SPARE



ENJOY AN EASY FOUR-STEP SETUP:

1. Unlatch the bed platform (left).
2. Guide the bed platform down.
3. Insert the bed bow brace (right).
4. Make the bed and enjoy!

5-YEAR TENT WARRANTY

We also offer five-year coverage on our tents, with parts, labor and freight covered the first two years; factory labor and return freight during years three, four and five.

JAY FEATHER COMPETITIVE ADVANTAGES



American-made Dexter Axles with Self-Adjusting Brakes and Galvanized Wheel Wells

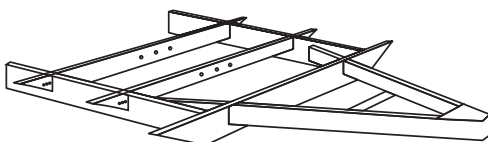

American-made Norco Frame with Integrated A-Frame



Enclosed Underbelly with Glacier Package



A-Frame and Roof Mounted Solar Prep



Rear Camera Back Up Prep



Rounded Front Profile with Increased Pass Through Storage

Is your tow vehicle JAY FEATHER ready?



Scan to learn more

2
YEAR
WARRANTY

TRAVEL WITH CONFIDENCE

At Jayco, we build our RVs to handle every adventure, then back them with our industry-leading 2-year limited warranty. We, with support from our select partners, have you covered for **2 camping seasons**. That's **730 days**. You won't find a better warranty in the business, because the only strings we attach are those that deliver the ultimate in reliability. That's the Jayco difference. So go explore. For a copy of our 2-year limited warranty with complete terms and conditions, please contact your local Jayco dealer.



JAYCO'S ROOF vs. OTHER ROOFS

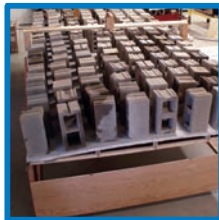

4,500 POUNDS ON A JAYCO ROOF VS. OTHER ROOFS

THE MAGNUM TRUSS™ ROOF SYSTEM 50 percent stronger

GOODYEAR

Featuring Durawall® Technology—ENGINEERED
to help you tow with confidence



MADE IN USA



Jayco, Inc. | P.O. Box 460 | Middlebury, IN 46540 RVIA

See dealer for further information and prices. All information in this brochure and on www.jayco.com is the latest available at the time of publication approval. Jayco reserves the right to make changes and to discontinue models without notice or obligation. Photography may show optional equipment or props used for decoration purposes only. RVs built for sale in Canada may differ to conform to Canadian codes. JAYCO and the JAYCO BIRD IN FLIGHT are registered trademarks of Jayco, Inc. Printed in USA 20K 11/2018 ©2018 Jayco, Inc. 274875-1

Follow Jayco

#Jayco50



Meet your Jayco Dealer _____

We work hard—so you can play hard. From finding the perfect Jayco for your family to providing flexible financing options and full-service support, we're here to help.