

SOLAIRE

BY PALOMINO

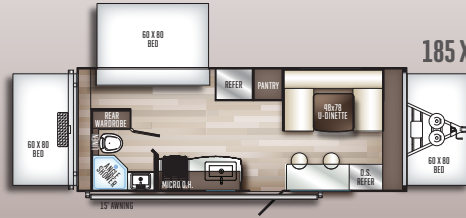

HYBRIDS

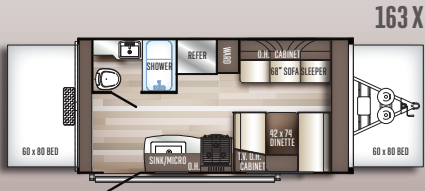
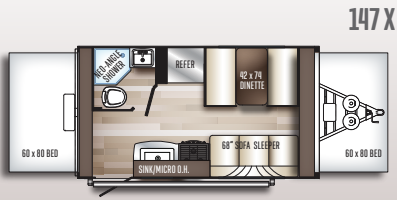
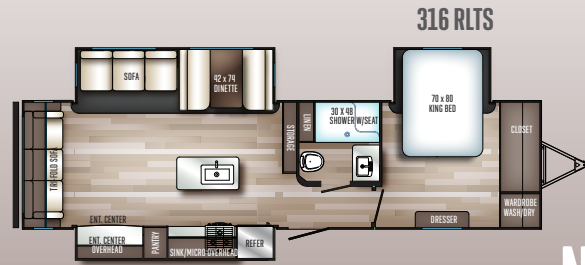
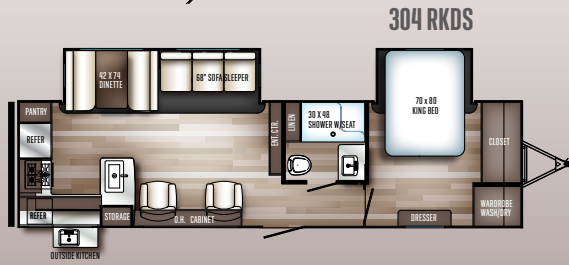
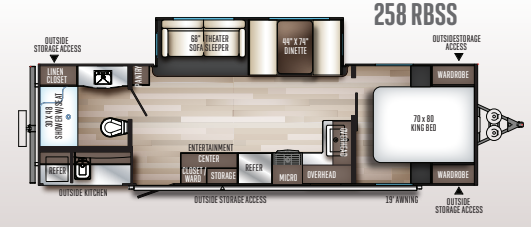
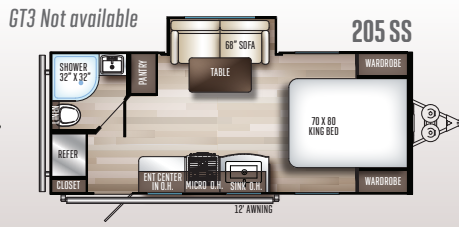
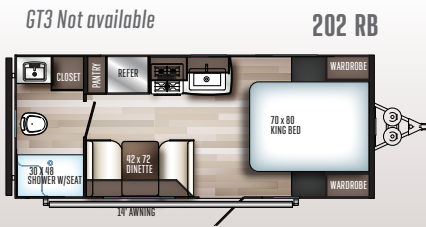

NON-BUNKS

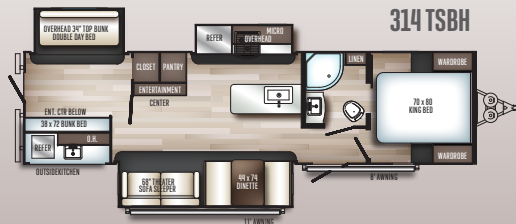
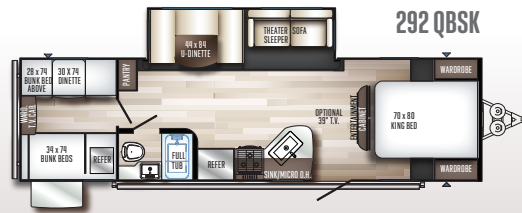
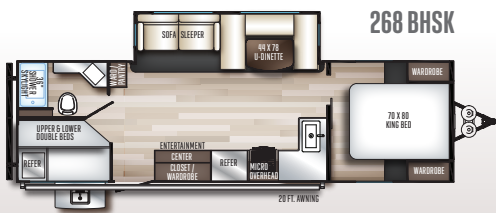
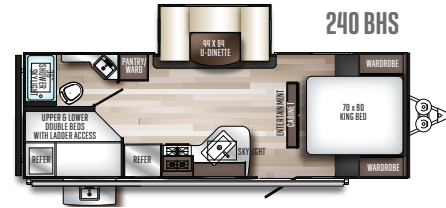
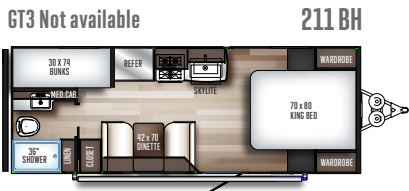

BUNKS

SOLAIRE

BY PALOMINO



SPECIFICATIONS

HYBRIDS

NON-BUNKS

	147 X	163 X	185 X	202 RB	205 SS	258 RBSS	304 RKDS	316 RLTS
Hitch Dry Weight	315	400	444	536	546	765	920	929
Dry Axle Weight	2720	3195	3652	3239	3800	5595	6333	7239
Total Dry Weight	3035	3595	4096	3775	4347	6360	7253	8168
GVWR	3815	4996	5630	5125	5400	7765	8920	9995
Unloaded Vehicle Weight	3073	3633	4134	3813	4385	6398	7291	8206
Interior Height	6'8"	6'8"	6'8"	6'8"	6'8"	6'8"	6'8"	6'8"
Exterior Height w/ AC	10'1"	10'1"	10'1"	10'1"	10'1"	11'1"	11'1"	11'1"
Exterior Width	8'	8'	8'"	8'	8'	8'	8'	8'
Travel Length	18'6"	20'2"	25'11"	23'5"	23'4"	32'8"	35'6"	35'6"
Open Length	23'3"	24'10"	29'7"	NA	NA	N/A	NA	NA
Fresh Water Capacity (Gal.)	50	50	50	50	50	50	50	50
Gray Water Capacity (Gal.)	30	30	38	38	38	68	106	106
Black Water Capacity (Gal.)	30	30	30	38	30	30	38	38
Cargo Carrying Capacity (L)	746	1363	1496	1312	1245	1367	1629	1789

SUPERIOR FEATURES.

TOP TEN REASONS TO BUY

1. Vacuum Bonded Walls
2. White Gel-Coat Fiberglass Exterior
3. Dexter (R) Torsion Axle
4. Fully Walkable-Bonded Ceilings
5. Fully welded Aluminum super structure
6. Solid surface counter tops
7. 8 cu ft. refrigerator- standard
8. Fiberglass front cap w/LED's [N/A X's]
9. Raised panel cabinet doors
10. LED interior lights and USB charging station

BUNKS

	211 BH	240 BHS	268 BHSK	292 QBSK	314 TSBH	317 BHSK
Hitch Dry Weight	528	566	671	845	1011	705
Dry Axle Weight	3568	4606	5307	4970	6733	6445
Total Dry Weight	4096	5172	5978	5855	7744	7070
GVWR	5630	6710	7759	7845	9600	8700
Unloaded Vehicle Weight	4134	5210	6016	5893	7782	7108
Interior Height	6'8"	6'8"	6'8"	6'8"	6'8"	6'8"
Exterior Height w/AC	10'1"	11'1"	11'1"	11'1"	11'1"	11'1"
Exterior Width	8'	8'	8'	8'	8'	8'
Travel Length	25'5"	27'10"	32'8"	33'4"	35'6"	35'1"
Open Length	NA	NA	NA	NA	N/A	NA
Fresh Water Capacity	50	50	50	50	50	50
Gray Water Capacity	30	38	76	76	68	76
Black Water Capacity	38	38	38	38	30	38
Cargo Carrying Capacity	1496	1500	1655	1952	1818	1592

Specification Definitions

GVWR (Gross Vehicle Weight Rating) - is the maximum permissible weight of the unit when fully loaded. It includes all weights, inclusive of all fluids, cargo, optional equipment and accessories. For safety and product performance do NOT exceed the GVWR.

GAWR (Gross Axle Weight Rating) - is the maximum permissible weight, including cargo, fluids, optional equipment and accessories that can be safely supported by a combination of all axles.

UVW (Unloaded Vehicle Weight) - is the typical weight of the unit as manufactured at the factory. It includes all weight at the unit's axle(s) and tongue or pin and LP Gas. The UVW does not include cargo, fresh potable water, additional optional equipment or dealer installed accessories.

*Estimated average based on standard build optional equipment.

CCC (Cargo Carrying Capacity)** - is the amount of weight available for fresh potable water, cargo, additional optional equipment and accessories. CCC is equal to GVWR minus UVW. Available CCC should accommodate fresh potable water (8.3 lbs per gallon). Before filling the fresh water tank, empty the black and gray tanks to provide for more cargo capacity.

** Estimated average based on standard build optional equipment

Each Forest River RV is weighed at the manufacturing facility prior to shipping. A label identifying the unloaded vehicle weight of the actual unit and the cargo carrying capacity is applied to every Forest River RV prior to leaving our facilities.

The load capacity of your unit is designated by weight, not by volume, so you cannot necessarily use all available space when loading your unit.



Learn More
Scan this barcode using a QR Reader on your smart phone to learn more about Forest River.



A Berkshire Hathaway company.



PALOMINO RV

1047 EAST M-86 | COLON, MI 49040
P: 269.432.3271 | F: 269.432.2516
www.palominorv.com